

Molteni & C

GLISS WALK-IN— MDT 2013

1—
11



Gliss Walk-In is a system of walk-in closets allowing to design made to measure compositions, with both linear and corner solutions. Compositions can be wall-mounted with or without back panels (cartapaglia white, anthracite and Millerighe melamine, lacquered, glass or mirror finish). The equipment can be freely positioned in height, thanks to a system of concealed, self-locking brackets. A simple design and the wide customisation of the equipment allow solutions for any need.

DATASHEET

REGISTERED
DESIGN

I.2015

molteni.it

Dimensions in millimeters and inches. The right to discontinue and make changes is reserved. This information is based on the latest product information available at the time of printing.

FINISHES

finishes	natural anodised	black anodised	cartapaglia melamine colours	millerighe Dark	matt lacquer colours	woods	coloured glass/ etched coloured glass	mirror/ Kyoto glass	shiny chrome
components									
wall profile									
lateral finishing profile									
back panels									
base									
plinth on base									
shelves									
clothes rails									
structure of trays/drawer units									
fronts of wood drawer units									
drawer units finishing tops									

Molteni & C

colours

Matt lacquer

BC chalk white
AV ivory
PE pearl
DN dune
PL platinum
PB lead
NE black
RT venetian red
BO bordeaux
AT anthracite
SE mustard
SI silica
DO dolomite grey
AL clay
AR orange
MK moka
AQ aquamarine
CM caramel
CZ light blue grey
SA sand

Woods

EU eucalyptus
RG grey oak
RN black oak
OC light elm
OS dark elm

Coloured glass

BC chalk white
PE pearl
DN dune
PL platinum
PB lead
NE black
RT venetian red
BO bordeaux
AT anthracite
SE mustard
SI silica
DO dolomite grey
AL clay
AR orange
MK moka
AQ aquamarine
CM caramel
CZ light blue grey
SA sand

Etched coloured glass

BC chalk white
PE pearl
DN dune
PL platinum
PB lead
NE black
RT venetian red
BO bordeaux
AT anthracite
SE mustard
SI silica
DO dolomite grey
AL clay
AR orange
MK moka
AQ aquamarine
CM caramel
CZ light blue grey
SA sand

Cartapaglia melamine

KB white
KA anthracite

DATASHEET

REGISTERED
DESIGN

I.2015

TECHNICAL INFORMATION

WALL PROFILE

Extruded anodised aluminium.

MELAMINE FACED SHELF/BASE

Wooden particleboard panel faced with melamine. Metal brackets to fasten the shelf to the wall profile. Adjustable feet for the base.

LACQUERED SHELF/BASE

Wooden particleboard panel faced with melamine, painted in the colours of the “Molteni Range”. Metal brackets to fasten the shelf to the wall profile. Adjustable feet for the base.

WOOD SHELF/BASE

Wooden particleboard panel faced with wood veneer in Oak (Quercus), Elm (Ulmus rubra) or Eucalyptus (Eucalyptus globulus). Metal brackets to fasten the shelf to the wall profile. Adjustable feet for the base.

BACK PANEL, DRAWER UNIT STRUCTURE, DRAWER AND TRAY FRONTS, DRAWER SIDES AND BOTTOM (MELAMINE FACED)

Wooden particleboard panel faced with melamine.

BACK PANEL, DRAWER UNIT STRUCTURE, DRAWER AND TRAY FRONTS (LACQUER)

Wooden particleboard panel faced with melamine, painted in the colours of the “Molteni Range”.

BACK PANEL (GLASS VERSIONS)

Wooden particleboard panel faced with melamine, with applied mirror or tempered glass (th. 5 mm), transparent or etched, painted in the colours of the “Molteni Range”.

GLASS DRAWER FRONT

Wooden particleboard panel faced with melamine or painted in the colours of the “Molteni Range”. Tempered glass th. 4 mm.

CLOTHES RAILS

Tube in chrome plated steel. Tube support in chromed plastic.

LATERAL FINISHING PROFILE

Medium density fibre panels faced with melamine paper, painted in the colours of the “Molteni Range”.

SHOE RACK ROD OR TROUSER ROD

In anodised extruded aluminium with plastic insert.

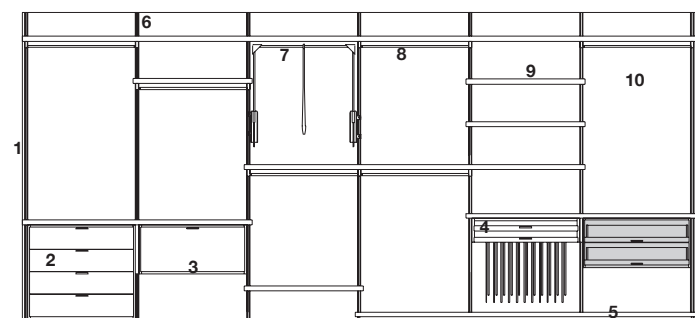

- 1 LATERAL FINISHING PROFILE
- 2 FRONT OF WOOD DRAWER
- 3 STRUCTURE OF DRAWER UNIT
- 4 TRAYS
- 5 BASE
- 6 WALL PROFILE
- 7 SERVETTO PULL-OUT CLOTH RAIL
- 8 CLOTH RAIL
- 9 SHELF
- 10 BACK PANEL

DRAWER INTERIOR

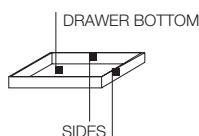

MODULARITY

Methods of executing custom cuttings

In height:

- all vertical profiles (wall-mounted, spacers, finishing profiles) can be reduced to the desired size
- the height of the back panels is custom cut

In width:

- custom reduction up to -614 mm (24 1/8") is available **only on 1 module**
- the minimum possible width for a module is 328 mm
- **the size of trays and modular drawer units cannot be reduced**
- hanging structures can be fastened only to standard compartments with W 942 (37 1/8")

- if a wider shelf is placed on top of any drawer unit (either freestanding, suspended or resting on the base), the drawer unit must be of standard width 942 (37 1/8").
- two drawer units are available for compartments cut to measure (suspended, standing on base or floor standing).

Molteni & C

4—
11

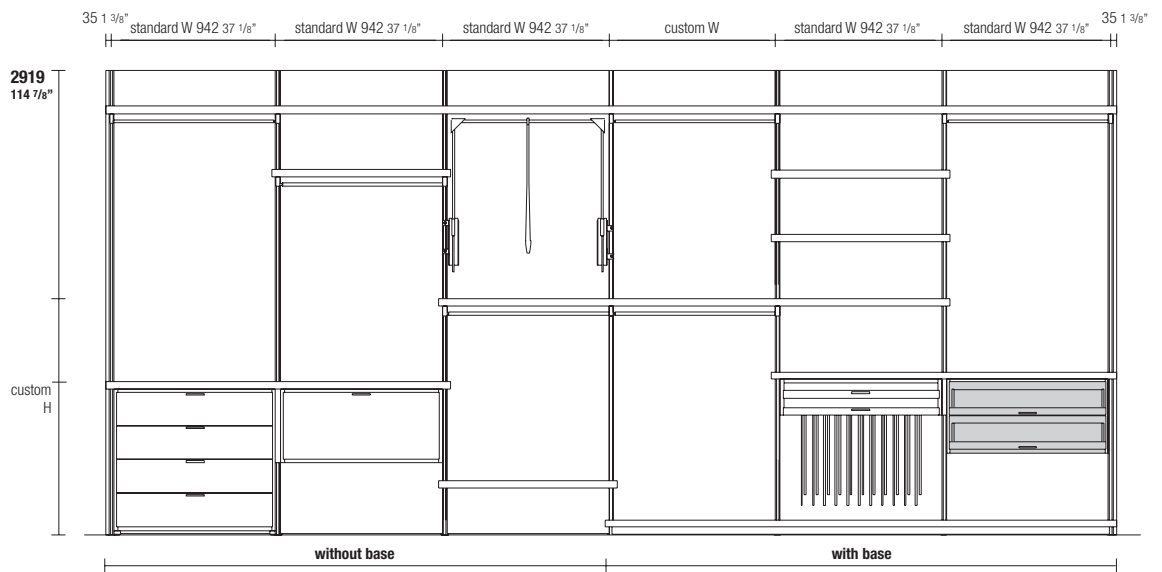

module with or without back panel

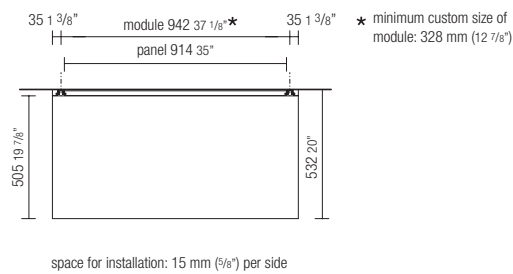

corner element with or without back panel

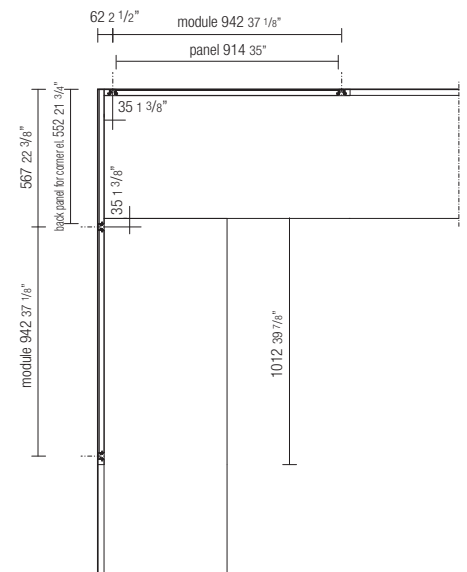

DATASHEET

REGISTERED
DESIGN

I.2015

molteni.it

Dimensions in millimeters and inches. The right to discontinue and make changes is reserved. This information is based on the latest product information available at the time of printing.

MODULARITY

Linear composition with or without back panels

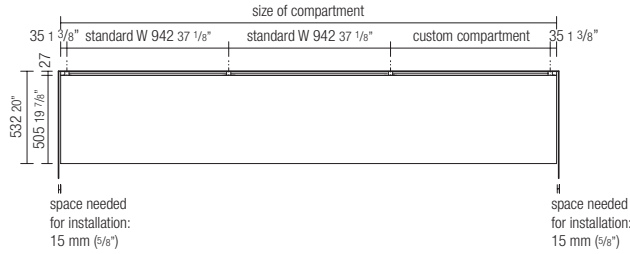

Molteni & C

5—
11

Corner composition with or without back panels

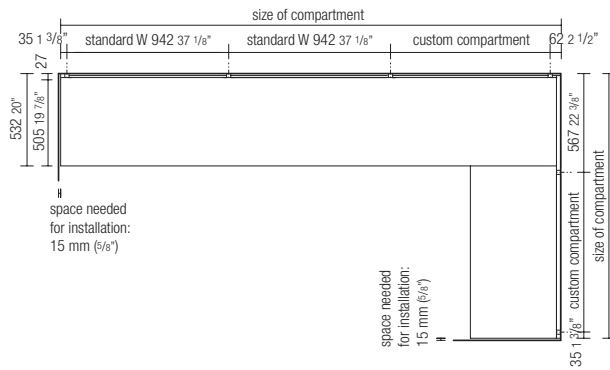

C-shaped corner composition with or without back panels

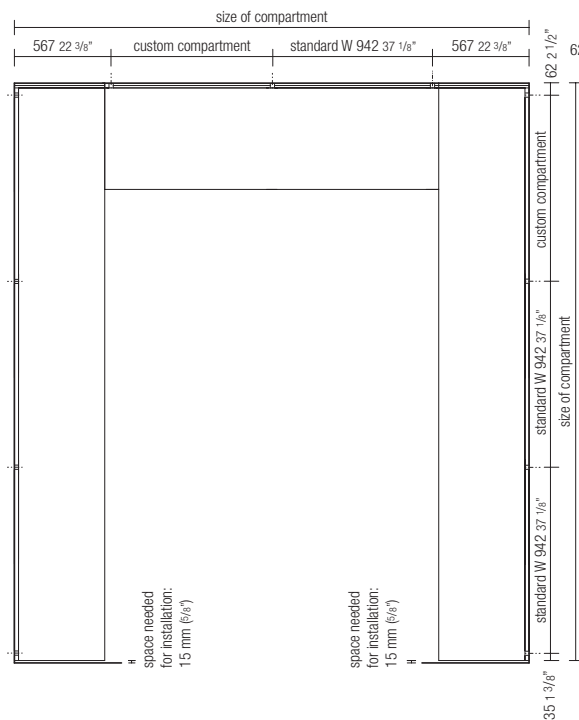

C-shaped corner composition without back panels on corners

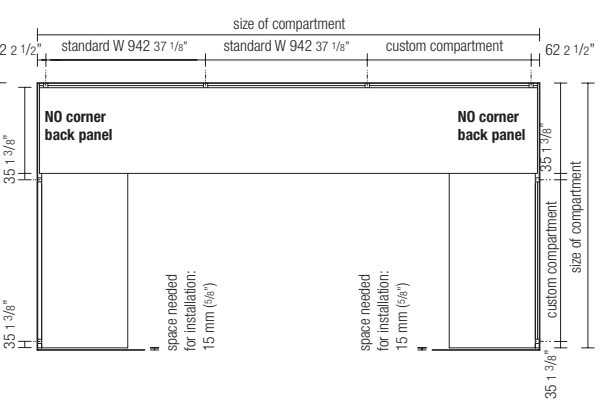

DATASHEET

REGISTERED
DESIGN

I.2015

molteni.it

Dimensions in millimeters and inches. The right to discontinue and make changes is reserved. This information is based on the latest product information available at the time of printing.

NOTES

- hanging structures with H 110 can contain any tray
- hanging structures with H 206 can contain trays and also a pull-out tray or a H 190 drawer
- drawers, pull-out trays and trinket trays can be freely installed on all other structures, according to the height of the module
- the interiors of the drawers have always a cartapaglia anthracite melamine finish
- in case there is no shelf placed over the drawer unit, a 10 mm thick finishing top is always needed
- no shelves can be positioned in the modules adjacent to a drawer unit.

Handle in shiny chrome finish

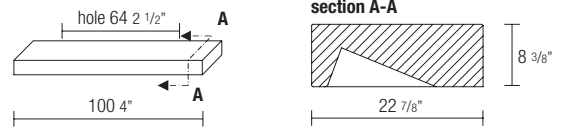

Molteni & C

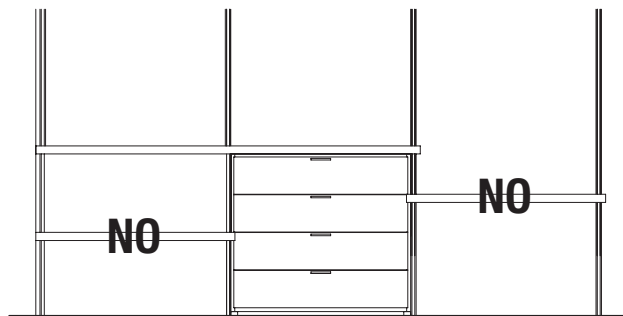

Reductions

- **the size of trays and drawer units cannot be reduced**
- hanging structures can be fastened only to standard compartments with W 942
- if a shelf is placed on top of a drawer unit (either free-standing or resting on the base) the drawer unit must occupy a standard W 942 module.

Drawer units for width custom compartments

To enhance the functional features and adaptability of Gliss Walk-In to all situations, two drawer units H 417/439 with reduced width are available (W 614 for modules cut to measure up to W 642, and W 450 for modules cut to measure up to W 478). These drawer units can be used suspended above the shelf, either supported by the base or floor standing.

Notes

Besides the instructions concerning the drawer units 942 W, we add following:

- Drawer units always have two wooden drawers H 190
- The suspended drawer unit can be positioned either on the left or right part of the reduced module.

example of drawer unit suspended on the left

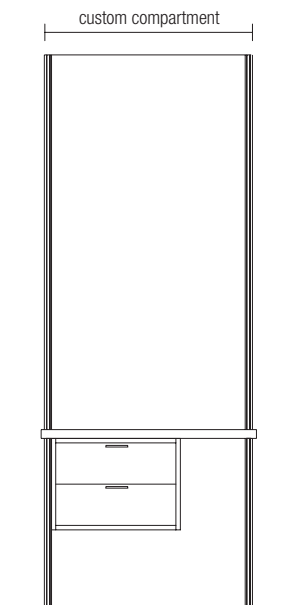

DATASHEET

REGISTERED
DESIGN

I.2015

FITTINGS

Base
D 505 th 83 3 1/4"
with adjustable feet

W 1012 39 7/8"
(1 module)

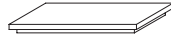

BA5/10

W 1954 76 7/8"
(2 modules)

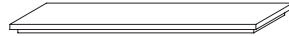

BA5/20

W 2896 114"
(3 modules)



BA5/29

Shelf
D 505 th 40 1 5/8"
with mounting brackets

W 1012 39 7/8"
(1 module)
2 brackets

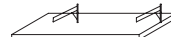

RI5/10

W 1954 76 7/8"
(2 modules)
3 brackets

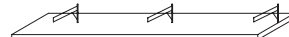

RI5/20

W 2896 114"
(3 modules)
4 brackets

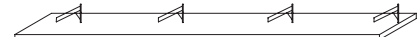

RI5/29

Jointed shelf
D 505 th 40 1 5/8"
with mounting brackets

W from 2897 to 3838
W from 114" to 151 1/8"
(4 modules)
5 brackets



RG5/38

W from 3839 to 4780
W from 151 1/8" to 188 1/4"
(5 modules)
6 brackets

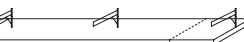

RG5/48

W from 4781 to 5722
W from 188 1/4" to 225 1/4"
(6 modules)
7 brackets



RG5/57

cloth rails
module W 942 37 1/8"



P094

servetto pull-out cloth rail
can be used on W 942 (37 1/8") to
W 670 mm (26 3/8") modules

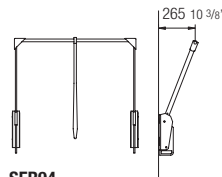

SER94

pull-out coat hanger



AGR1

FITTINGS

trays
W 884 D 468
W 34 3/4" D 18 3/8"

trouser holder tray
H 46 1 3/4"
n. **11** bars max

trinket tray (ties and belts)
H 46 1 3/4"

tray with container (ecru fabric)
H 286 11 1/4"

tray with container (ecru fabric)
H 382 15"

additional trouser holder bar
(anthracite embossed finish)

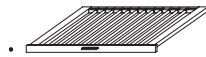

VPN9/05

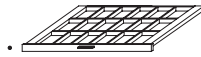

VPO9/05

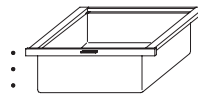

VCS9/28

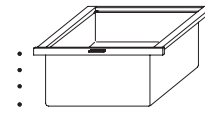

VCS9/38



VPNBA

Molteni & C

8—
11

drawers
W 884 D 468 H 190
W 34 3/4" D 18 3/8" H 7 1/2"
usable spaces
W 834 D 435 H 106

wooden drawer

open drawer

glass drawer
in transparent glass serigraphed in Molteni colour range or in the colour of the melamine finish



CLE9/19

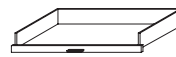

CAP9/19

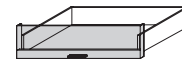

CVE9/19

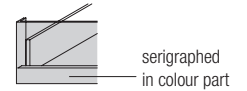

serigraphed in colour part

drawers
W 884 D 468 H 286
W 34 3/4" D 18 3/8" H 11 1/4"
usable spaces
W 834 D 435 H 202

wooden drawer

open drawer

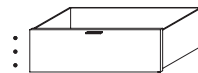

CLE9/28

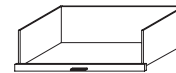

CAP9/28

drawers
W 884 D 468 H 382
W 34 3/4" D 18 3/8" H 15"
usable spaces
W 834 D 435 H 298

wooden drawer

open drawer

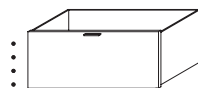

CLE9/38

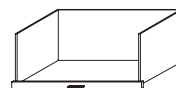

CAP9/38

shoe racks
W 884 D 468 H 286
W 34 3/4" D 18 3/8" H 11 1/4"
n. 2 shoe racks

shoe rack with wooden front panel

open shoe rack

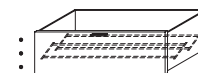

CSL9/28

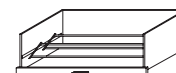

CSA9/28

shoe racks
W 884 D 468 H 382
W 34 3/4" D 18 3/8" H 15"
n. 3 shoe racks

shoe rack with wooden front panel

open shoe rack

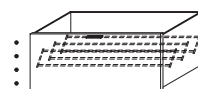

CSL9/38



CSA9/38

DATASHEET

REGISTERED DESIGN

I.2015

molteni.it

Dimensions in millimeters and inches. The right to discontinue and make changes is reserved. This information is based on the latest product information available at the time of printing.

FITTINGS

Recessed LED spotlight for shelves

Features

The spotlight is powered by No. 3 AA batteries (inclusive) and does not need a connection to the electrical system. Lighting is automatic thanks to a volumetric sensor-controlled system. The spotlight has an ON/OFF switch allowing to turn it off when not in use for long periods.

Notes

Tests performed with high quality, non-rechargeable batteries (as the ones supplied with) report a duration of about 1 year when the spotlight is operated for 30 seconds 4 times a day. The use of rechargeable batteries reduces the light intensity of the spotlight.

recessed LED spotlight (batteries included)

W 184 D 40
W 7 1/4" D 1 5/8"

centrally positioned in the module, even in small module, up to 328 mm

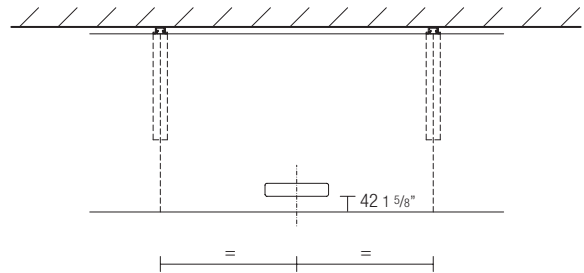

HF1

Led lighting

Shelves can be accessorised with LED lighting. Lighting systems are conformant with European safety standards.

Notes

At the moment of the order, the customer must always indicate on the drawing the shelf or the shelves where the lighting bars should be installed. The bars will always follow the width of the shelf. If the shelf is jointed, two bars will be made, one for each part of the shelf.

lighting bars for shelves

consider two singles bars for jointed shelves

for shelves up to W 1012 - 39 7/8"



watt 12
EBI10

for shelves up to W 1954 - 76 7/8"



watt 22
EBI20

for shelves up to W 2896 - 114"



watt 33
EBI29

each power supply kit can turn on max 6 bars that do not go over 100 W.

If this wattage is surpassed, two or more kits must be purchased.

power supply kit for system turned on through remote control

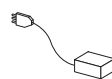

EBKT

SAMPLE COMPOSITIONS

composition 1

backs: cartapaglia melamine/millerighe dark
shelves: cartapaglia melamine/millerighe dark
fittings: cartapaglia melamine/millerighe dark

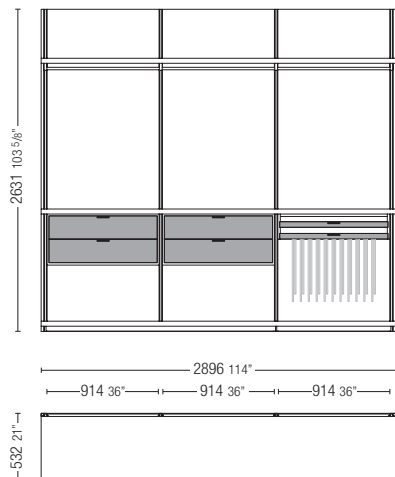

GCC01

composition 2

backs: cartapaglia melamine/millerighe dark
shelves: cartapaglia melamine/millerighe dark
fittings: cartapaglia melamine/millerighe dark

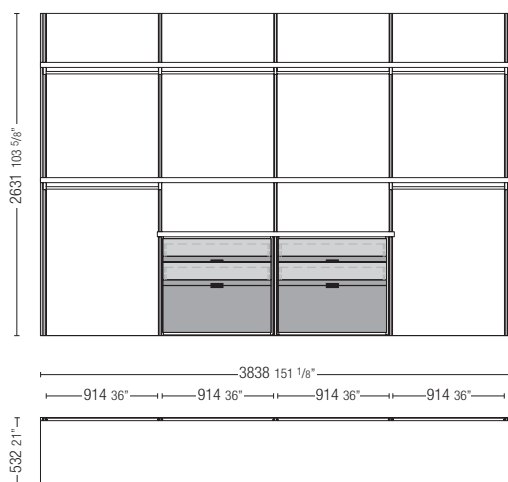

GCC02

DATASHEET

REGISTERED
DESIGN

I.2015

SAMPLE COMPOSITIONS

composition 3

backs: cartapaglia melamine/millorighe dark
shelves: cartapaglia melamine/millorighe dark
fittings: cartapaglia melamine/millorighe dark

Molteni & C

11—
11

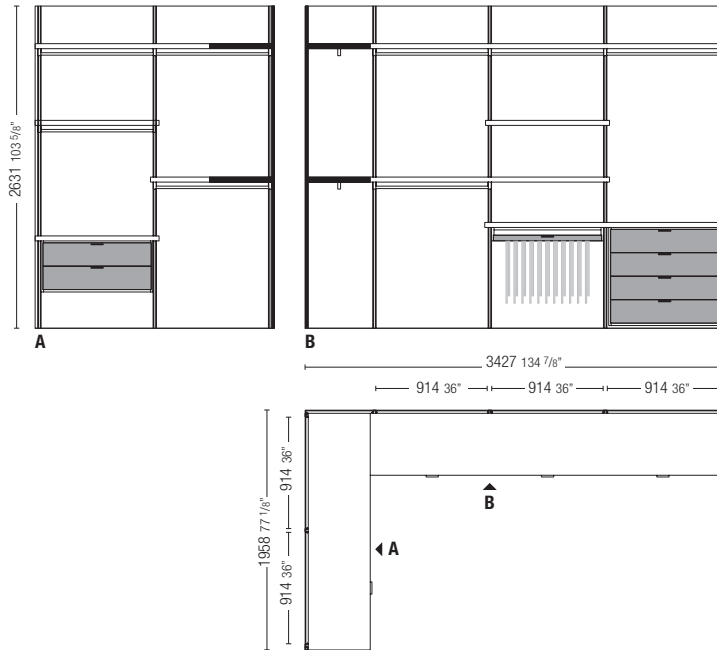

GCC03

composition 4

backs: cartapaglia melamine/millorighe dark
shelves: cartapaglia melamine/millorighe dark
fittings: cartapaglia melamine/millorighe dark

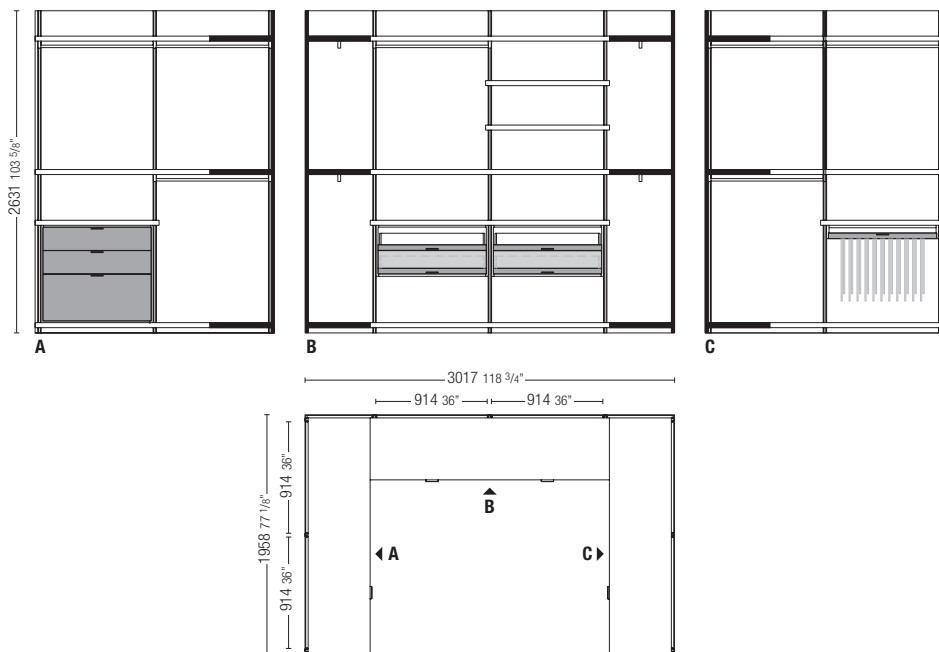

GCC04

DATASHEET

REGISTERED
DESIGN

I.2015

molteni.it

Dimensions in millimeters and inches. The right to discontinue and make changes is reserved. This information is based on the latest product information available at the time of printing.

FINISHES

	MATT LACQUER/ OPEN GRAIN LACQUER	GLOSSY LACQUER	COLOURED GLASS	ETCHED COLOURED GLASS
CHALK WHITE	•	•	•	•
IVORY	•			
PEARL	•	•	•	•
SILICA	•	•	•	•
SAND	•	•	•	•
PLATINUM	•	•	•	•
DUNE	•	•	•	•
CLAY	•	•	•	•
DOLOMITE GREY	•	•	•	•
BORDEAUX	•	•	•	•
MOKA	•	•	•	•
ORANGE	•	•	•	•
MUSTARD	•	•	•	•
CARAMEL	•	•	•	•
LIGHT BLUE GREY	•	•	•	•
AQUAMARINE	•	•	•	•
VENETIAN RED	•	•	•	•
LEAD	•	•	•	•
ANTHRACITE	•	•	•	•
BLACK	•	•	•	•
LESSLESS RED	•			
	only matt lacquer			

FINISHES

WOODS

EUCALYPTUS



AMERICAN WALNUT

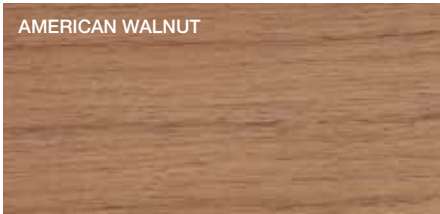

GREY OAK



BLACK OAK

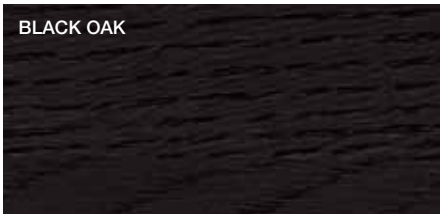

DARK ELM



LIGHT ELM

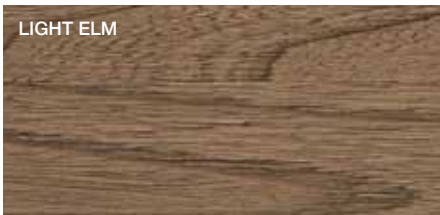

CEDAR



MARBLES

WHITE CARRARA MARBLE



CALACATTA MARBLE



RED FRENCH MARBLE

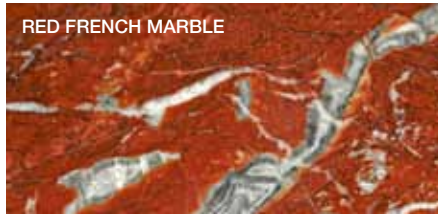

EMPERADOR DARK MARBLE



CARNIAN GREY MARBLE

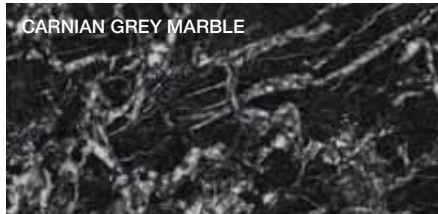

ABSOLUTE BLACK GRANITE



GRES

WHITE GRES



ANTHRACITE GRES



METAL PARTS

BLACK CHROME

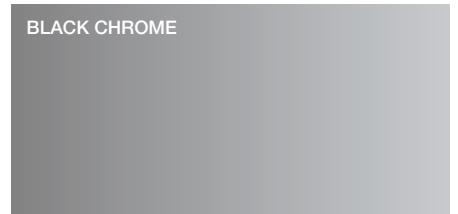

SHINY ALUMINIUM



PEWTER COLOUR



MILLERIGHE
GLISS QUICK FRONT



CHALK WHITE



PEARL

CARTAPAGLIA
GLISS QUICK, GLISS WALK-IN FRONT

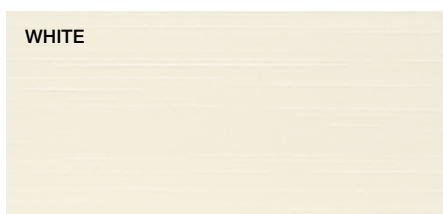

WHITE



ANTHRACITE

MILLERIGHE
GLISS QUICK, GLISS 5TH STRUCTURE



PEARL



NATURAL



DARK

Millerighe dark finish available also for Gliss Walk-In where specifically indicated in the pricelist

DWELL
DOOR FRAME, TRACK COVERING PROFILES



ANODISED ALUMINIUM



BROWN ALUMINIUM