

GLISS MASTER— VINCENT VAN DUYSSEN 2015

1—
23



Gliss Master satisfies the desire for a new series of wardrobes that are at once technologically and aesthetically avant garde. Gliss Master is a fortunate combination of purity of forms, use of materials and exclusive technologies that gives rise to a functional design, in which the visual and tactile aspects are key.

DATASHEET

REGISTERED
DESIGN

IX.2015

molteni.it

Dimensions in millimeters and inches. The right to discontinue and make changes is reserved. This information is based on the latest product information available at the time of printing.

FINISHES

		melamine structure	melamine cartapaglia front	melamine plaster silica	plaster lacquer colours	cartapaglia lacquered	plaster lacquered colours	glossy lacquer colours	woods	coloured glass/ etched coloured glass	mirror	pewter colour	Eco Skin	extraclear transparent glass/ stopsol glass
components														
structure with back														
exterior side														
extension profile														
START door														
"A FILO" door														
"A FILO" glass door	profile													
	glass													
GRIP door														
DEEP door														
PLASTER door	profile													
	panel													
STRIP door	strip													
	panel													
WINDOW door	profile													
	glass													
SKIN door	profile													
	panel													

		melamine structure	pewter colour	dolomite lacquer	extraclear transparent glass	grey saffiano melamine	larix dark	plaster lacquer colours
internal fittings								
shelves / central divider pieces / modular grid								
drawer fronts / wood trays								
glass drawer fronts	profile							
	glass							
drawer internal								
pull-out shirt holder								
grid with shirt and sweater holders								
island drawer unit								
drawer unit								

colours	Melamine structure	Matt lacquer/ Cartapaglia lacquered/ Plaster lacquered	Glossy lacquer	Coloured glass	Etched coloured glass	Woods	Eco Skin
	YB white shantung YG grey shantung YM larix dark	BC chalk white PE pearl DN dune PL platinum KA anthracite AT anthracite KB white KS silica	BC chalk white PE pearl DN dune PL platinum AT anthracite NE black BO bordeaux PB lead SE mustard SI silica DO dolomite grey AL clay MK moka CM caramel CZ light blue grey SA sand RU ruby CI cadmium	BC chalk white PE pearl DN dune PL platinum AT anthracite NE black BO bordeaux PB lead SE mustard SI silica DO dolomite grey AL clay MK moka CM caramel CZ light blue grey SA sand RU ruby CI cadmium	BC chalk white PE pearl DN dune PL platinum AT anthracite NE black BO bordeaux PB lead SE mustard SI silica DO dolomite grey AL clay MK moka CM caramel CZ light blue grey SA sand RU ruby CI cadmium	EU eucalyptus RG grey oak RN black oak OC light elm OS dark elm	grey mink hemp ivory dark brown

DATASHEET

REGISTERED
DESIGN

IX.2015

MODULARITY

Modularity - Structure

The widths 492 - 656 - 820 - 984 - 1312 - 464 (term. element) mm (19 3/8" - 25 7/8" - 32 1/4" - 38 3/4" - 51 5/8" - 18 1/4") include the left side panel. The total width of the composition will include the final panel of th. 30 mm (1 1/8"). Heights: tot. H 2343 (92 1/4"), door 2313 (91"), int.2253 (87 3/4"), sliding or flush sl. door inter. 2163 (85 1/8") / tot. H 2439 (96"), door 2409 (94 7/8"), int. 2349 (92 1/2"), sliding or flush sl. door inter. 2259 (88 7/8") / tot. H 2631 (103 5/8"), door 2601 (102 3/8"), int. 2541 (100"), sliding or flush sl. door inter. 2451 (96 1/2") / tot. H 2919 (114 7/8"), door 2889 (113 3/8"), interior 2829 (111 3/8"), only hinged

Assembly instructions

For the assembling of a sliding and a flush sliding door wardrobe a minimum space of 6 cm (2 3/8") is required considering the minimum height of the compartment.

Assembly of the corner element (for wardrobe with doors) requires a minimum extra height of 6 cm (2 3/8").

Assembly of a wardrobe in an alcove requires a minimum extra side space of 4 cm (1 5/8").

A wardrobe with hinged doors and a lighting system requires a minimum extra height of 5 cm (2").

Molteni&C

3—
23

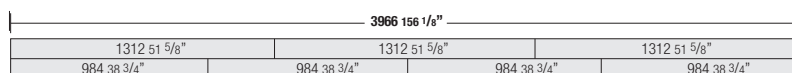
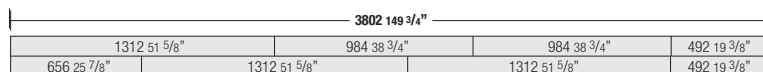
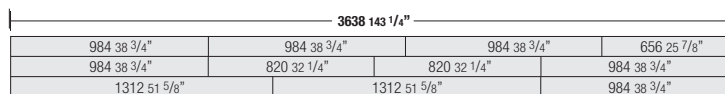
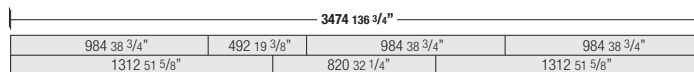
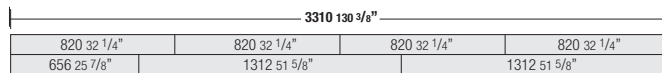
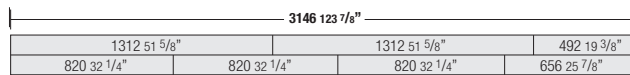
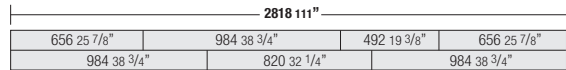
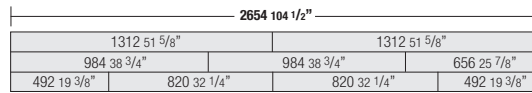
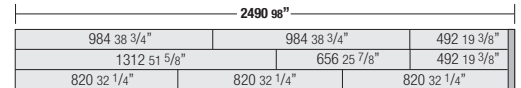
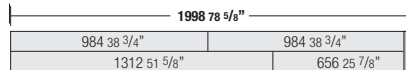
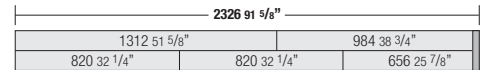
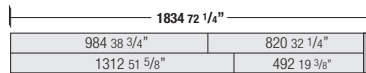
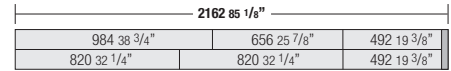
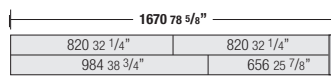
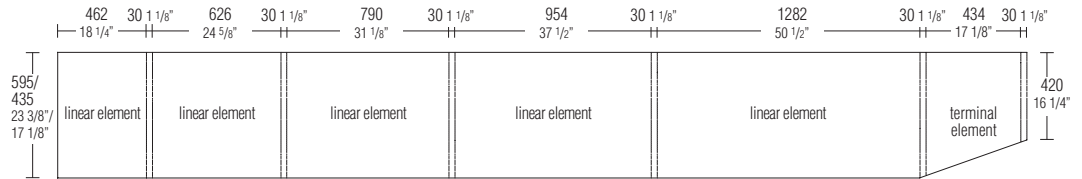

DATASHEET

REGISTERED
DESIGN

IX.2015

molteni.it

Dimensions in millimeters and inches. The right to discontinue and make changes is reserved. This information is based on the latest product information available at the time of printing.

DOORS

START and "A FILO" hinged doors

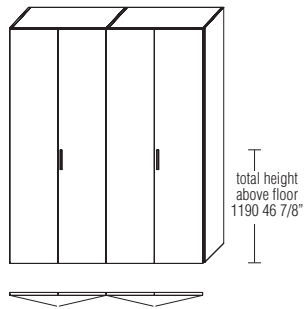

The pairs of hinged doors START and "A FILO" always have a handle mounted on the right door.

GRIP - DEEP - STRIP - PLASTER - WINDOW - SKIN hinged doors

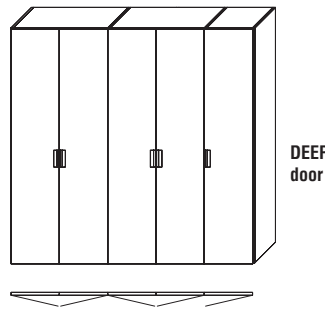

DEEP door

STRIP door

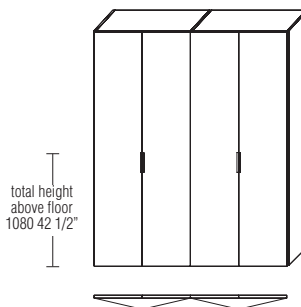

GRIP - PLASTER - WINDOW - SKIN door

The hinged doors WINDOW and SKIN are made with recessed hinges fixed to base and top, and have a thickness of 30 mm

Sliding doors

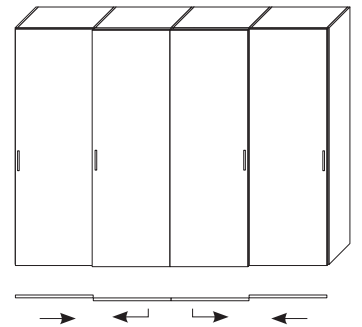
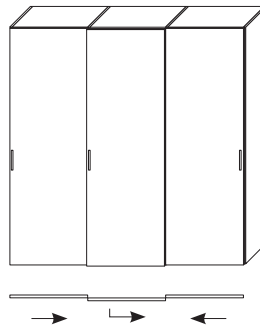
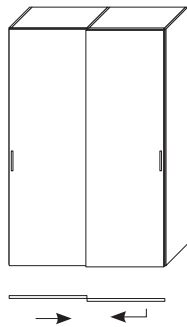

It is possible to make sliding door wardrobes with doors of the following types:

- START
- "A FILO"
- GRIP
- DEEP

It is possible to make the external sliding door with two handles if using the "A FILO" door (full-height handle) and applying the surcharge

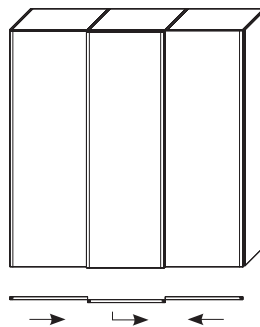

Detail of side panel with extension profile

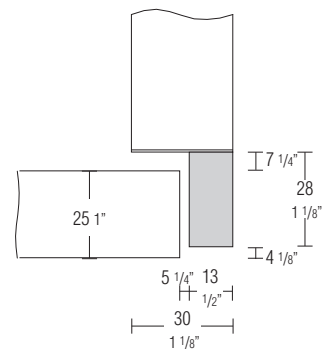

Flush sliding doors

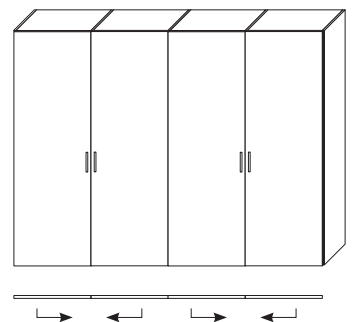
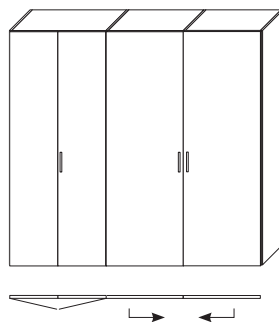
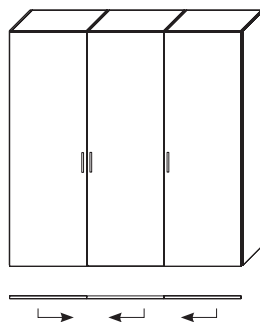
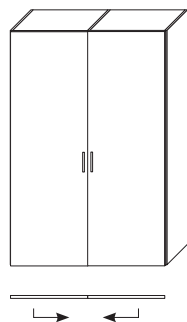

CORNER ELEMENT

Corner element for walk-in closet without door D 595

The corner element is supplied complete with base, top and back panels. Central partitions must be inserted between the corner unit and the adjacent elements. The corner element can also be completed with a side panel to close a composition. The structure is made in melamine.

Notes

Shelves are not included in the price of the corner element. On the shelves and on the tops can be mounted the led lighting bars, like shown in the drawing below.

Reductions

The corner element can only be reduced in height.

Molteni & C

5—
 23

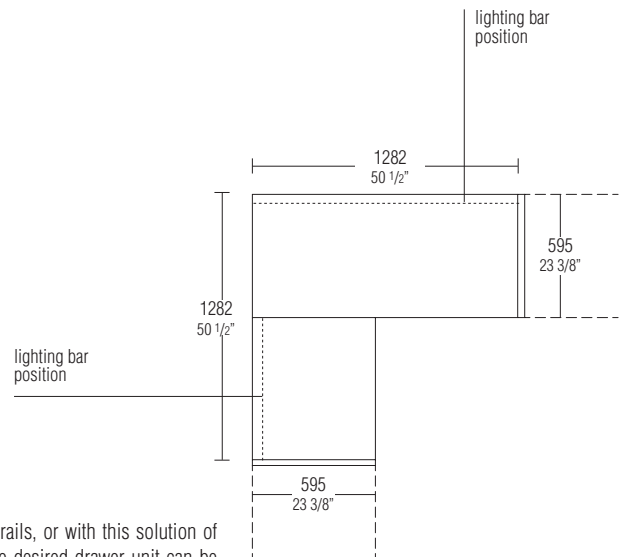
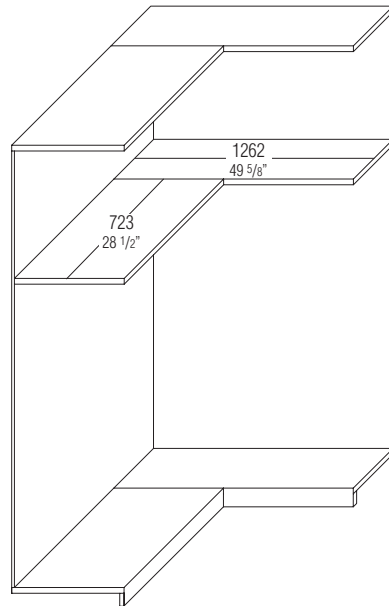

The corner element can be fitted with shelves and clothes rails, or with this solution of drawer units that have a central partition H 1158 where the desired drawer unit can be inserted. The drawer unit can be with fronts W 420 or 584.

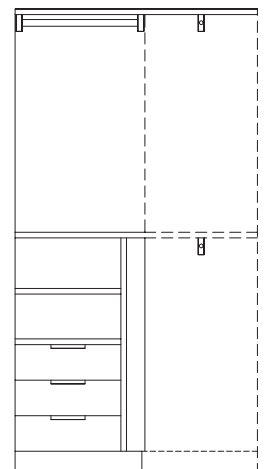
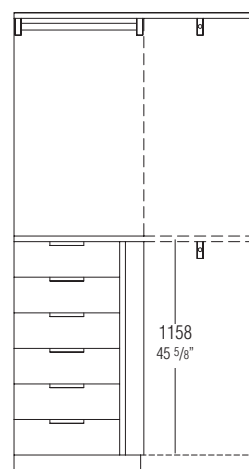
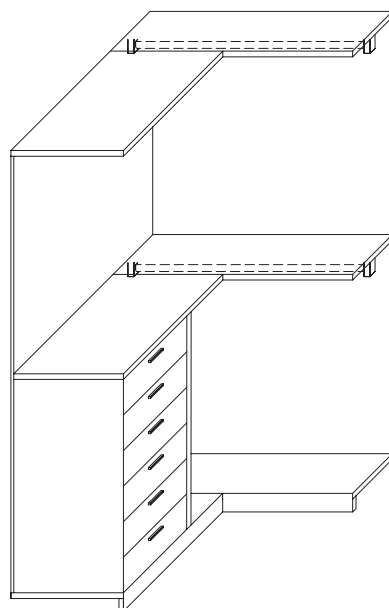

DATASHEET

REGISTERED
 DESIGN

IX.2015

molteni.it

Dimensions in millimeters and inches. The right to discontinue and make changes is reserved. This information is based on the latest product information available at the time of printing.

WARDROBE REDUCTIONS

Structure reductions

Type of reduction	height	width	depth
Linear elements D 595 mm	32 mm intervals	per millimetre	min -20 mm max -256 wardrobe / flush sliding ward. max -160 mm
Linear elements D 435 mm	32 mm intervals	per millimetre	min -20 mm max -96 mm
Corner element for wardrobe with doors	32 mm intervals	no reductions	no reductions
Corner element for walk-in closet without doors	32 mm intervals	no reductions	no reductions
Terminal element	32 mm intervals	no reductions	no reductions
Side panel or central partition	32 mm intervals		reductions depend on linear modules

The retailer should remember to verify the stability of wardrobes having a depth inferior to 595 mm and arrange to have anti-tilt devices mounted if necessary.

Door reductions

Type of reduction	height	width
Wooden hinged doors (START - "A FILO" - GRIP - DEEP - PLASTER - STRIP)	32 mm intervals	per millimetre
"A FILO" glass hinged doors	32 mm intervals	per millimetre
Wooden sliding doors (START - "A FILO" - GRIP - DEEP)	32 mm intervals	ONLY doors W 979 mm - reducible down to W 815 mm
"A FILO" glass sliding doors	32 mm intervals	no reductions
Wooden flush sliding doors (START - "A FILO" - GRIP - DEEP). Flush sliding doors W 1471 mm cannot be reduced.	32 mm intervals	no reductions
"A FILO" glass flush sliding doors	32 mm intervals	no reductions
WINDOW - SKIN - 45° doors	no reductions	no reductions

Reductions of internal fittings

Type of reduction	height	width	depth
Shelves		per millimetre	reductions depend on linear modules
Clothes rails		per millimetre	
Central divider pieces	32 mm intervals		reductions depend on linear modules
Internal drawers / trinket trays, trouser holders and pull-out trays / grid with shirt and sweater holders / shoe rack shelves / pull-out shirt holders / lighting shelves / islands	no reductions	no reductions	no reductions

Cuts to measure

Diagonal cut doors

When compiling the order, indicate the heights H1 and H2 and the width W as in the example.

The cost of a diagonal cut for each single door is the same as that for the hinged door in the table on page of the doors.

Compositions with diagonal slant are always built with single-door compartments. Only fitted with START, "A FILO", GRIP or DEEP hinged doors. Doors must be hinged to the highest side panel. The door finish options for slanted wardrobes are restricted to cartapaglia, matt lacquer and matt lacquered cartapaglia. Structures can be either in standard sizes or customised.

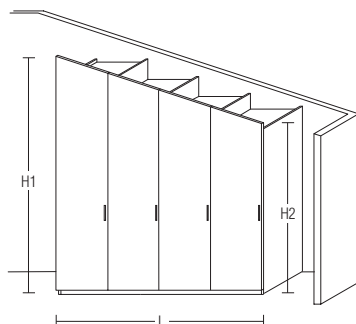

Standard or cut-to-size doors

For these solutions you can use either single or double units with hinged doors.

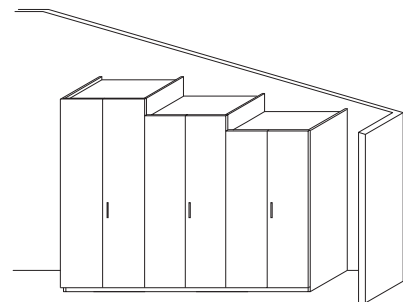

DATASHEET

REGISTERED
DESIGN

IX.2015

molteni.it

Dimensions in millimeters and inches. The right to discontinue and make changes is reserved. This information is based on the latest product information available at the time of printing.

START door th 25

Door with handles mounted on the front.

All the hinged doors have cushion-closing hinges.
The sliding door have a shock absorber mechanism which allows them to open and close softly.

Handles

Type "E"
Type "M"

Notes

Sliding doors and flush sliding doors are not available in H 2889.

With fronts in cartapaglia melamine and cartapaglia lacquer, the exterior of the side panel can be finished in matt lacquer (in the same colour as the front) or in melamine like the internal structure (if the side panel is not visible).

Molteni & C

7—
23

START door

melamine cartapaglia
matt lacquer colours
cartapaglia lacquered colours
glossy lacquer colours
vertical grain wood

Type "E"

standard

Front insert finishes

pewter colour
matt lacquer colours
woods
coloured glass
etched coloured glass

Structure finishes

pewter colour

Type "M"

with surcharge per handle

Finish

pewter colour

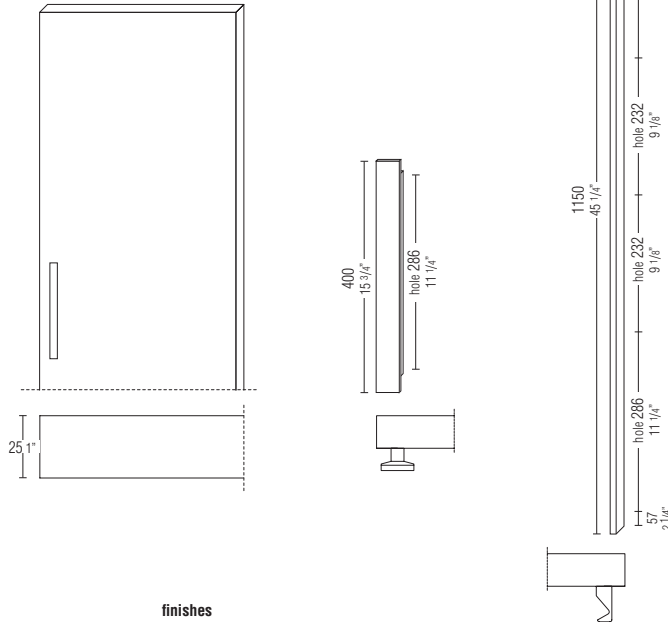

finishes

melamine cartapaglia matt lacquer colours cartapaglia lacquered colours vertical grain wood glossy lacquer colours

hinged doors

width 487 (19 1/8")					
width 651 (25 5/8")					
width 815 (32 1/8")					
width 979 (38 1/2")					
width 1307 (51 1/2")					
door for terminal element					

sliding doors

width 815 (32 1/8")					
width 979 (38 1/2")					
width 1307 (51 1/2")					

flush sliding doors

width 815 (32 1/8")					
width 979 (38 1/2")					
width 1307 (51 1/2")					
width 1471 (57 7/8")					

DATASHEET

REGISTERED
DESIGN

IX.2015

molteni.it

Dimensions in millimeters and inches. The right to discontinue and make changes is reserved. This information is based on the latest product information available at the time of printing.

“A FILO” door th 25

Door with full-height handle included in the thickness of the door.
The door is available in the versions wood and glass.

All the hinged doors have cushion-closing hinges.
The sliding door have a shock absorber mechanism which allows them to open and close softly.

Notes

Sliding doors and flush sliding doors are not available in H 2889.
Glass hinged doors are not available in H 2889.
Flush sliding glass doors cannot be used in compositions with 3 doors.

With fronts in cartapaglia melamine, cartapaglia lacquer and plaster lacquer, the exterior of the side panel can be finished in matt lacquer (in the same colour as the front) or in melamine like the internal structure (if the side panel is not visible).

Molteni & C

8—
23

“A FILO” wooden door

melamine cartapaglia
matt lacquer colours
cartapaglia lacquered colours
plaster lacquered colours
glossy lacquer colours
vertical grain wood

“A FILO” glass door

Glass:
coloured
etched coloured
mirror

Profile and “a filo” handle:
pewter colour

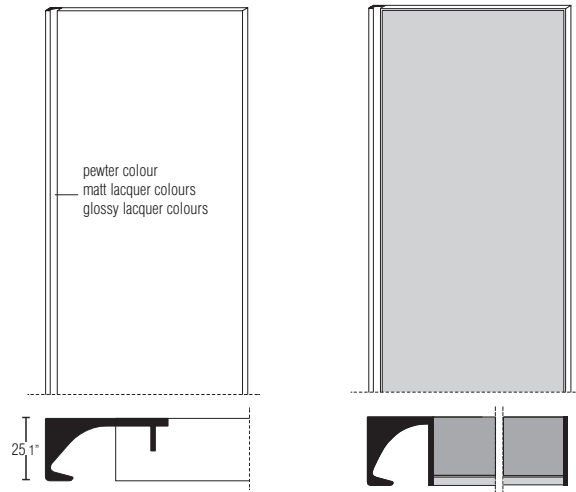

finishes

melamine cartapaglia	matt lacquer colours	cartapaglia lacquered colours	plaster lacquered colours	vertical grain wood	glossy lacquer colours	coloured glass/ etched coloured glass/ mirror
-------------------------	-------------------------	-------------------------------------	---------------------------------	------------------------	---------------------------	---

hinged doors

width 487 (19 1/8")						
width 651 (25 5/8")						
width 815 (32 1/8")						
width 979 (38 1/2")						
width 1307 (51 1/2")						
door for terminal element						

sliding doors

width 815 (32 1/8")						
width 979 (38 1/2")						
width 1307 (51 1/2")						

flush sliding doors

width 815 (32 1/8")						
width 979 (38 1/2")						
width 1307 (51 1/2")						
width 1471 (57 7/8")						

DATASHEET

REGISTERED
DESIGN

IX.2015

molteni.it

Dimensions in millimeters and inches. The right to discontinue and make changes is reserved. This information is based on the latest product information available at the time of printing.

GRIP door th 25 DESIGN VINCENT VAN DUYSSEN

Door with a handle applied laterally on the edge of the door.

All the hinged doors have cushion-closing hinges.
 The sliding door have a shock absorber mechanism which allows them to open and close softly.

Notes

Sliding doors and flush sliding doors are not available in H 2889.

In the pair of hinged doors, the handle is mounted on both doors in the pair.

With fronts in cartapaglia melamine and cartapaglia lacquer, the exterior of the side panel can be finished in matt lacquer (in the same colour as the front) or in melamine like the internal structure (if the side panel is not visible).

Handles finishes

pewter colour
 pewter colour covered in Eco Skin in the colours (with surcharge per handle)

Molteni & C

9—
 23

GRIP door
 melamine cartapaglia
 matt lacquer colours
 cartapaglia lacquered colours
 glossy lacquer colours
 vertical grain wood

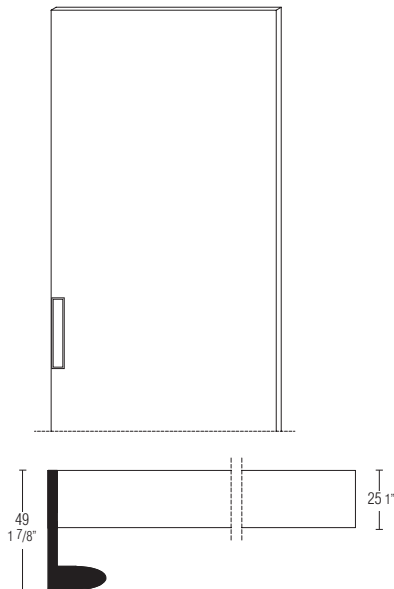

finishes

	melamine cartapaglia	matt lacquer colours	cartapaglia lacquered colours	vertical grain wood	glossy lacquer colours
hinged doors					
width 487 (19 1/8")					
width 651 (25 5/8")					
width 815 (32 1/8")					
width 979 (38 1/2")					
width 1307 (51 1/2")					
door for terminal element					
sliding doors					
width 815 (32 1/8")					
width 979 (38 1/2")					
width 1307 (51 1/2")					
flush sliding doors					
width 815 (32 1/8")					
width 979 (38 1/2")					
width 1307 (51 1/2")					
width 1471 (57 7/8")					

DATASHEET

REGISTERED
 DESIGN

IX.2015

molteni.it

Dimensions in millimeters and inches. The right to discontinue and make changes is reserved. This information is based on the latest product information available at the time of printing.

DEEP door th 25 DESIGN VINCENT VAN DUYSSEN

Door with recessed handle.

All the hinged doors have cushion-closing hinges.
The sliding door have a shock absorber mechanism which allows them to open and close softly.

Notes

Sliding doors and flush sliding doors are not available in H 2889.

In the pair of hinged doors, the handle is mounted on both doors in the pair.

With fronts in cartapaglia melamine and cartapaglia lacquer, the exterior of the side panel can be finished in matt lacquer (in the same colour as the front) or in melamine like the internal structure (if the side panel is not visible).

Handles finishes

pewter colour

pewter colour covered in Eco Skin in the colours (with surcharge per handle)

Molteni & C

10—
23

DEEP door
melamine cartapaglia
matt lacquer colours
cartapaglia lacquered colours
glossy lacquer colours
vertical grain wood

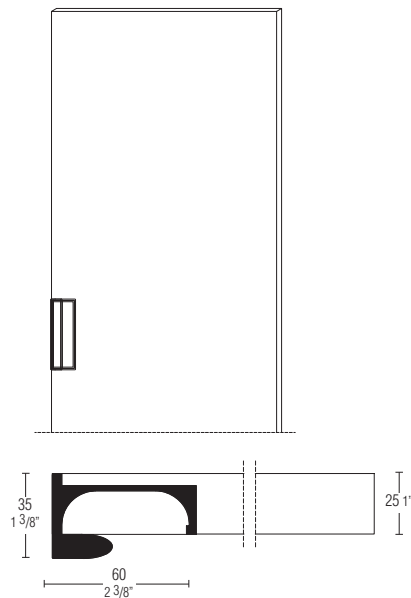

finishes

	melamine cartapaglia	matt lacquer colours	cartapaglia lacquered colours	vertical grain wood	glossy lacquer colours
--	-------------------------	-------------------------	----------------------------------	------------------------	---------------------------

hinged doors

width 487 (19 1/8")					
width 651 (25 5/8")					
width 815 (32 1/8")					
width 979 (38 1/2")					
width 1307 (51 1/2")					
door for terminal element					

sliding doors

width 815 (32 1/8")					
width 979 (38 1/2")					
width 1307 (51 1/2")					

flush sliding doors

width 815 (32 1/8")					
width 979 (38 1/2")					
width 1307 (51 1/2")					

DATASHEET

REGISTERED
DESIGN

IX.2015

molteni.it

Dimensions in millimeters and inches. The right to discontinue and make changes is reserved. This information is based on the latest product information available at the time of printing.

PLASTER door th 25 DESIGN VINCENT VAN DUYSSEN

Door with perimeter profile in pewter colour and melamine panel with a plaster effect finish.

All the hinged doors have cushion-closing hinges.
 The sliding door have a shock absorber mechanism which allows them to open and close softly.

Notes

Flush sliding doors are not available in H 2889.

In the pair of hinged doors, the handle is mounted on both doors in the pair.

With the PLASTER door, the exterior of the side panel can be finished in matt lacquer (in the same colour as the front) or in melamine like the internal structure (if the side panel is not visible).

PLASTER door
 silica coloured melamine

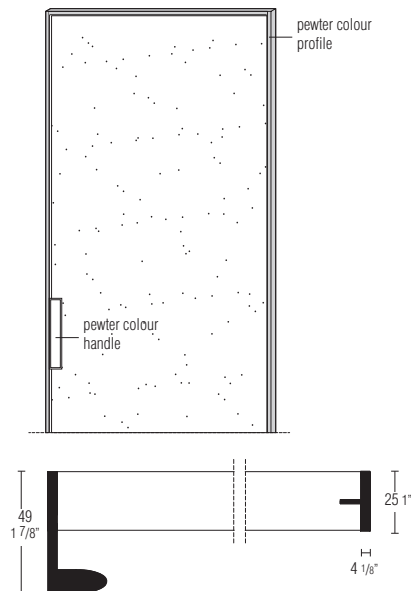

finishes

melamine
 plaster silica

hinged doors

width 487 (19 1/8")	
width 651 (25 5/8")	
width 815 (32 1/8")	
width 979 (38 1/2")	
width 1307 (51 1/2")	
door for terminal element	

flush sliding doors

width 815 (32 1/8")	
width 979 (38 1/2")	
width 1307 (51 1/2")	

DATASHEET

REGISTERED
 DESIGN

IX.2015

STRIP door th 25 DESIGN VINCENT VAN DUYSSEN

Door with a longitudinal Eco Skin strip with a pewter colour profile of the same width of the recessed handle, also finished in Eco Skin.
 The pair of hinged doors always has 2 strips and 2 handles ★

Notes
 Flush sliding doors are not available in H 2889.
 Flush sliding doors wardrobes with 3 doors cannot be made.

Handle finishes
 pewter colour covered in Eco Skin

Eco Skin colours for strip and handle
 grey
 mint
 hemp
 ivory
 dark brown

Molteni & C

STRIP door
 matt lacquer colours
 glossy lacquer colours
 vertical grain wood

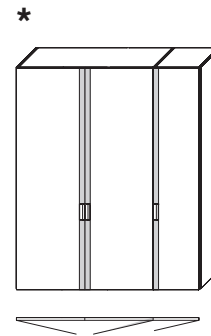
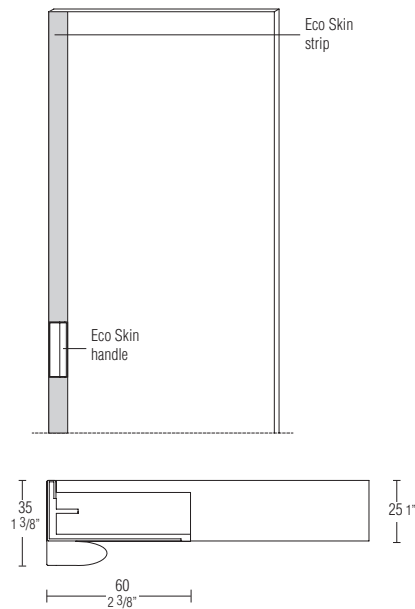

12—
 23

finishes

	matt lacquer colours	vertical grain wood	glossy lacquer colours
hinged doors			
width 487 (19 1/8")			
width 651 (25 5/8")			
width 815 (32 1/8")			
width 979 (38 1/2")			
width 1307 (51 1/2")			
door for terminal element			
flush sliding doors (always with 2 doors)			
width 815 (32 1/8")			
width 979 (38 1/2")			
width 1307 (51 1/2")			

GLISS
MASTER—
VINCENT
VAN DUYSSEN
2015

WINDOW door th 30 DESIGN VINCENT VAN DUYSSEN

Glass hinged door with pewter colour finished aluminium frame and lateral handle.

The doors are fitted with recessed hinges inserted in the base and top.

Notes

WINDOW doors are not available in H 2889.

In the pair of hinged doors, the handle is mounted on both doors in the pair.

Handle finishes

pewter colour

pewter colour covered in Eco Skin in the colours (with surcharge per handle)

Molteni & C

WINDOW glass door

13—
23

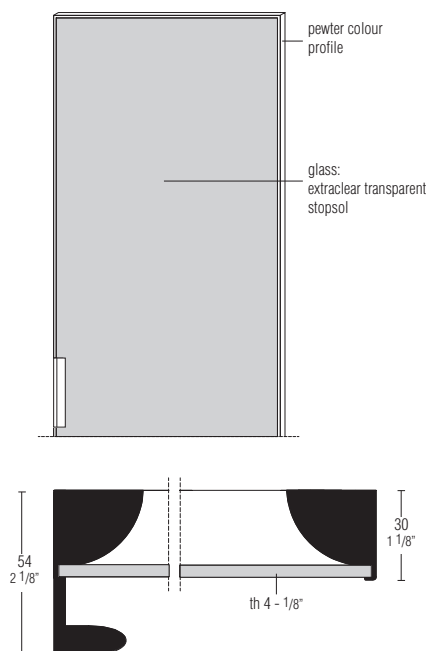

DATASHEET

REGISTERED
DESIGN

IX.2015

molteni.it

Dimensions in millimeters and inches. The right to discontinue and make changes is reserved. This information is based on the latest product information available at the time of printing.

SKIN hinged door th 30 DESIGN VINCENT VAN DUYSSEN

Eco Skin covered hinged door with pewter colour finished aluminium frame and lateral handle.

The doors are fitted with recessed hinges inserted in the base and top.

The door is always divided into 3 equal parts.

Notes

SKIN doors are not available in H 2889.

In the pair of doors, the handle is mounted on both doors in the pair.

Handle finishes

pewter colour

pewter colour covered in Eco Skin in the colours (with surcharge per handle)

Molteni & C

SKIN hinged door

14—
 23

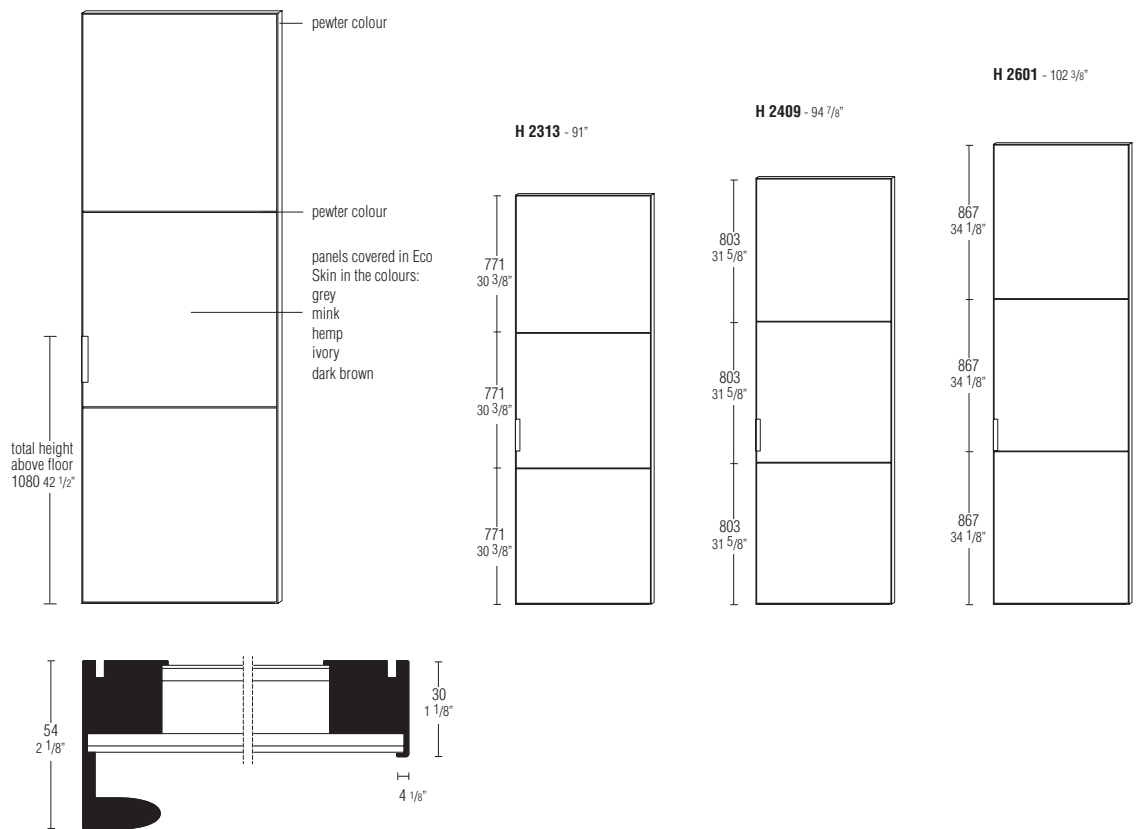

DATASHEET

REGISTERED
 DESIGN

IX.2015

45°/FLUSH SLIDING DOOR DESIGN RON GILAD

The 45° doors have a perimeter trim that also functions as a handle. The sliding doors have a shock absorber mechanism which allows them to open and close softly.

45°/ flush sliding door can be applied only on wardrobes with flush opening with 2 doors

Notes

The 45° doors are not available in H 2889.

Molteni & C

15—
 23

45° mirror/etched coloured glass door
 matt lacquered trim (in the Molteni colour range)
 glossy lacquered trim (in the Molteni colour range)
 pewter colour trim

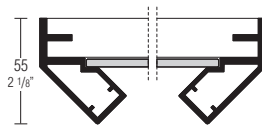
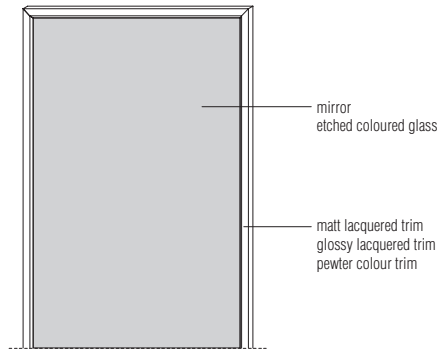

Side panel extension profile for wardrobes exclusively with 45° doors

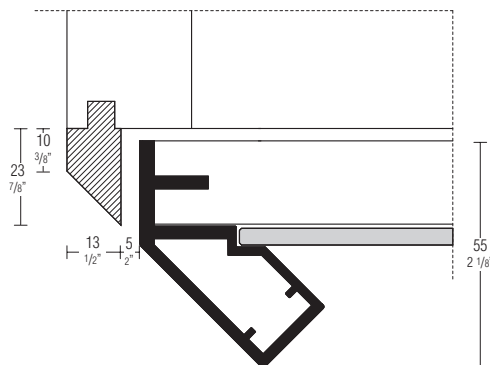

For wardrobes made exclusively with 45° doors, the side panel extension profile is made as indicated, in pewter colour; matt or glossy lacquer coloured finish. Otherwise (mixed doors types), they always come with standard extension profile for the side panel.

DATASHEET

REGISTERED
 DESIGN

IX.2015

FILLERS AND OPENING SIDE TRIMS

Horizontal filler

The filler is supplied in two parts, one part to be fixed to the ceiling to which the other will be hooked on (see diagram below).

The distance of the filler from the door is the client's decision.

In the cartapaglia finish, the grain direction is always vertical.

In the wood finish, the grain direction is always horizontal.

Vertical filler

The vertical filler can be placed flush with the structure or the door.

This detail must be specified in the order to prepare the side panel (see example).

If this detail is not specified when placing the order, the filler will automatically be placed flush with the structure and the side panel will have the extension profile.

Opening fillers

Can be made with START and "A FILO" door. For handles, see surcharge. Always have the 165° hinges.

Are the same height as the other doors in the composition.

Have a closing strip on their lower part.

In the wood finish, the grain direction is always vertical.

16—
 23

Horizontal filler side sections

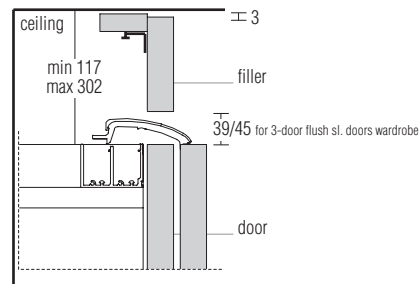
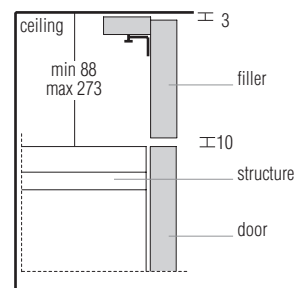

Vertical filler horizontal sections

Flush with structure

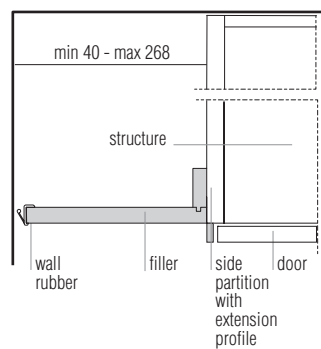

Flush with door

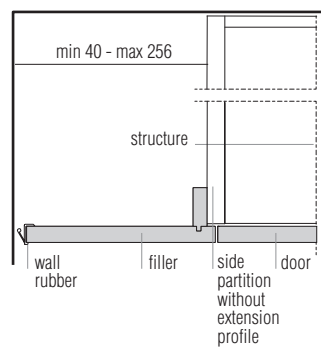

Set back

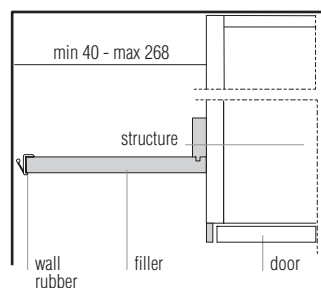

Opening filler horizontal sections

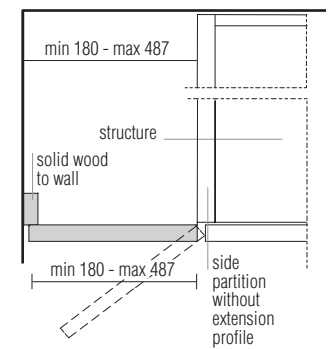

DATASHEET

REGISTERED
 DESIGN

IX.2015

molteni.it

Dimensions in millimeters and inches. The right to discontinue and make changes is reserved. This information is based on the latest product information available at the time of printing.

INTERNAL FITTINGS

Molteni & C

17—
 23

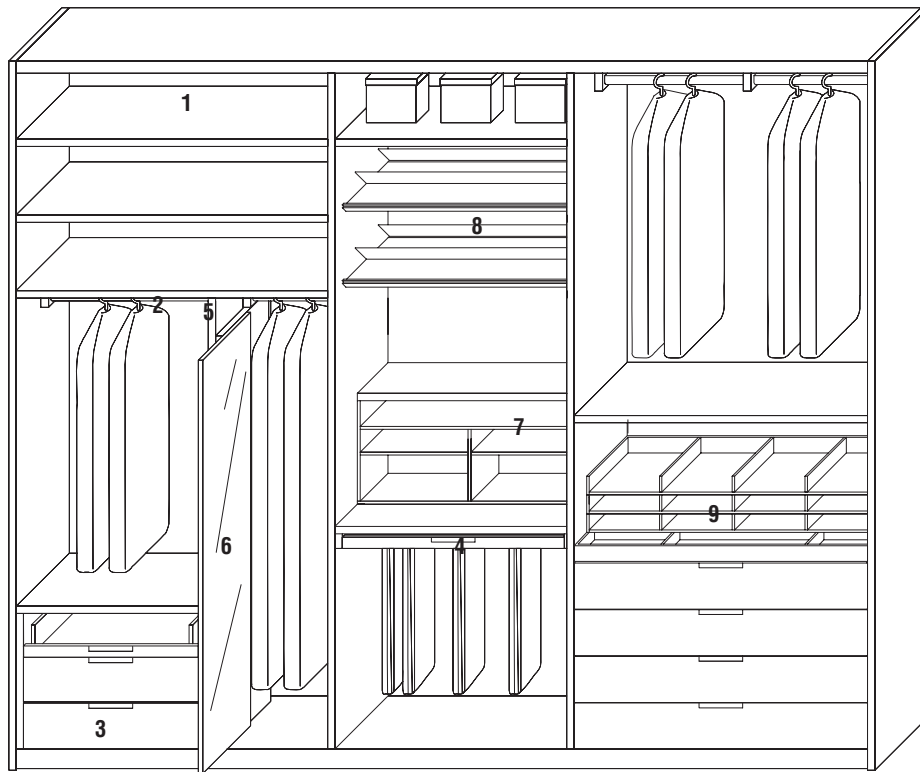

- | | | |
|---------------------------|-----------------------------------|---------------------------------------|
| 1 Shelf th 30 mm (1 1/8") | 4 Trouser holder | 7 Grid with shirt and sweater holders |
| 2 Clothes rail | 5 Central divider piece, th mm 30 | 8 Shoe rack shelves |
| 3 Modular drawer unit | 6 Swivel pull-out mirror | 9 Pull-out shirt holder |

Section of internal fittings

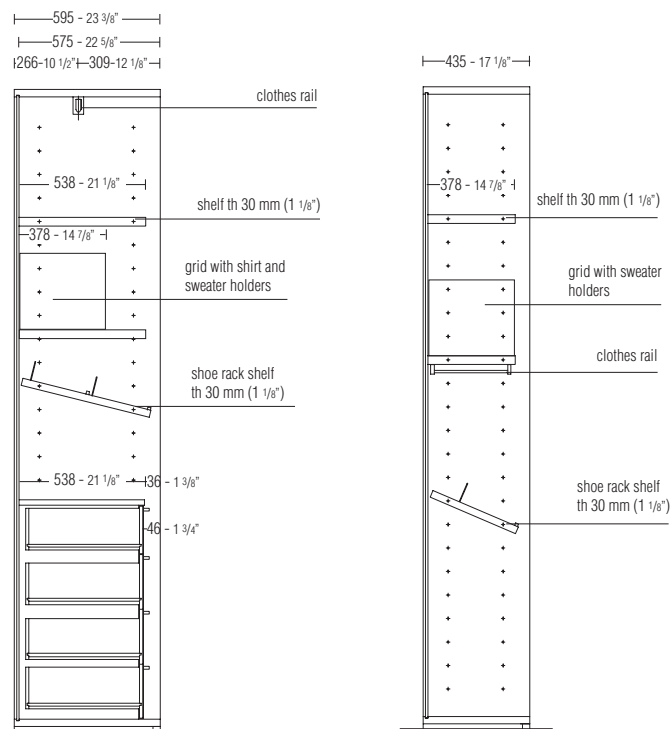

DATASHEET

REGISTERED
 DESIGN

IX.2015

INTERNAL FITTINGS - SHOE RACK SHELVES - GRID WITH SHIRT AND SWEATER HOLDERS

Shoe rack shelves D 538 th 30

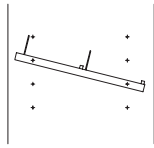

W 462
RSP/4

W 626
RSP/6

W 790
RSP/8

W 954
RSP/9

W 1282
RSP/13

Molteni & C

18—
23

Shoe rack shelves D 368 th 30

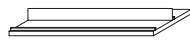
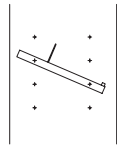

W 462
RQP/4

W 626
RQP/6

W 790
RQP/8

W 954
RQP/9

W 1282
RQP/13

Grid with shirt and sweater holders

These elements are fixed and to be used set on shelves or on drawer units.
To set the unit on a shelf measuring mm 1282, consider using a reinforced shelf.

Grid with shirt and sweater holders

W 626 D 378 H 480

W 790 D 378 H 480

W 954 D 378 H 480

W 1282 D 378 H 480

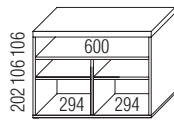

BGR6/05/1

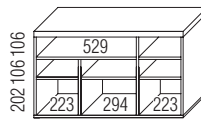

BGR8/05/1

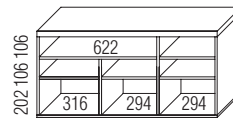

BGR9/05/1

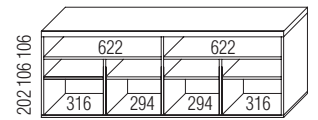

BGR13/05/1

Examples of use

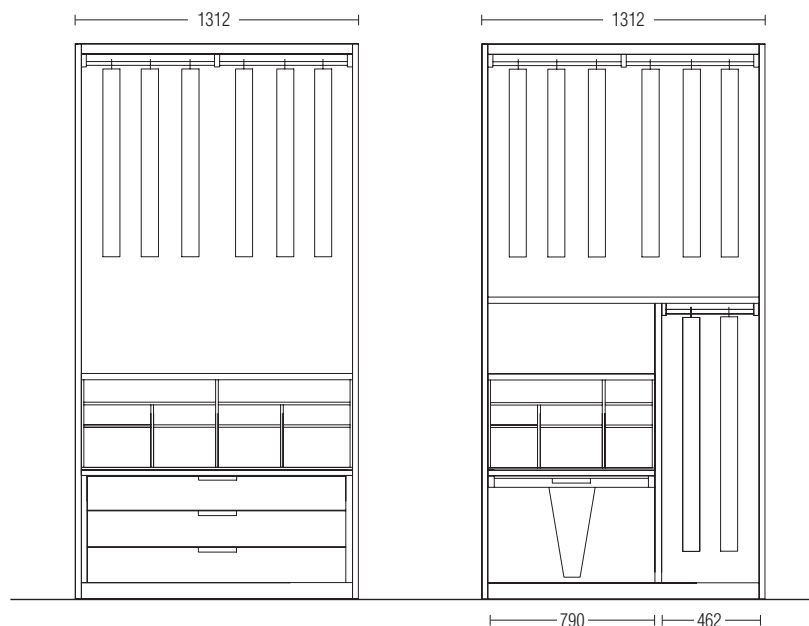

DATASHEET

REGISTERED
DESIGN

IX.2015

molteni.it

Dimensions in millimeters and inches. The right to discontinue and make changes is reserved. This information is based on the latest product information available at the time of printing.

INTERNAL FITTINGS - PULL-OUT SHIRT HOLDER

These units can be positioned on the floor-standing drawer units or suspended over a drawer H 190 of the same dimensions as the shirt unit (see example).

Finishes

The tray set on top of the shelf is always finished in melamine in the same finish as the structure with Eco Skin bottom grey finish. The shirt holder grid is always dolomite lacquered.

example

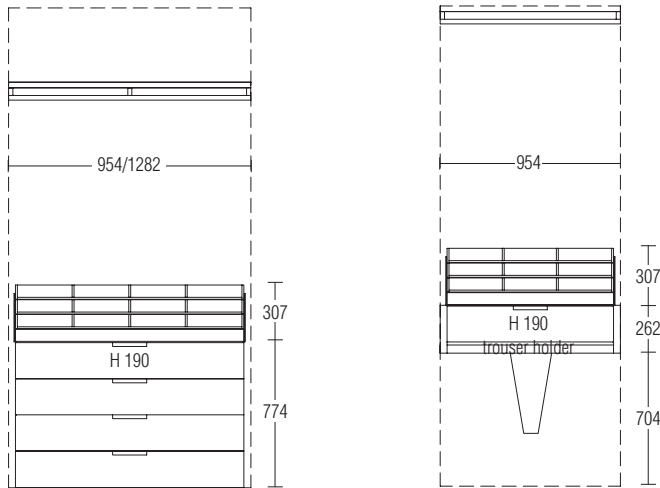

When ordering, specify the finishes of the trays set on shelves and the shirt holder grid

for compartment
W 954
including resting shelf

for compartment
W 1282
including resting shelf

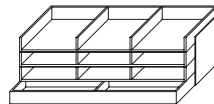

BPC9/03/1

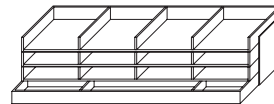

BPC13/03/1

DATASHEET

REGISTERED
DESIGN

IX.2015

INTERNAL FITTINGS - MODULAR DRAWERS AND TRAYS

Notes

The parts of this internal fittings are produced with width and height dimensions corresponding to the modular compartments. This makes it possible to organise the internal spaces in a number of ways. To correctly and quickly determine the internal fittings, are available some of the possible compositions. The pairs of side panels suspended or resting on the floor are essential for inserting all the elements. Compositions must be completed with a top shelf. The handle is always pewter colour finish.

No reductions of any kind can be made on drawers, trays and pairs of side panels.

Warnings for use in spaces next to a corner:

Do not use trouser trays or trinket trays (used individually).

Finishes of wooden drawers and open drawers

melamine front in structure finish
 grey saffiano melamine interior

Finishes of glass drawers

transparent glass front with pewter colour frame
 grey saffiano melamine interior

Molteni & C

20—
 23

Wooden drawers

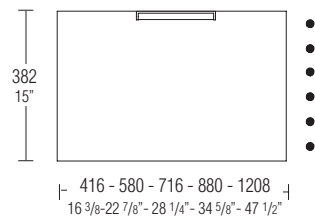
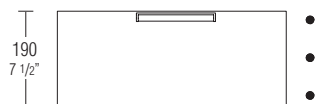

Glass drawers

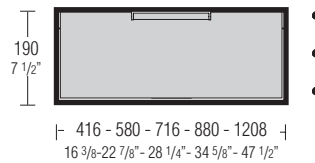

Open drawers

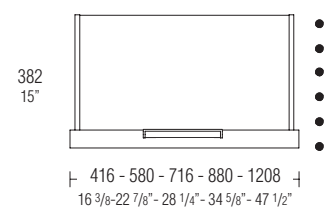
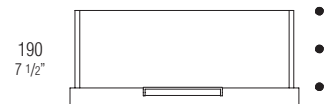
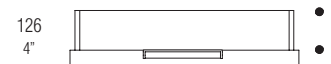

DATASHEET

REGISTERED
 DESIGN

IX.2015

molteni.it

Dimensions in millimeters and inches. The right to discontinue and make changes is reserved. This information is based on the latest product information available at the time of printing.

INTERNAL FITTINGS - MODULAR DRAWERS AND TRAYS

Finishes of trouser holder

melamine front in structure finish
 grey saffiano melamine internal frame with trouser rod painted in grey saffiano embossed

Finishes of trinket tray

melamine front in structure finish
 frame interior, bottom and grid in grey saffiano melamine

Finishes of pull-out trays

melamine front in structure finish
 with top and back panel in grey saffiano melamine

Handle in pewter colour finish

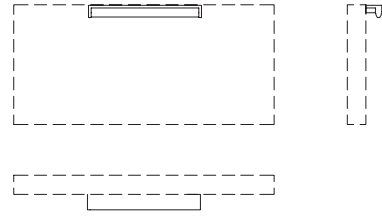

Notes

Prices of drawers, trays and pull-out trays include the cost of the pewter colour finish handle. For the handle covered in Eco Skin, add a supplementary charge for each handle.

Trouser holder

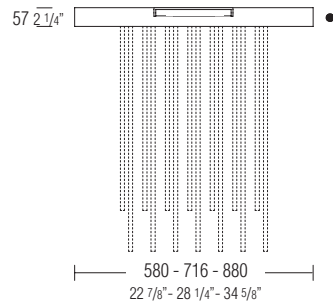

N.B.: usable only with suspended side panels as the bottom piece

Trinket trays (tie and belt) with internal grid

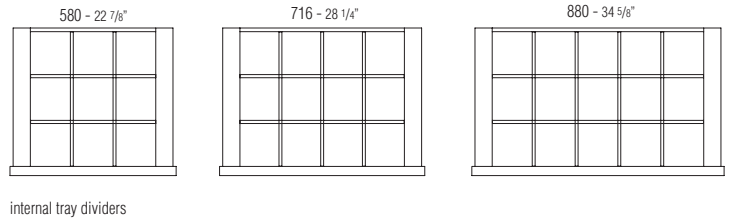
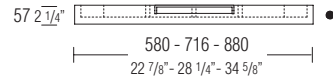

Pull-out trays

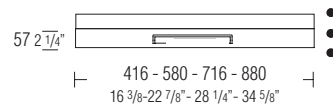

INTERNAL FITTINGS - DRAWER ACCESSORIES

Drawer interiors can be equipped with bottoms and trays in grey Eco Skin. Trays are inserted inside drawers following the modularity shown in the diagram.

Molteni & C

22—
 23

Eco Skin trays
 W 150 D 432 H 50 (A)

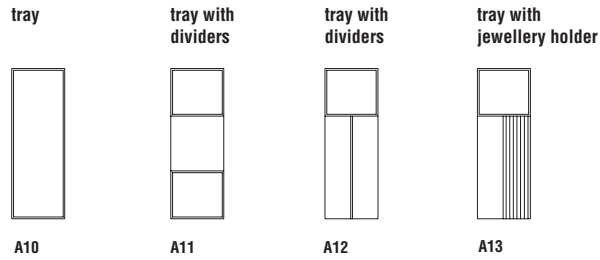

Eco Skin trays
 W 365 D 432 H 50 (B)

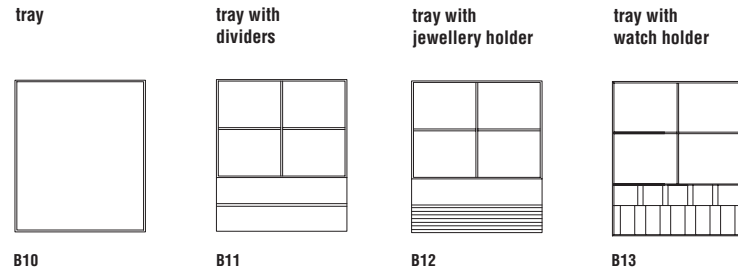

Modularity drawings for inserting trays into drawers

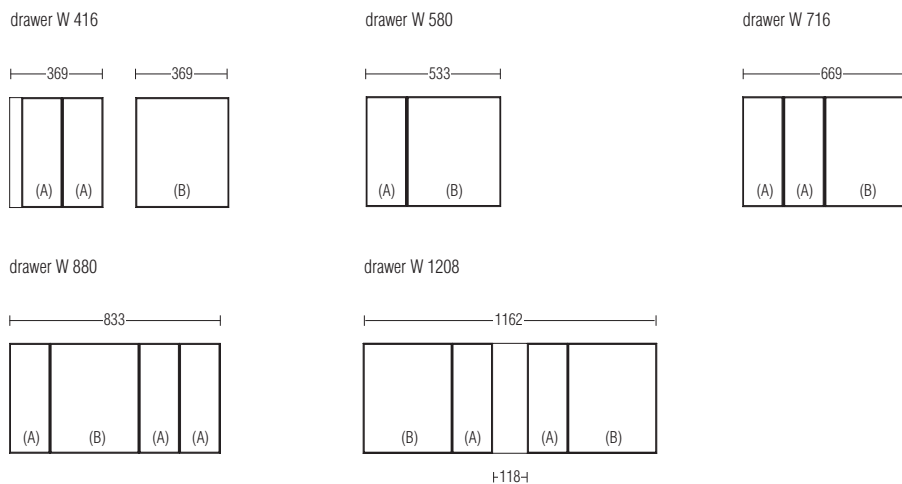

Eco Skin bottoms for drawers D 432



ISLAND DRAWER UNIT - DRAWER UNIT

Island drawer unit

Made completely in larix dark melamine, is available in two versions: with or without trinket trays in dolomite lacquer. Shelves in Eco Skin are available in colours in the catalogue. Standard handles are mounted, in pewter colour finish. It is possible to make handles covered in Eco Skin with a supplemental charge for each handle.

version with trinket trays

- Side A has 6 drawers H 190 and 2 extractable trinket tray blocks.
- Side B has 4 drawers H 190 and and lower open compartments.

version without trinket trays

- Side A has 6 drawers H 190 and upper open compartment.
- Side B has 4 drawers H 190 and and lower open compartments.

Dimensions of the island cannot be reduced, and the composition cannot be modified.

It is possible to use glass drawers instead of wood drawers and add the difference in price between **CLN8/19** and **CVN8/19**.

Molteni & C

23—
23

island drawer unit with trinket trays

W 1518 D 1022 H 897
W 59 3/4" D 40 1/4" H 35 3/8"

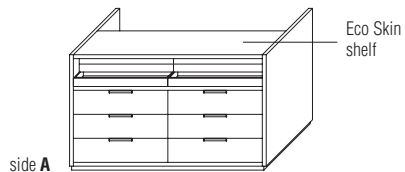

ISC15/09/1

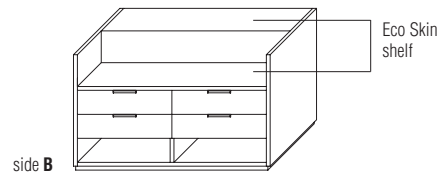

island drawer unit without trinket trays

W 1518 D 1022 H 897
W 59 3/4" D 40 1/4" H 35 3/8"

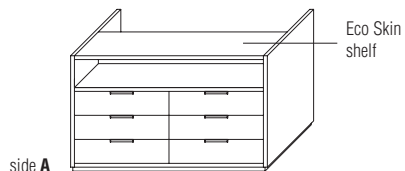

ISC15/09/2

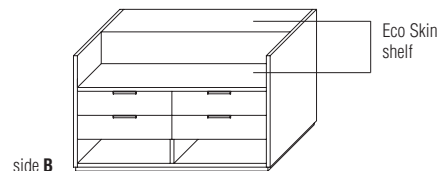

Drawer unit

Made in larix dark or matt lacquer in Molteni range colours. Standard handles are mounted, in pewter colour finish. It is possible to make handles covered in Eco Skin with a supplemental charge for each handle.

W 1292 D 527 H 897
W 50 7/8" D 20 3/4" H 35 3/8"

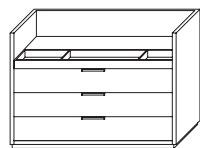

ISC13/09/1

DATASHEET

REGISTERED
DESIGN

IX.2015

molteni.it

Dimensions in millimeters and inches. The right to discontinue and make changes is reserved. This information is based on the latest product information available at the time of printing.

FINISHES MOLTENI&C RANGE

IX.2015

	MATT LACQUER OPEN GRAIN LACQUER	GLOSSY LACQUER	COLOURED GLASS	ETCHED COLOURED GLASS	PLASTER LACQUERED CARTAPAGLIA LACQUERED <i>only Gliss Master</i>
CHALK WHITE	•	•	•	•	•
IVORY	•				•
PEARL	•	•	•	•	•
SILICA	•	•	•	•	•
SAND	•	•	•	•	•
PLATINUM	•	•	•	•	•
DUNE	•	•	•	•	•
CLAY	•	•	•	•	•
DOLOMITE GREY	•	•	•	•	•
BORDEAUX	•	•	•	•	•
RUBY	•	•	•	•	•
CARAMEL	•	•	•	•	•
MOKA	•	•	•	•	•
MUSTARD	•	•	•	•	•
CADMIUM	•	•	•	•	•
LIGHT BLUE GREY	•	•	•	•	•
LEAD	•	•	•	•	•
ANTHRACITE	•	•	•	•	•
BLACK	•	•	•	•	•
LESSLESS RED	•				
	only matt lacquer				

Molteni & C

FINISHES MOLTENI&C RANGE

IX.2015

WOODS

EUCALYPTUS

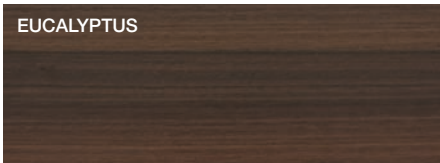

AMERICAN WALNUT



GREY OAK



BLACK OAK

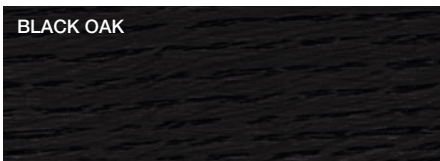

DARK ELM



LIGHT ELM



CEDAR



MARBLES

WHITE CARRARA

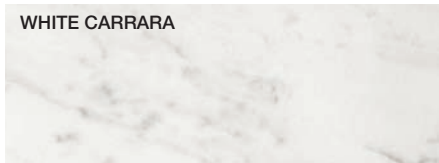

RED LAGUNA



EMPERADOR DARK

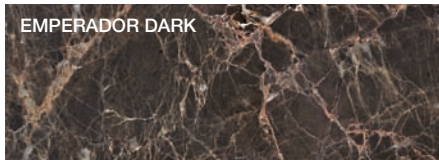

BLACK MARQUINA

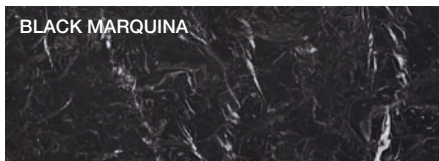

GRES

WHITE

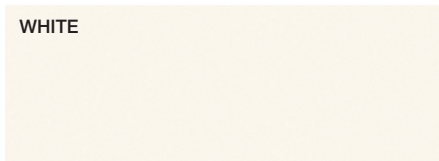

ANTHRACITE



METAL PARTS

BLACK CHROME

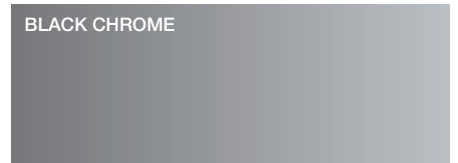

SHINY ALUMINIUM

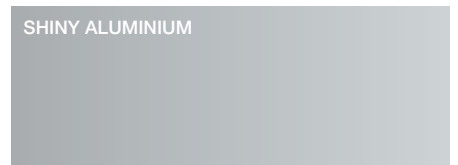

PEWTER COLOUR

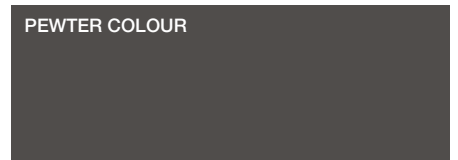

DWELL
DOOR FRAME, TRACK COVERING PROFILES

ANODISED ALUMINIUM



BROWN ALUMINIUM

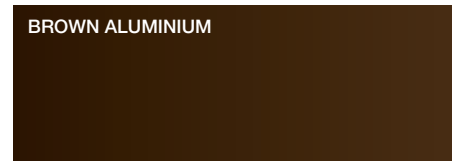

The finishes shown are indicative and refer to the entire production range. We recommend that you consult the "Colour Range" samples which shown the complete range of finishes, including those not shown here. Molteni&C reserves the right to modify the range without warning.

Molteni & C

FINISHES MOLTENI&C RANGE

IX.2015

MILLERIGHE
GLISS QUICK FRONT

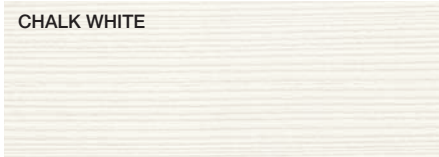

CARTAPAGLIA
GLISS MASTER FRONT
GLISS QUICK, GLISS WALK-IN FRONT

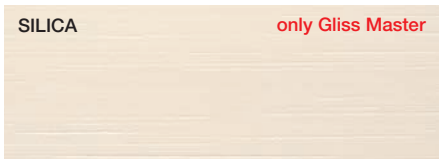

MILLERIGHE
GLISS QUICK, GLISS-UP STRUCTURE

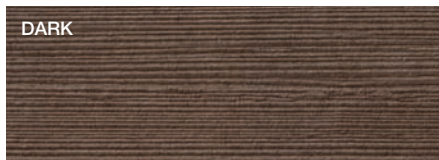

ECO SKIN **only Gliss Master**

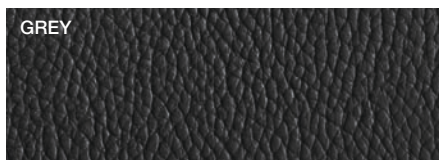
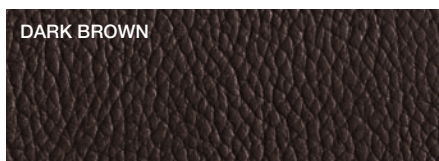

PLASTER **only Gliss Master**



MELAMINE STRUCTURE **only Gliss Master**

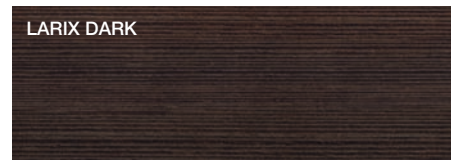
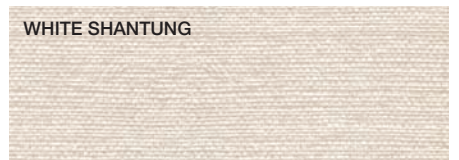

Larix dark finish available also for Gliss Walk-In where specifically indicated in the pricelist