

Molteni & C

FORTEPIANO— RODOLFO DORDONI 2011

1—
10



A system based on only three fundamental elements that can be freely combined together: floor or suspended storage units, modular shelves and display shelves. These simple ingredients enable the creation of infinite new solutions that are quick and fun to customize also thanks to a wide range of finishes: lacquers, wood and glass in various colours. A system that places utmost importance on flexibility while never sacrificing function and storage space. An innovative system suitable for contemporary living that offers certain solutions for manifold living needs. Fortepiano is a patented model.

DATASHEET

REGISTERED
DESIGN

I.2015

molteni.it

Dimensions in millimeters and inches. The right to discontinue and make changes is reserved. This information is based on the latest product information available at the time of printing.

FINISHES

	matt lacquer colours	coloured etched glass	woods	smoked glass/ extra clear transparent glass
modular shelves				
partitions				
storage units / open sided storage units				
structure				
wooden flap door				
wooden hinged door				
drawer				
glass flap door with shiny aluminium trim				
glass hinged door with shiny aluminium trim				
display shelves				

Molteni & C

2—
10

colours

Matt lacquer

BC chalk white
AV ivory
PE pearl
DN dune
PL platinum
PB lead
NE black
RT venetian red
BO bordeaux
AT anthracite
SE mustard
SI silica
DO dolomite grey
AL clay
AR orange
MK moka
AQ aquamarine
CM caramel
CZ light blue grey
SA sand

Coloured etched glass

BC chalk white
PE pearl
DN dune
PL platinum
PB lead
NE black
RT venetian red
BO bordeaux
AT anthracite
SE mustard
SI silica
DO dolomite grey
AL clay
AR orange
MK moka
AQ aquamarine
CM caramel
CZ light blue grey
SA sand

Woods

EU eucalyptus
RN black oak
OC light elm
OS dark elm

DATASHEET

REGISTERED
DESIGN

I.2015

molteni.it

Dimensions in millimeters and inches. The right to discontinue and make changes is reserved. This information is based on the latest product information available at the time of printing.

TECHNICAL INFORMATION

MODULAR SHELVES

Wood particleboard with melamine facing painted in the colours available in the “Molteni Range”.

STORAGE UNITS WITH DRAWER, HINGED OR FLAP DOOR, OPEN SIDED STORAGE UNITS
 Wood particleboard with melamine facing painted in the colours available in the “Molteni Range”.

DISPLAY SHELF

Honeycomb core wood panel, finished with sliced Oak (Quercus), Elm (Ulmus rubra), Eucalyptus (Eucalyptus globulus) veneer or melamine and painted in the colours of the “Molteni Range”. Metal wall brackets.

COVERING PANEL

Chipboard panel, finished with sliced Oak, Elm, Eucalyptus veneer or melamine and painted in the colours of the “Molteni Range”.

UNDERTOP TRACK

Extruded anodised aluminium.

GLASS DOOR

Extruded anodised aluminium frame. 4 mm thick tempered etched coloured crystal.

PARTITION FOR MODULAR SHELVES

8 mm thick tempered crystal.

SIDE AND INNER BOTTOM PANELS OF THE DRAWER

Particleboard panel, with melamine veneer.

MODULAR SHELVES

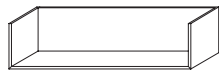

PARTITIONS FOR MODULAR SHELVES

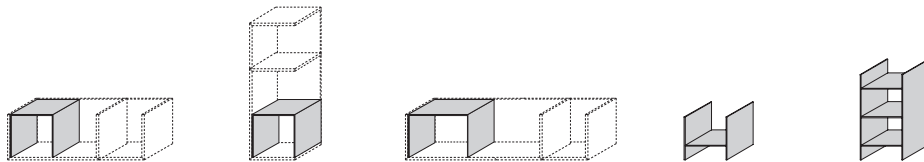

STORAGE UNITS WITH DRAWER, HINGED OR FLAP DOOR, OPEN SIDED STORAGE UNITS

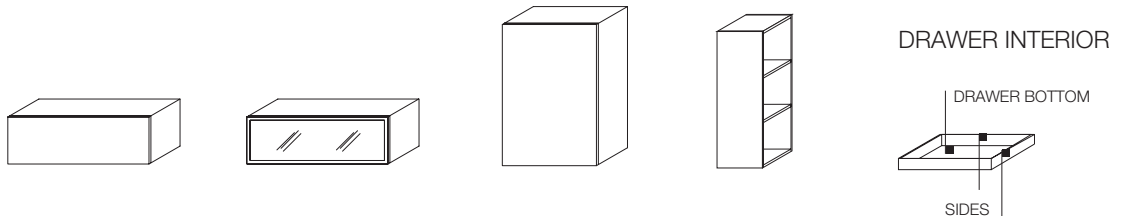

DISPLAY SHELF



COMPOSITIONS EXAMPLES

Molteni & C

4—
 10

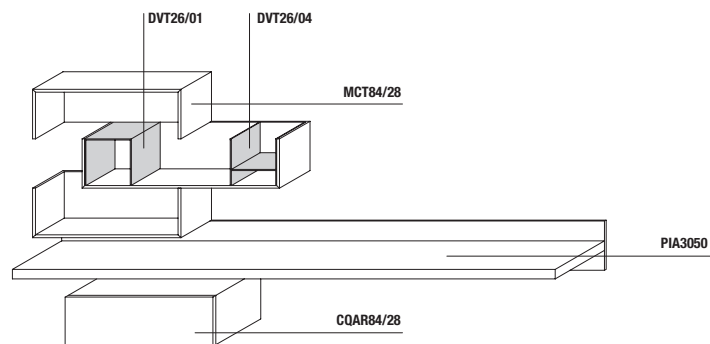
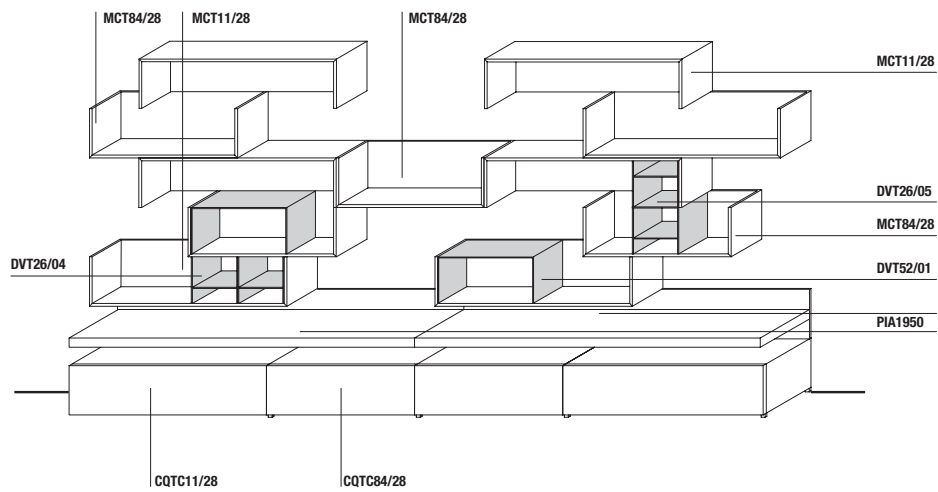
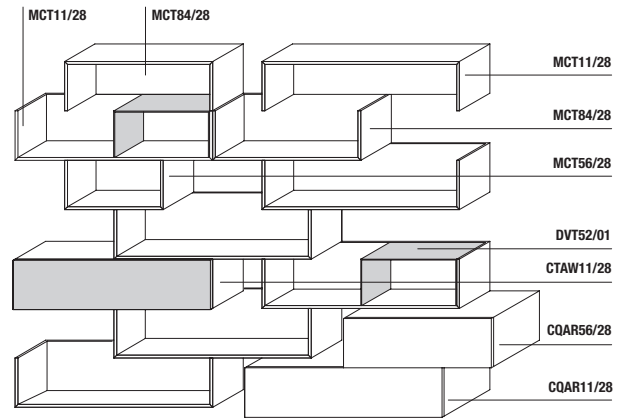
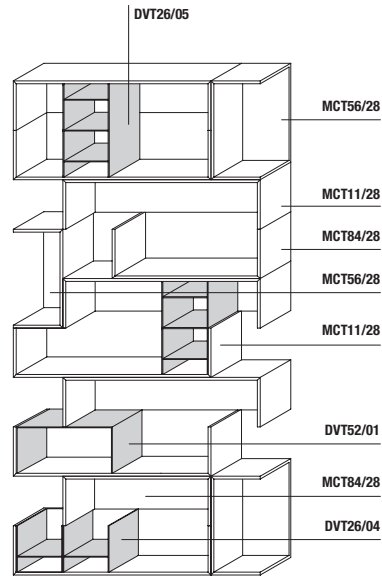

DATASHEET

REGISTERED
 DESIGN

I.2015

DIMENSIONS

Modular shelves

Modular shelves can be freely suspended or joined together respecting the composition design, to create compositions articulated in their form and size.
 Each single shelf is predisposed for fixing to the wall in the direction required by the client and comes with the hardware necessary for all composition combinations.

single elements

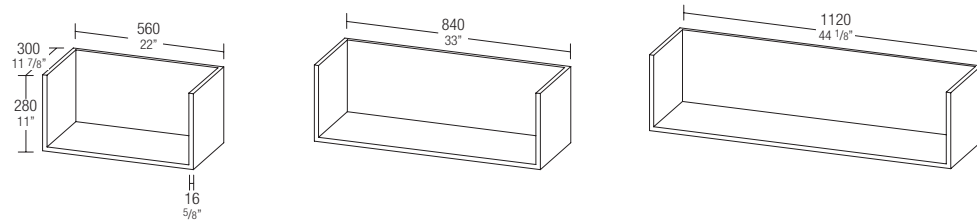

composition possibilities

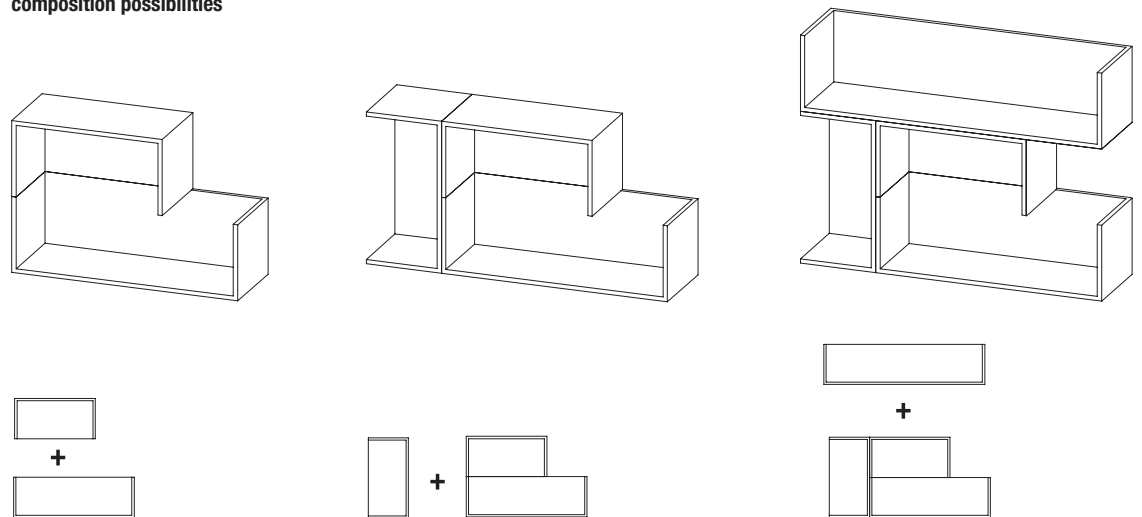

open sided storage unit

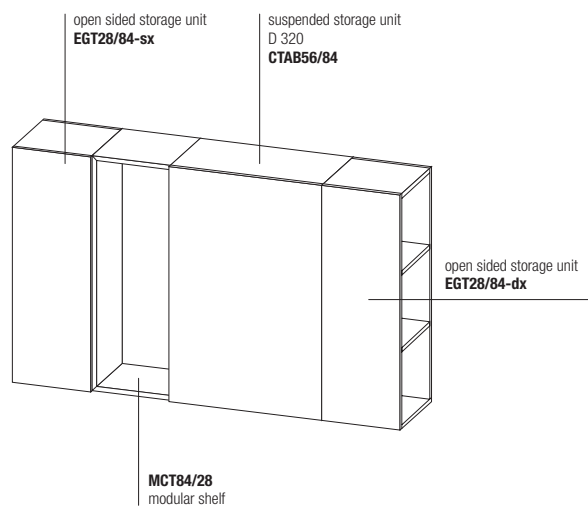

Molteni & C

5—
 10

DATASHEET

REGISTERED
 DESIGN

I.2015

molteni.it

Dimensions in millimeters and inches. The right to discontinue and make changes is reserved. This information is based on the latest product information available at the time of printing.

DIMENSIONS

modular shelves
D 300 H 280 th 16
D 11 7/8" H 11" th 5/8"

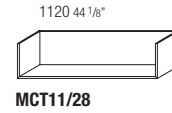
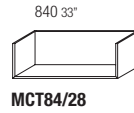
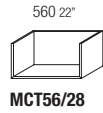

Bridge element partitions can be placed only on shelves positioned as shown in the drawings below

bridge partitions for modular shelves
D 282 H 263 th 6
D 11 1/8" H 10 3/8" th 3/8"

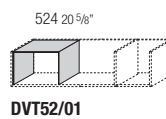
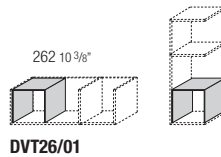

partitions for modular shelves
D 282 W 262 th 6
D 11 1/8" W 10 3/8" th 3/8"

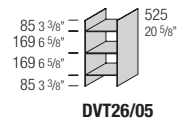
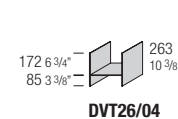

SUSPENDED STORAGE UNITS D 320 / OPEN SIDED STORAGE UNIT

horizontal D 320 H 280 D 12 5/8" H 11"
with wooden flap door

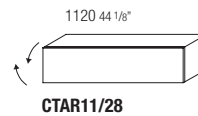
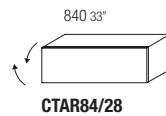
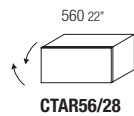

horizontal D 320 H 280 D 12 5/8" H 11"
with glass flap door

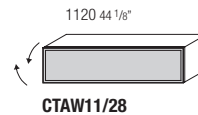
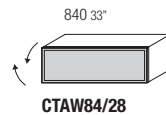
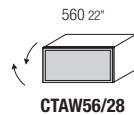

vertical D 320 W 280 D 12 5/8" W 11"
with wooden hinged door

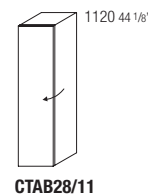
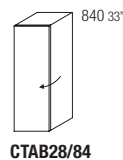

vertical D 320 W 280 D 12 5/8" W 11"
with glass hinged door

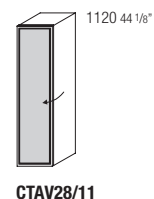
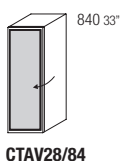

DATASHEET

REGISTERED
DESIGN

I.2015

molteni.it

Dimensions in millimeters and inches. The right to discontinue and make changes is reserved. This information is based on the latest product information available at the time of printing.

DIMENSIONS

SUSPENDED STORAGE UNITS D 320 / OPEN SIDED STORAGE UNIT

vertical D 320 W 560 D 12 5/8" W 22"
with wooden hinged door

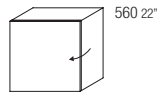

CTAB56/56

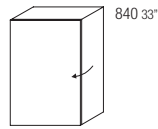

CTAB56/84

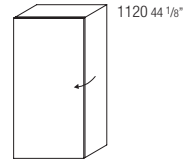

CTAB56/11

vertical D 320 W 560 D 12 5/8" W 22"
with glass hinged door

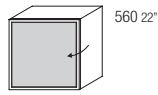

CTAV56/56

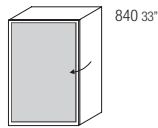

CTAV56/84

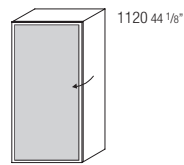

CTAV56/11

**left-sx or right-dx
open sided storage unit
D 320 W 280 D 12 5/8" W 11"**

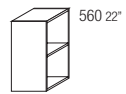

right-dx version

EGT28/56



EGT28/84

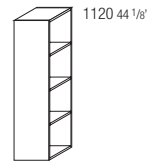

EGT28/11

SUSPENDED STORAGE UNITS D 470

horizontal D 470 H 280 D 18 1/2" H 11"
with wooden flap door

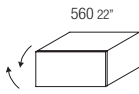

CQAR56/28

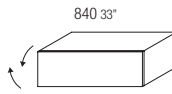

CQAR84/28

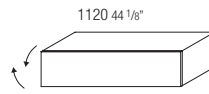

CQAR11/28

horizontal D 470 H 280 D 18 1/2" H 11"
with glass flap door

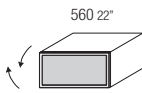

CQAW56/28

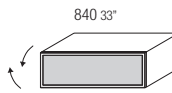

CQAW84/28

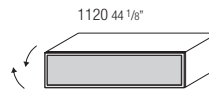

CQAW11/28

horizontal D 470 H 280 D 18 1/2" H 11"
with wooden drawer

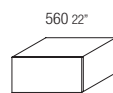

CQAC56/28

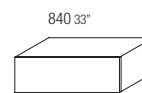

CQAC84/28

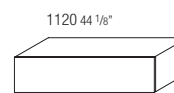

CQAC11/28

**wire passage for top of
horizontal suspended
storage units D 470
W 112 D 57 W 4 3/8" D 2 1/4"**



EPA3

DIMENSIONS

SUSPENDED STORAGE UNITS D 470

vertical D 470 W 280 D 18 1/2" W 11"
with wooden hinged door

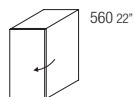

CQAB28/56

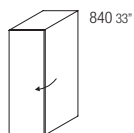

CQAB28/84

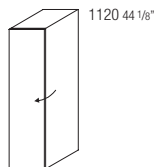

CQAB28/11

vertical D 470 W 280 D 18 1/2" W 11"
with glass hinged door

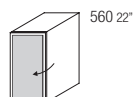

CQAV28/56

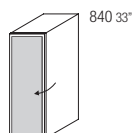

CQAV28/84

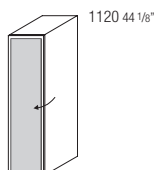

CQAV28/11

vertical D 470 W 560 D 18 1/2" W 22"
with wooden hinged door

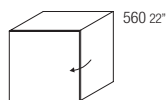

CQAB56/56

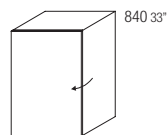

CQAB56/84

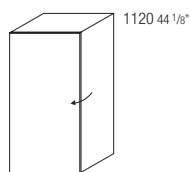

CQAB56/11

vertical D 470 W 560 D 18 1/2" W 22"
with glass hinged door

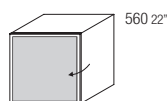

CQAV56/56

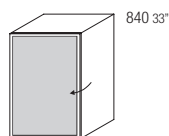

CQAV56/84

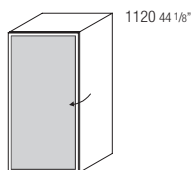

CQAV56/11

DATASHEET

REGISTERED
DESIGN

I.2015

DIMENSIONS

FLOOR STANDING STORAGE UNITS D 470

horizontal D 470 H 300 D 18 1/2" H 11 3/4"
 with wooden flap door

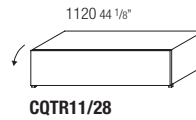
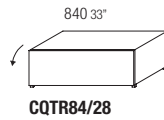
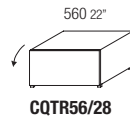

horizontal D 470 H 300 D 18 1/2" H 11 3/4"
 with glass flap door

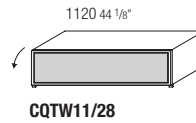
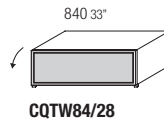
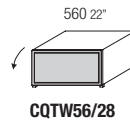

horizontal D 470 H 300 D 18 1/2" H 11 3/4"
 with wooden drawer

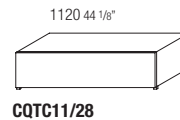
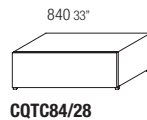
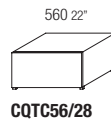

vertical D 470 W 280 D 18 1/2" W 11"
 with wooden hinged door

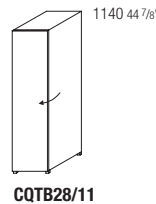

vertical D 470 W 280 D 18 1/2" W 11"
 with glass hinged door

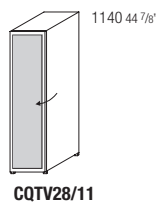
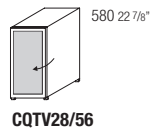

vertical D 470 W 560 D 18 1/2" W 22"
 with wooden hinged door

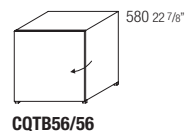

vertical D 470 W 560 D 18 1/2" W 22"
 with glass hinged door

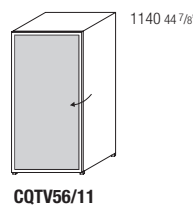
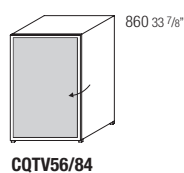
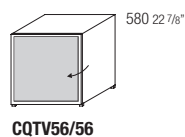

wire passage for top of
 horizontal floor standing
 storage units D 470
 W 112 D 57 W 4 3/8" D 2 1/4"



Molteni & C

DIMENSIONS

DISPLAY SHELVES D 500

Storage unit-shelf wiring diagram

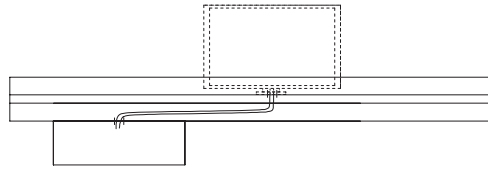

display shelves
D 500 H 280
D 19 5/8" H 11"
shelf th 53 mm

W 1400 W 55 1/8"

W 1960 W 77 1/8"

W 2520 W 99 1/4"

W 3080 W 121 1/4"

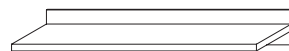

PIA14/50

PIA19/50

PIA25/50

PIA30/50

detachable undertop track

W 1400 W 55 1/8"

W 1960 W 77 1/8"

W 2520 W 99 1/4"

W 3080 W 121 1/4"

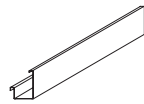
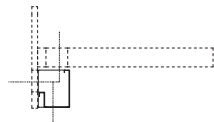

PCS14

PCS19

PCS25

PCS30

wire passage
for display shelf
W 112 D 57
W 4 3/8" D 2 1/4"

receiver system
TV signals



EPA4

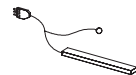

ETV1

Positioning of the wire passage along the display shelf

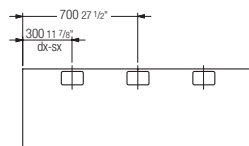

W 1400 W 55 1/8"

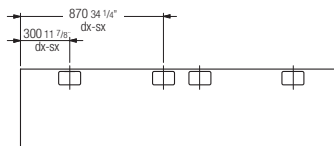

W 1960 W 77 1/8"

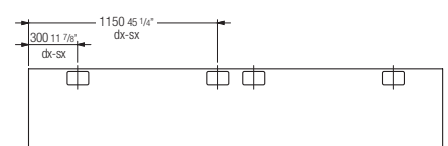

W 2520 W 99 1/4"

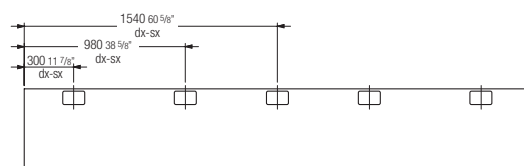

W 3080 W 121 1/4"

DATASHEET

REGISTERED
DESIGN

I.2015

FINISHES

	MATT LACQUER/ OPEN GRAIN LACQUER	GLOSSY LACQUER	COLOURED GLASS	ETCHED COLOURED GLASS
CHALK WHITE	•	•	•	•
IVORY	•			
PEARL	•	•	•	•
SILICA	•	•	•	•
SAND	•	•	•	•
PLATINUM	•	•	•	•
DUNE	•	•	•	•
CLAY	•	•	•	•
DOLOMITE GREY	•	•	•	•
BORDEAUX	•	•	•	•
MOKA	•	•	•	•
ORANGE	•	•	•	•
MUSTARD	•	•	•	•
CARAMEL	•	•	•	•
LIGHT BLUE GREY	•	•	•	•
AQUAMARINE	•	•	•	•
VENETIAN RED	•	•	•	•
LEAD	•	•	•	•
ANTHRACITE	•	•	•	•
BLACK	•	•	•	•
LESSLESS RED	•			
	only matt lacquer			

FINISHES

WOODS

EUCALYPTUS

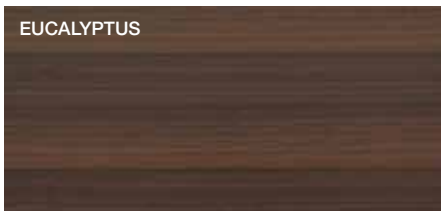

AMERICAN WALNUT

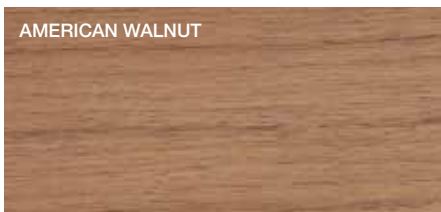

GREY OAK



BLACK OAK

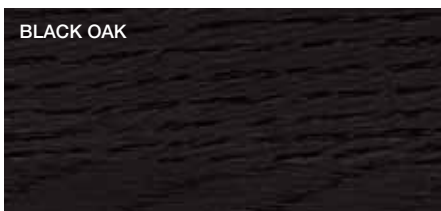

DARK ELM



LIGHT ELM

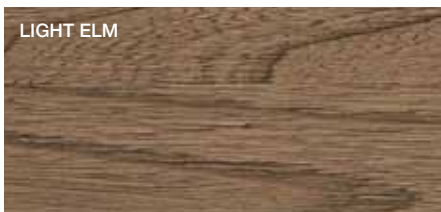

CEDAR



MARBLES

WHITE CARRARA MARBLE



CALACATTA MARBLE



RED FRENCH MARBLE



EMPERADOR DARK MARBLE



CARNIAN GREY MARBLE

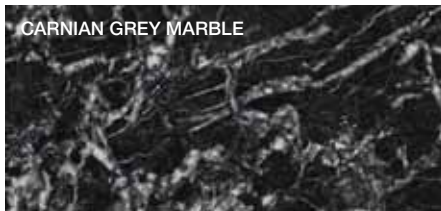

ABSOLUTE BLACK GRANITE



GRES

WHITE GRES

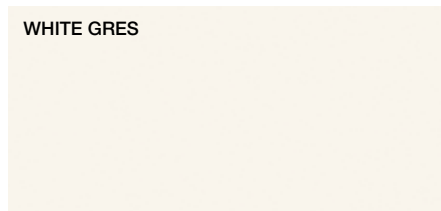

ANTHRACITE GRES

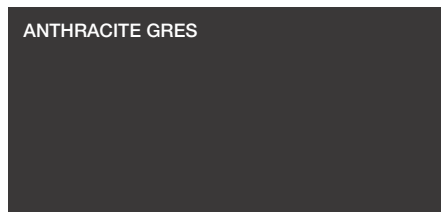

METAL PARTS

BLACK CHROME



SHINY ALUMINIUM

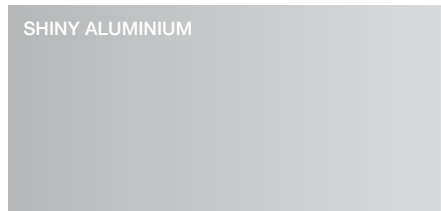

PEWTER COLOUR

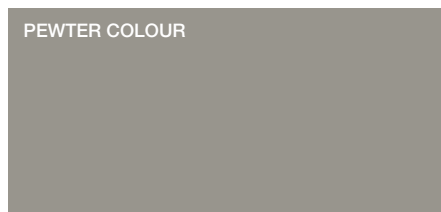

MILLERIGHE
GLISS QUICK FRONT



MILLERIGHE
GLISS QUICK, GLISS 5TH STRUCTURE



DWELL
DOOR FRAME, TRACK COVERING PROFILES

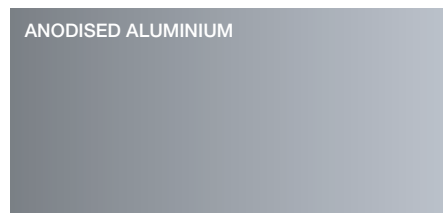

CARTAPAGLIA
GLISS QUICK, GLISS WALK-IN FRONT

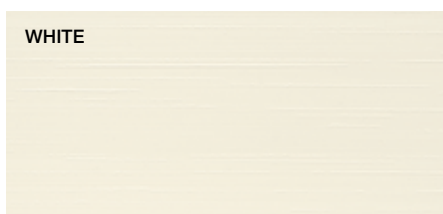

Millerighe dark finish available also for Gliss Walk-In where specifically indicated in the pricelist