



© COPYRIGHT 2016 MDF ITALIA SPA CON SOCIO UNICO

2016

LINK 1 - LINK 2

Designed by Bruno Fattorini

Link 1 Shelf and Link 2 bench, is associated with the evolution of current design concept, that goes beyond the traditional vision of pure aesthetic dimension, to be a polyhedral object in which function, simplicity, innovation and project culture are merged.

Link1 and Link 2 is a simple and pure sign capable of conversing with different shapes and of aggregating fairly with different products.

A "universal" line, useful for every need, conceived to give birth either to endless compositions or end-use opportunities, with a considerable capability of adapting to space and the possibility of changing over time.

TOP

Top made from MD wood fiberboards, coated with:

- white acrylic resin;
- wood
- reconstituted stone
- brass sheet

STRUCTURE

- Shelf: with bearing bracket made from steel powder-coated in matt black. Adjustable inclination with special soft perimeter profile, that enables an easy and perfect installation (to make up for the various irregularities of wall structures);

- Bench: with bearing frame in steel, powder-coated in matt black. Equipped with adjustable feet mechanism.

*maximum capacity of 20 kg/ml for the shelf.

Finishing

SHELF AND BENCH

Structure



Wood



Brass



Reconstructed stone

LINK 1 - SHELF



dimensions

L180 P48 H6 (top thickness)

L210 P48 H6

L240 P48 H6

L270 P48 H6

L300 P48 H6

**also available in electrified version,
with cable management door and back interspace
to make cables pass and be hidden.**

LINK 2 - BENCH

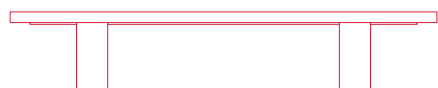

dimensions

L240 P48 H45

H6 (top thickness)

**Only the "bench" typology is completely
finished on four sides and can be used
in the middle of the room.**