

GRID — VINCENT VAN DUYSSEN 2018

1—
20



Grid is a new research chapter in what are known today as modular wall-systems. Research into the evolution of domestic space, also thanks to the presence of electronic devices that extend the perception of space. Grid is a modular system characterized by a wall-anchored folding panel system, inside which, on request, LED lighting can be installed, both in the central part and at the top, all the way down, along with various connections linked to sounds and images and hi-tech equipment. The aim is to achieve a flexible open system based on a modular grid, which organizes the component parts and exalts their function. As in a crossword, hooked to the boiserie, the wall at the bottom part can be accessorized with containers, either hanging or on the floor and fitted with thick shelves or with trays lined at the bottom with Ecoskin. Grid's compositional freedom is further extended at the top by open bookshelves, display units of varying heights, with either Pewter or Copper metallic finishes, for precious ornaments, pictures or mementos. The compositional system is open-ended and can be expanded by using different finishes, to be mixed and matched at will.

DATASHEET

REGISTERED
DESIGN

IX.2020

FINISHES

finishes	matt lacquer colours	woods	glossy lacquer colours	transparent glass	transparent stopsol glass	pewter colour / copper / zinc	Eco Skin	bonded hide leather	bronze mirror
components									
WALL PANELLING									
panel									
SUPPORT SHELF									
shelf									
TRAY									
shelf									
accessory bottom									
CONTAINER UNDER SUPPORT SHELF OR TRAY									
structure / internal partition									
flap door / drawer front									
BOOKCASE									
shelf									
back									
partitions									
WALL UNIT									
tops th 30 mm									
back / central shelf / central partition									
glass door and glass partition	profile								
	glass								
GLASS CABINETS									
wooden back /									
side	profile								
	glass								
glass side / hinged door									
shelves / base / lid									
SHOWCASE									
structure / support									
CHARGING ACCESSORY									
structure									

colours

Matt lacquer

BC chalk white
PE pearl
DN dune
PL platinum
NE black
AT anthracite
SE mustard
SI silica
DO dolomite grey
AL clay
MK moka
CZ light blue grey
SA sand
RU ruby
PX pewter colour
RX copper
TO dove grey
PR petroleum blue
BG burgundy

Glossy lacquer

BC chalk white
PE pearl
DN dune
PL platinum
NE black
AT anthracite
SE mustard
SI silica
DO dolomite grey
AL clay
MK moka
CZ light blue grey
SA sand
RU ruby
PX pewter colour
RX copper
TO dove grey
PR petroleum blue
BG burgundy

Woods

EU eucalyptus
NO walnut
RF graphite oak

Molteni & C

2—
20

DATASHEET

REGISTERED
DESIGN

IX.2020

moltenigroup.com

Dimensions in millimeters and inches. The right to discontinue and make changes is reserved. This information is based on the latest product information available at the time of printing.

TECHNICAL INFORMATION

WALL PANELLING

Wood particle board panelling covered with sliced veneer in Oak (Quercus), Eucalyptus (Eucalyptus globulus), Walnut (Juglans Nigra) or melamine finish, painted in the colors from the “Molteni Range”.

Wall mounting profile in extruded anodized aluminum.

Mirror version with chipboard panel with melamine facing on which the silvered bronze tempered crystal is positioned, thickness 5 mm.

GUIDE FOR ANCHORING SHELVES AND CENTRAL PROFILE

Extruded anodized aluminum.

SUPPORT SHELF

Wood particle board panel covered with sliced veneer in Oak, Eucalyptus, Walnut or melamine finish, painted in the colors from the “Molteni Range”.

Fastening elements in laser-cut and painted sheet metal.

Undertop track (optional) in extruded anodized aluminum.

TRAY

Wood particle board panel covered with sliced veneer in Oak, Eucalyptus, Walnut or melamine finish, painted in the colors from the “Molteni Range”.

HANGING OR FREE STANDING CONTAINERS

Wood particle board panel covered with sliced veneer in Oak, Eucalyptus, Walnut or melamine finish, painted in the colors from the “Molteni Range”.

Fastening elements for suspended containers in laser cut and painted sheet metal.

The floor storage units are equipped with adjustable support feet.

SIDES AND DRAWER BOTTOMS

Wood particle board paneling covered with melamine finish.

BOOKCASE

Wood particle board panel covered with sliced veneer in Oak, Eucalyptus, Walnut or melamine finish, painted in the colors from the “Molteni Range”.

Fastening elements in painted metal.

BOOKSHELVES PARTITION

Bent sheet metal covered with bonded hide leather.

SHOWCASE

Wood particle board paneling covered with melamine finish, painted in the colors from the “Molteni Range” or with applied silver bronze glass, thickness 4 mm. Perimeter profile in painted aluminum.

GLASS CABINET / WALL UNIT WITH DOORS - WOODEN PARTS

Wood particle board panel covered with sliced veneer in Oak, Eucalyptus, Walnut or melamine finish, painted in the colors from the “Molteni Range”.

Fastening elements in painted metal.

GLASS CABINET / WALL UNIT WITH DOORS - PARTS IN GLASS AND SHELVES (FOR GLASS CABINET)

Extruded or painted aluminum. Tempered crystal, thickness 4 mm.

Glass cabinet shelves in bent, painted plating.

LIGHTING AND ELECTRICAL COMPONENTS

All components are compliant with regulations and certified as shown on the individual parts.

DATASHEET

REGISTERED
DESIGN

IX.2020

TECHNICAL INFORMATION

Molteni & C

4—
20

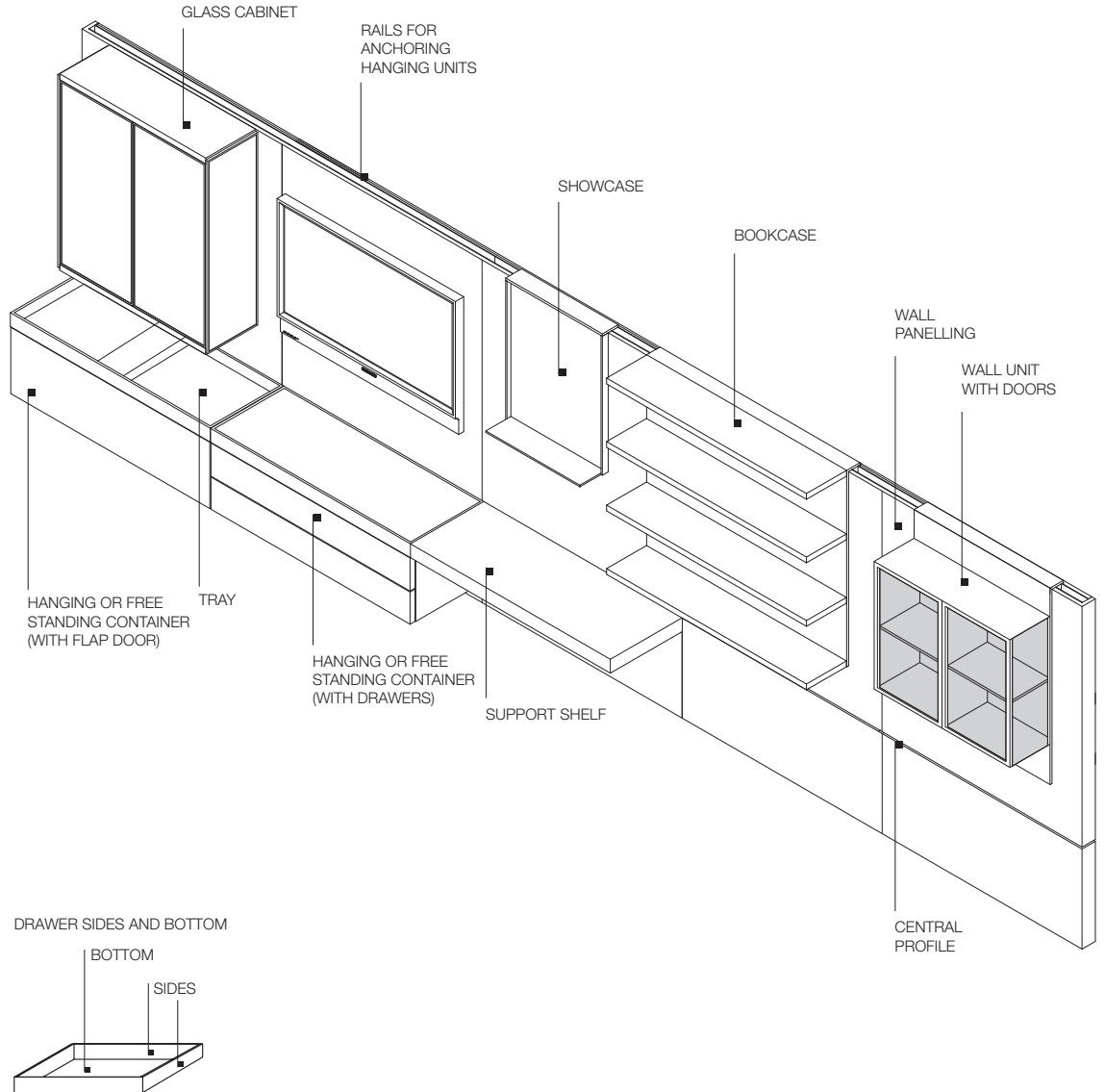

DATASHEET

REGISTERED
DESIGN

IX.2020

NOTES

- Corner compositions may be created by putting two straight compositions together.
- The support shelf may be made of a single piece up to 3000 mm.
- Hanging or standing containers must be positioned under the support shelf or must be equipped with a top tray.
- The composition may be lit in the central part, in the upper part, or both.
- The glass cabinet and the bookcase can be equipped with a lighting system that is independent from the one in the panelling.
- Consider a space of 15 mm in width to mount the panels.

Example of a composition

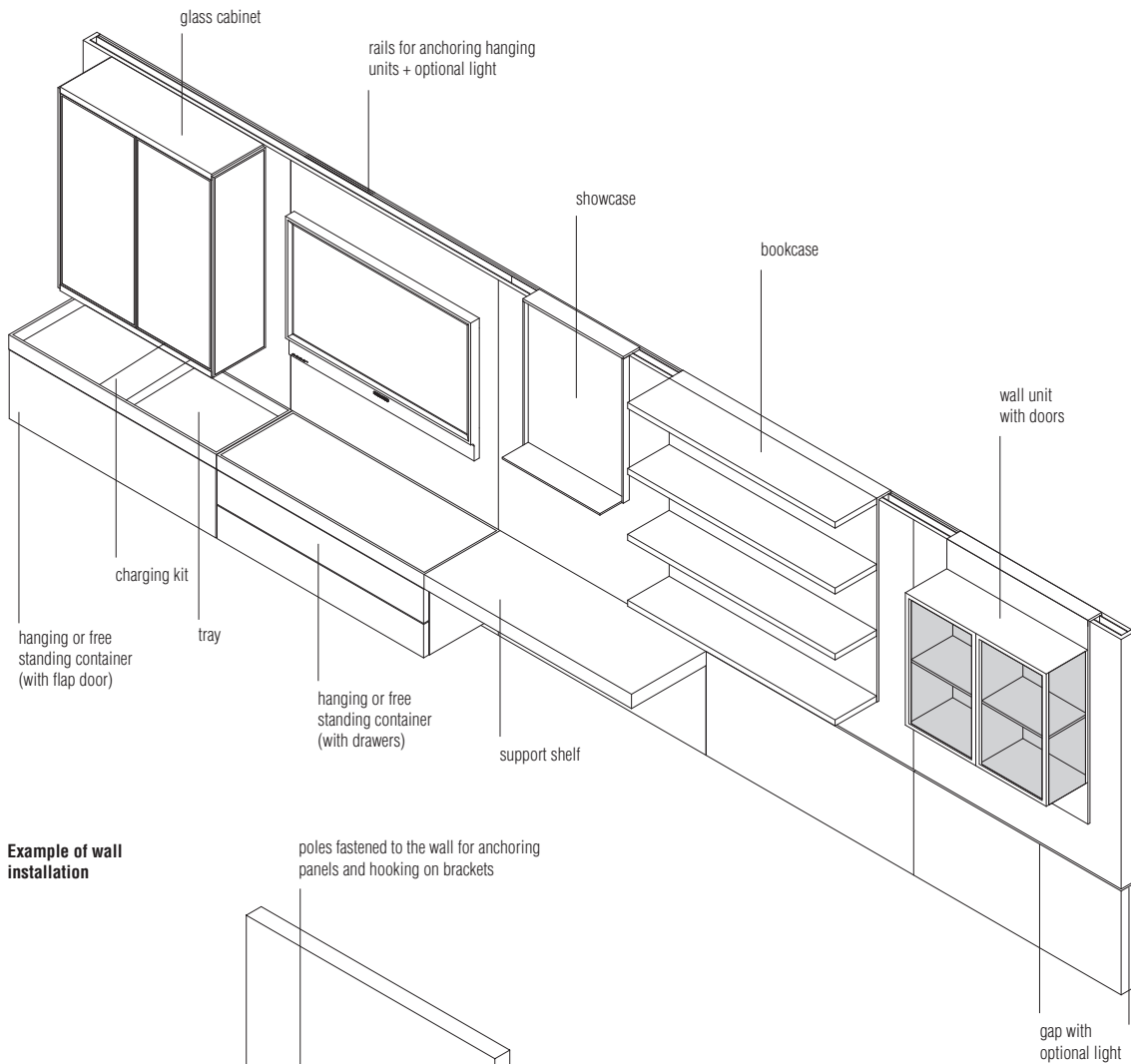

Example of wall installation

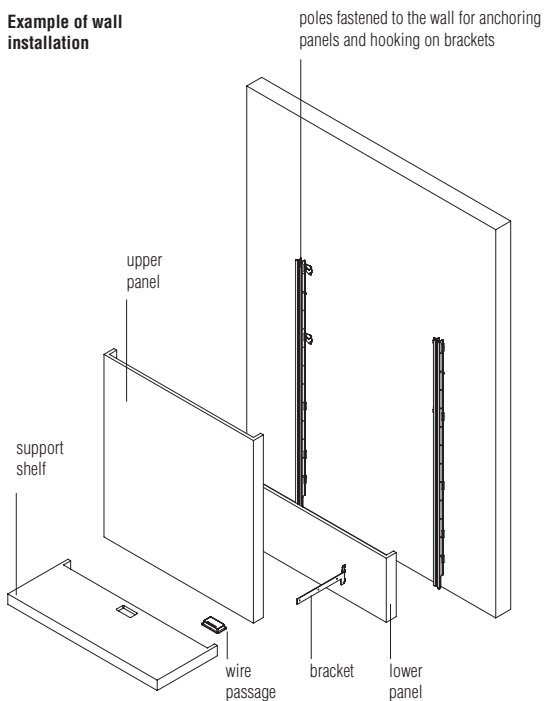

DATASHEET

REGISTERED
DESIGN

IX.2020

MODULARITY

Modularity of individual panelling

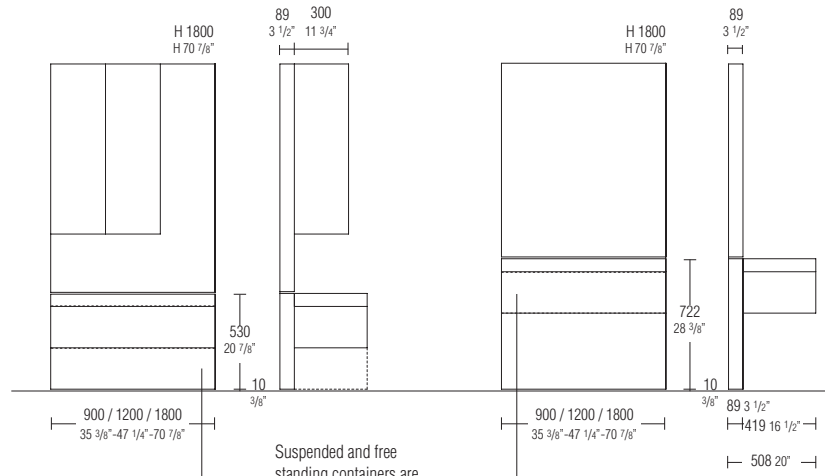

Modularity of modular panelling

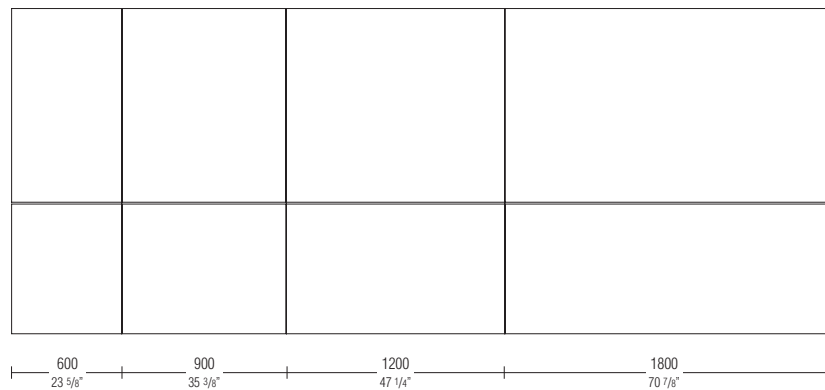
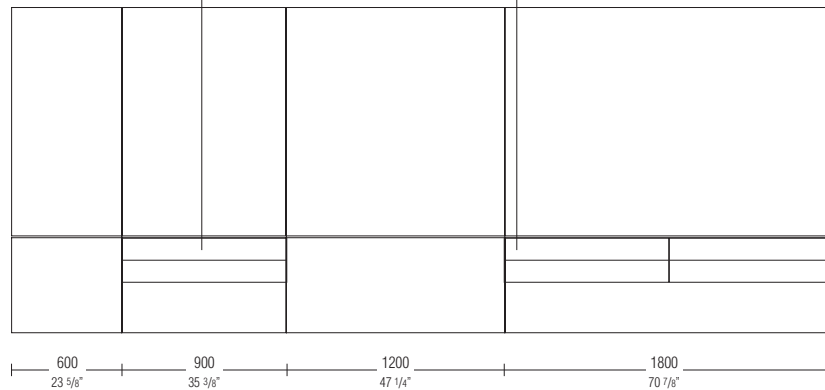

Molteni & C

6—
20

DATASHEET

REGISTERED
DESIGN

IX.2020

moltenigroup.com

Dimensions in millimeters and inches. The right to discontinue and make changes is reserved. This information is based on the latest product information available at the time of printing.

EXAMPLE OF WIRE PASSAGE

Molteni & C

7—
20

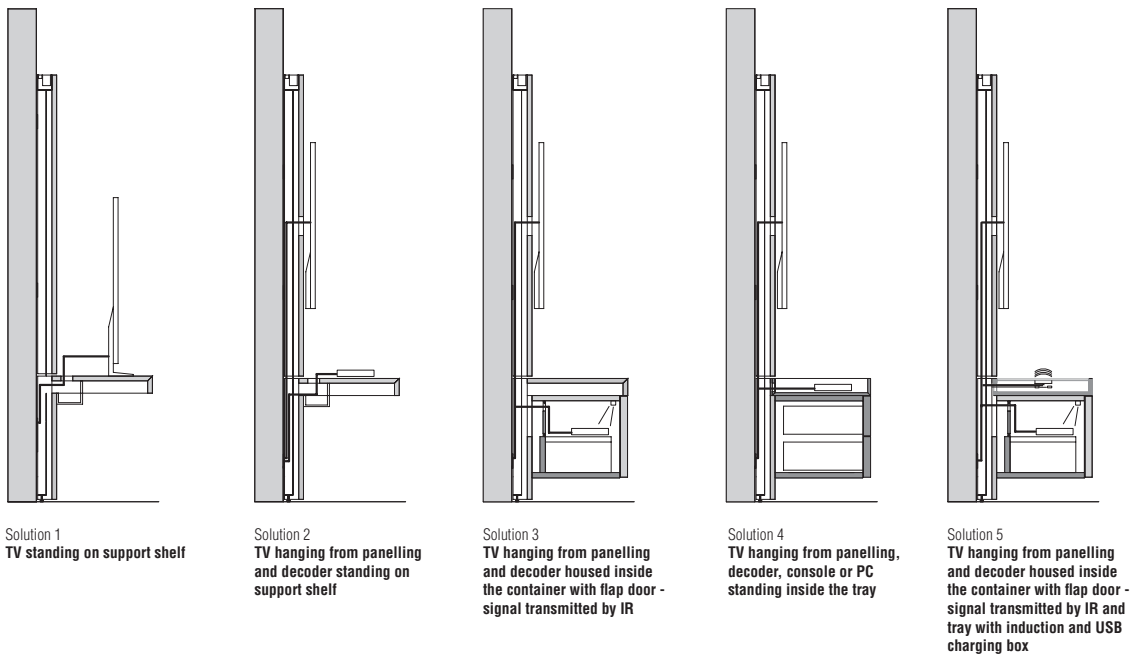
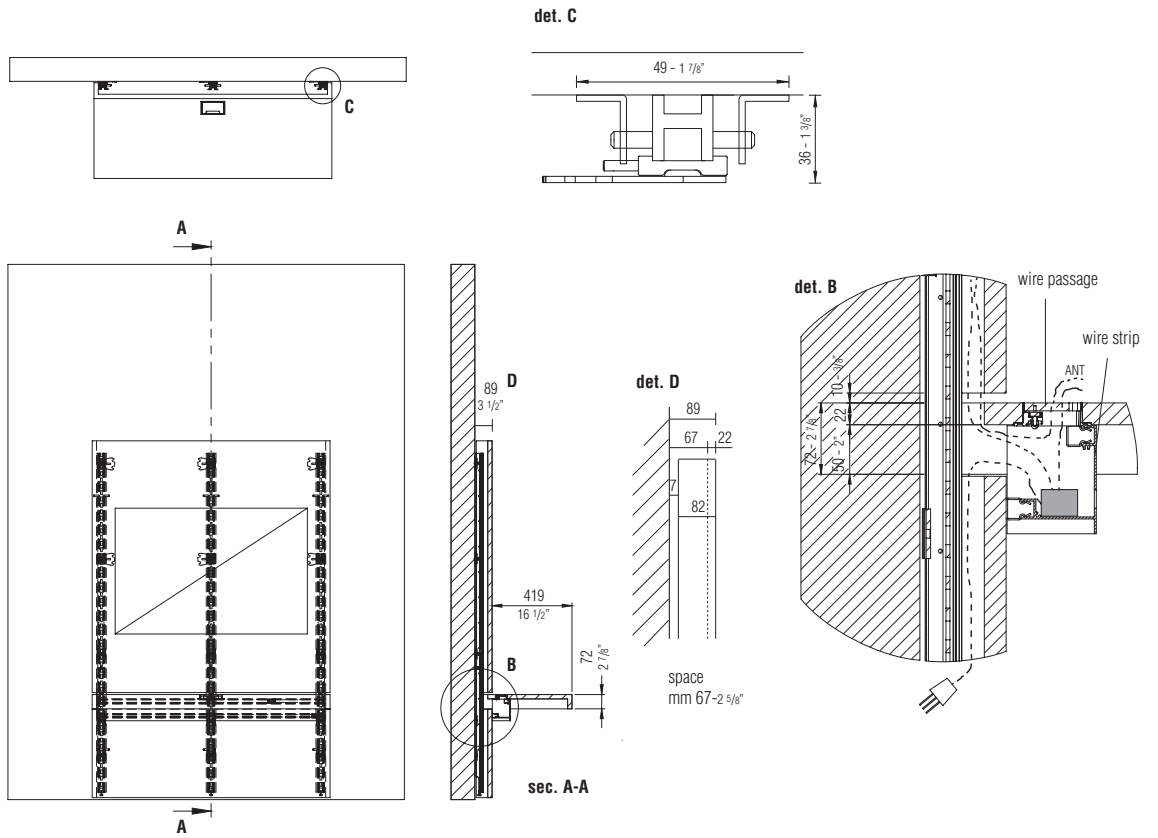

DATASHEET

REGISTERED
DESIGN

IX.2020

DIMENSIONS

Individual panelling D 82 (89 from the wall)
H1 from the ground 540 / 732
Total H from the ground 1800

The panels can be reduced in width considering a surcharge (per module).
 Consider a space of 15 mm in width to mount the panels.

All panelling is equipped to receive hanging elements in the upper part

panelling

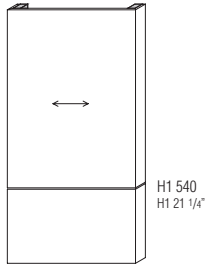

W 900 W 1200 W 1800
PIC09/18A PIC12/18A PIC18/18A

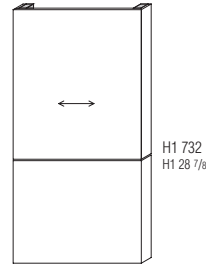

W 900 W 1200 W 1800
PIS09/18A PIS12/18A PIS18/18A

panelling for support shelf

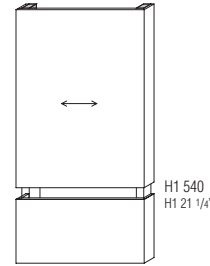

W 900 W 1200 W 1800
PIC09/18B PIC12/18B PIC18/18B

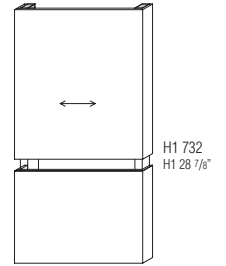

W 900 W 1200 W 1800
PIS09/18B PIS12/18B PIS18/18B

Molteni & C

8—
20

All panelling is equipped to receive hanging elements in the upper part

panelling for hanging container and free-standing container with tray or support shelf

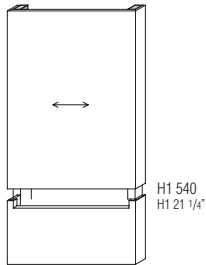

W 900 W 1200 W 1800
PIC09/18C PIC12/18C PIC18/18C

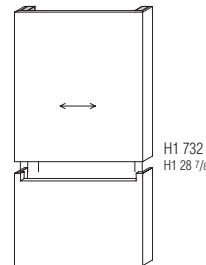

W 900 W 1200 W 1800
PIS09/18C PIS12/18C PIS18/18C

work for TV cable passage (to be requested on the order form)

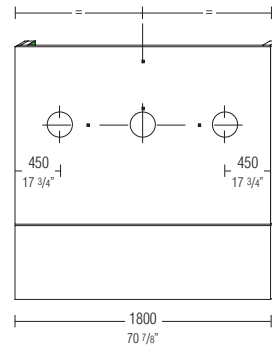
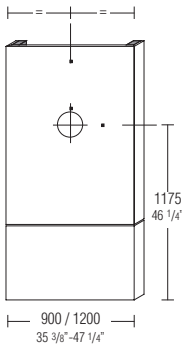

DATASHEET

REGISTERED
DESIGN

IX.2020

DIMENSIONS

Modular panelling D 82 (89 from the wall)
H1 from the ground 540
Total H from the ground 1800

The panels can be reduced in width considering a surcharge (per module).
Mirror-finished panels cannot be fitted with wire passages and TV sets cannot be fastened to them.
Consider a space of 15 mm in width to mount the panels.

All panelling is equipped to receive hanging elements in the upper part

left-sx panelling

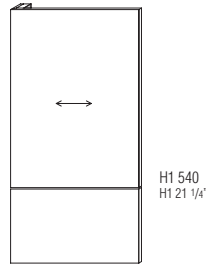

W 600 W 900 W 1200 W 1800
PSC06/18A PSC09/18A PSC12/18A PSC18/18A

left-sx panelling for support shelf

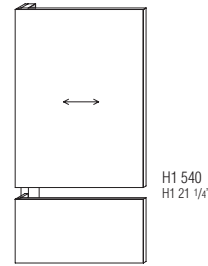

W 600 W 900 W 1200 W 1800
PSC06/18B PSC09/18B PSC12/18B PSC18/18B

left-sx panelling for hanging container and free-standing container with tray or support shelf

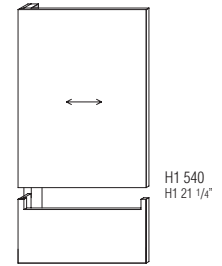

W 600 W 900 W 1200 W 1800
PSC06/18C PSC09/18C PSC12/18C PSC18/18C

All panelling is equipped to receive hanging elements in the upper part

central panelling

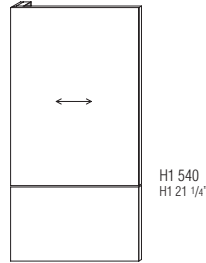

W 600 W 900 W 1200 W 1800
PCC06/18A PCC09/18A PCC12/18A PCC18/18A

central panelling for support shelf

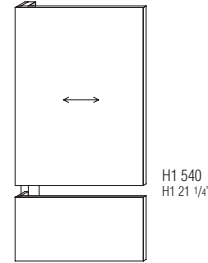

W 600 W 900 W 1200 W 1800
PCC06/18B PCC09/18B PCC12/18B PCC18/18B

central panelling for hanging container and free-standing container with tray or support shelf

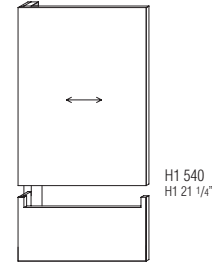

W 600 W 900 W 1200 W 1800
PCC06/18C PCC09/18C PCC12/18C PCC18/18C

All panelling is equipped to receive hanging elements in the upper part

right-dx end panelling

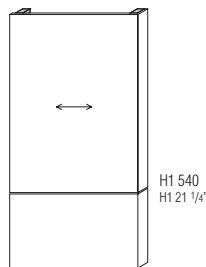

W 600 W 900 W 1200 W 1800
PDC06/18A PDC09/18A PDC12/18A PDC18/18A

right-dx end panelling for support shelf

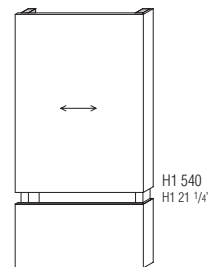

W 600 W 900 W 1200 W 1800
PDC06/18B PDC09/18B PDC12/18B PDC18/18B

right-dx end panelling for hanging container and free-standing container with tray or support shelf

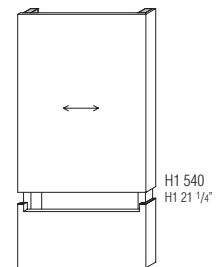

W 600 W 900 W 1200 W 1800
PDC06/18C PDC09/18C PDC12/18C PDC18/18C

Molteni & C

9—
20

DATASHEET

REGISTERED
DESIGN

IX.2020

moltenigroup.com

Dimensions in millimeters and inches. The right to discontinue and make changes is reserved. This information is based on the latest product information available at the time of printing.

DIMENSIONS

Modular panelling D 82 (89 from the wall)
H1 from the ground 732
Total H from the ground 1800

The panels can be reduced in width considering a surcharge (per module).
 Mirror-finished panels cannot be fitted with wire passages and TV sets cannot be fastened to them.
 Consider a space of 15 mm in width to mount the panels.

All panelling is equipped to receive hanging elements in the upper part

left-sx panelling

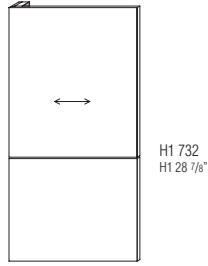

W 600 W 900 W 1200 W 1800
PSS06/18A PSS09/18A PSS12/18A PSS18/18A

left-sx panelling for support shelf

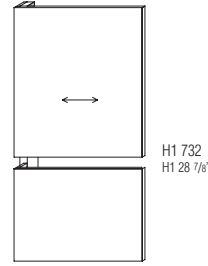

W 600 W 900 W 1200 W 1800
PSS06/18B PSS09/18B PSS12/18B PSS18/18B

left-sx panelling for hanging container with tray or support shelf

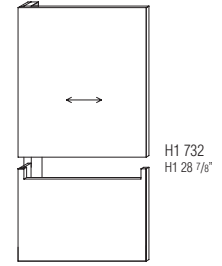

W 600 W 900 W 1200 W 1800
PSS06/18C PSS09/18C PSS12/18C PSS18/18C

All panelling is equipped to receive hanging elements in the upper part

central panelling

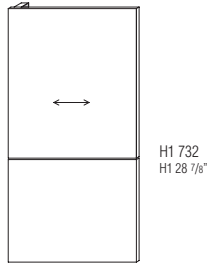

W 600 W 900 W 1200 W 1800
PCS06/18A PCS09/18A PCS12/18A PCS18/18A

central panelling for support shelf

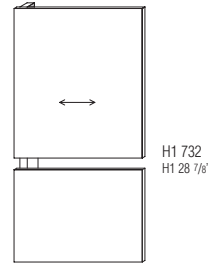

W 600 W 900 W 1200 W 1800
PCS06/18B PCS09/18B PCS12/18B PCS18/18B

central panelling for hanging container with tray or support shelf

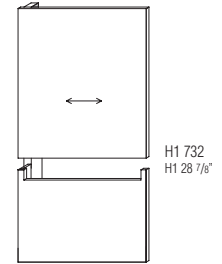

W 600 W 900 W 1200 W 1800
PCS06/18C PCS09/18C PCS12/18C PCS18/18C

All panelling is equipped to receive hanging elements in the upper part

right-dx end panelling

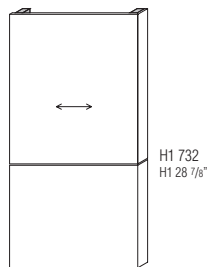

W 600 W 900 W 1200 W 1800
PDS06/18A PDS09/18A PDS12/18A PDS18/18A

right-dx end panelling for support shelf

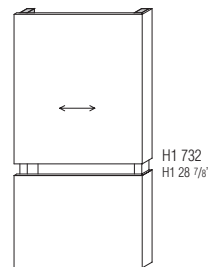

W 600 W 900 W 1200 W 1800
PDS06/18B PDS09/18B PDS12/18B PDS18/18B

right-dx end panelling for hanging container with tray or support shelf

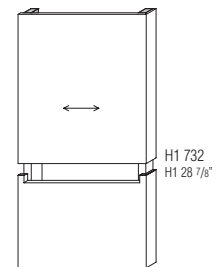

W 600 W 900 W 1200 W 1800
PDS06/18C PDS09/18C PDS12/18C PDS18/18C

Molteni & C

10—
20

DATASHEET

REGISTERED
DESIGN

IX.2020

moltenigroup.com

Dimensions in millimeters and inches. The right to discontinue and make changes is reserved. This information is based on the latest product information available at the time of printing.

DIMENSIONS

Wall panelling lighting

It is possible to light the panelling by inserting LED bars, along the entire length of the composition, in the top part, in the central part, or both.

It is possible to connect the system to a socket with switch, or to use a radio control kit (optional).

Molteni & C

11—
20

**LED bars 8W per metre
max length 3000 mm**
for calculations, consider the sum
of all modules
(3000° K)



per linear meter
EBIML

**power supply
unit 100W**

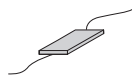

EAL1

**connector
for power supply
units**



EC01

**radio control kit
with brightness
setting
(1 per power supply
unit)
optional**



EKRR1

**DALI kit
(for DOMOTICA)**
n. 1 for each
power supply unit
cannot be used with
radio remote control

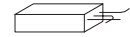

EKDA1

Example of lit wall

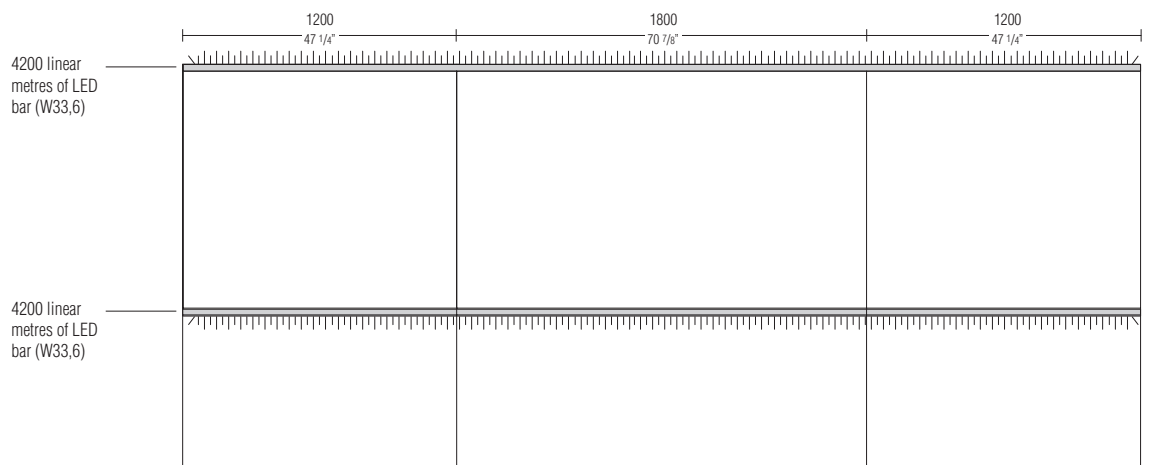

n° 1 power supply unit **EAL1**
n° 1 connector **EC01**
n° 1 radio control kit **EKRR1**

DATASHEET

REGISTERED
DESIGN

IX.2020

DIMENSIONS

Support shelf D 419 H 72

Supporting shelves can be reduced in width considering a surcharge each.

The support shelf is always equipped with the side brackets, while the central brackets must be added according to the modularity of the composition.

Molteni & C

12—
20

support shelf

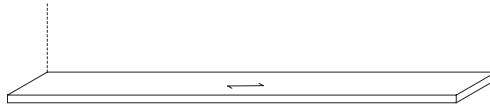

W 600	W 900	W 1200	W 1500	W 1800	W 2100	W 2400	W 2700	W 3000
MAP4/06	MAP4/09	MAP4/12	MAP4/15	MAP4/18	MAP4/21	MAP4/24	MAP4/27	MAP4/30

detachable track underneath the support shelf

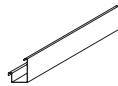

W 900	W 1200	W 1800
MCS09	MCS12	MCS18

central bracket for support shelf



ST4

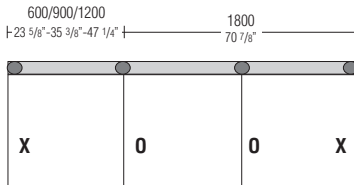

X = included in the price

O = to be added

wire passage for support shelf W 112 D 57



EPA3

Positioning wire passage on the support shelf

The cable gland on the supporting shelf can be positioned in relation to the modules as shown in the specified drawings

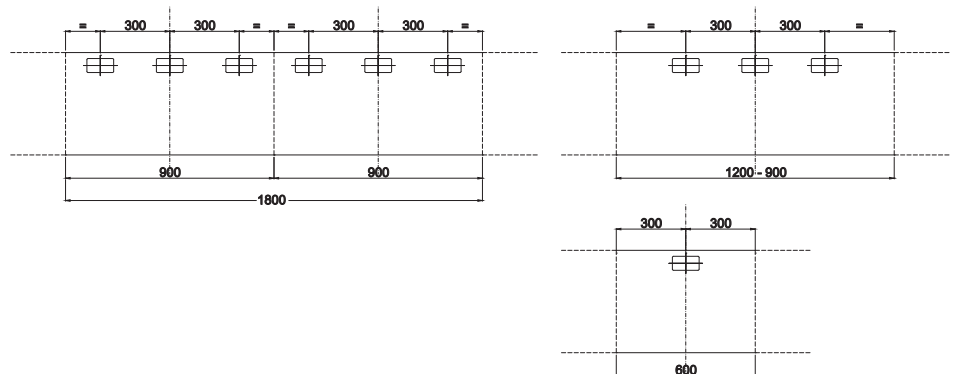

DATASHEET

REGISTERED
DESIGN

IX.2020

DIMENSIONS

Tray
D 419 H 72

Reductions
No reductions possible

Always to be used resting
on suspended or
free-standing containers

tray
W 600

W 900

W 1200

Molteni & C

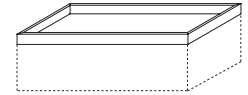
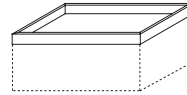
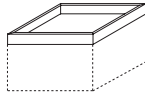

VA4/06

VA4/09

VA4/12

13—
20

finishes:
ivory
dark brown
grey
mink

bottoms in Eco Skin
for trays W 600

for trays W 900

for trays W 1200



VE4/06

VE4/09

VE4/12

Including the cost
of adding the wire passage
to the tray

charging module
W 150 D 407 H 56
a) Qi inside wireless recharge
b) 2 USB recharge plugs

wire passage
on the tray
W 112 D 57

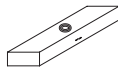

EMR1



EPA5

**tray wire passage position and
charge module position**

W 600

W 900

W 1200

central

central

central

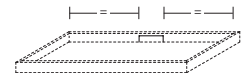
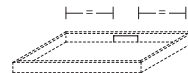
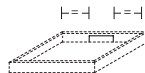

right/left

right/left

right/left

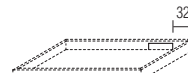
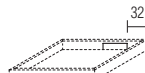

right version

right version

right version

DATASHEET

REGISTERED
DESIGN

IX.2020

DIMENSIONS

Hanging container D 419 H 347

Containers with flap door can be equipped with a wire passage, which must be indicated in the order phase.
The inside is clear of the "T" shelf (optional).

Reductions

No reductions possible

Molteni & C

Always to be used under
the support shelf or with
top tray

Including fastening
brackets

W 600 with pressure-opening flap door

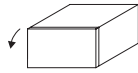

matt lacquer
structure wood
structure
CQSR06/34

W 900

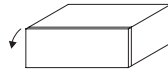

matt lacquer
structure wood
structure
CQSR09/34

W 1200

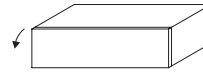

matt lacquer
structure wood
structure
CQSR12/34

W 1800 (W 900 + W 900)

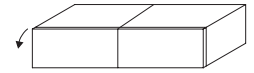

matt lacquer
structure wood
structure
CQSR18/34

Always to be used under
the support shelf or with
top tray

Including fastening
brackets

W 600 with drawers

usable space
W 513 D 326 H 83

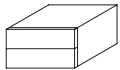

matt lacquer
structure wood
structure
CQSC06/34

W 900

usable space
W 813 D 326 H 83



matt lacquer
structure wood
structure
CQSC09/34

W 1200

usable space
W 1113 D 326 H 83

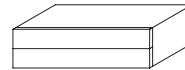

matt lacquer
structure wood
structure
CQSC12/34

W 1800 (W 900 + W 900)

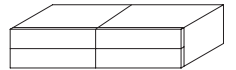

matt lacquer
structure wood
structure
CQSC18/34

additional "T" shelf H 151 for flap door containers

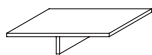

W 600 W 900 W 1200
RQT06 RQT09/15 RQT12/15

TV signal transmitting/receiving system with LED light for containers with flap door (transmission frequency from 30 to 38 KHz)

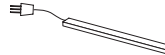

ETV1

DATASHEET

REGISTERED
DESIGN

IX.2020

DIMENSIONS

Free-standing container D 419 H 445

Always to be used under the support shelf or with top tray.
Containers with flap door can be equipped with a wire passage, which must be indicated in the order phase. The inside is clear of the "T" shelf (optional).

Reductions

No reductions possible

Molteni & C

Always to be used under the support shelf or with top tray

W 600 with pressure-opening flap door

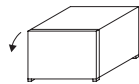

matt lacquer structure wood structure
CQTR06/44

W 900

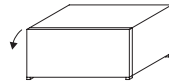

matt lacquer structure wood structure
CQTR09/44

W 1200

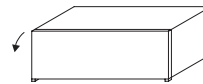

matt lacquer structure wood structure
CQTR12/44

W 1800 (W 900 + W 900)

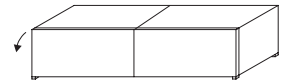

matt lacquer structure wood structure
CQTR18/44

15—
20

Always to be used under the support shelf or with top tray

W 600 with drawers

usable space
W 513 D 326 H 83/196

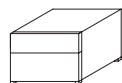

matt lacquer structure wood structure
CQTC06/44

W 900

usable space
W 813 D 326 H 83/196

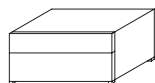

matt lacquer structure wood structure
CQTC09/44

W 1200

usable space
W 1113 D 326 H 83/196



matt lacquer structure wood structure
CQTC12/44

W 1800 (W 900 + W 900)



matt lacquer structure wood structure
CQTC18/44

additional "T" shelf H 248 for flap door containers



W 600 W 900 W 1200
RQT06 RQT09/25 RQT12/25

TV signal transmitting/receiving system with LED light for containers with flap door (transmission frequency from 30 to 38 KHz)

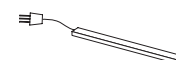

ETV1

DATASHEET

REGISTERED
DESIGN

IX.2020

DIMENSIONS

Wall unit open or with doors

The elements can be hung from the panelling as shown in the composition diagrams, using open wall units with the addition of sides panels and glass doors. To make up wall units with LED spotlights, consider_ kit with 4 spotlights, power supply unit and, if no provision has been made for a controlled socket, the radio control kit. The lighting system for wall units is separate from that for the panelling, but can be included in that for bookcases and glass cabinets, if these do not exceed 100W. LED light 3000°K.

No reductions or changes of any kind are available. The glass sides must only be used when a door is included.

Composition diagrams

Open

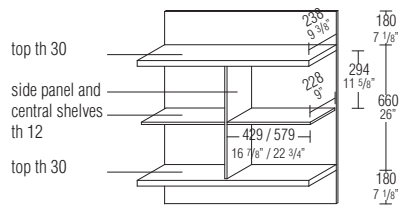

With 1 door (right-dx or left-sx)

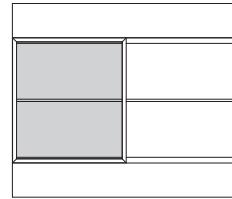

With 2 doors

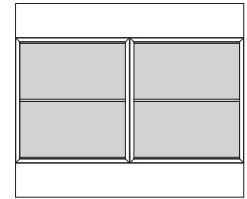

left-sx version

Molteni & C

16—
20

open wall units D 252 H 1020

W 900

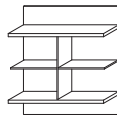

tops, side and central shelves
matt lacquered

tops, side and central shelves
in wood

GPS09/10

W 1200

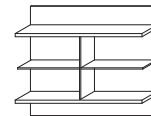

tops, side and central shelves
matt lacquered

tops, side and central shelves
in wood

GPS12/10

glass door W 448 H 658 th 25



GABV04/06

glass door W 598 H 658 th 25



GABV06/06

glass side panel H 600 D 238 th 10



GSV2/06

kit of 4 spotlights W5

EFK4

power supply unit 100W

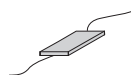

EAL1

radio control kit with brightness setting (1 per power supply unit) optional



EKRR1

connector for power supply units

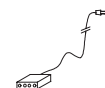

EC01

DATASHEET

REGISTERED
DESIGN

IX.2020

DIMENSIONS

Bookcase D 252

- To create bookcases with LED lighting consider: LED increase, power supply unit and, if there is no pre-fitted element for the switched socket, also the remote control kit.

- The bookcase lighting system is separate from the one for the panelling, but it can be integrated with the one for the glass cabinets if they do not exceed 100W.
- The lighting system includes LEDs on all shelves in the bookcase, excepted the lower shelf.
- 3000° K LED light

Reductions

No reductions possible

Molteni & C

17—
20

H 690 3 shelves

W 450
8 watt

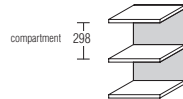

matt lacquer
back
LDS04/07

W 600
10 watt

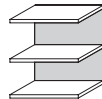

matt lacquer
back
LDS06/07

W 900
15 watt

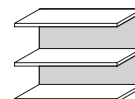

matt lacquer
back
LDS09/07

W 1200
20 watt

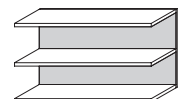

matt lacquer
back
LDS12/07

H 1020 4 shelves

W 450
12 watt

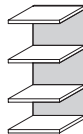

matt lacquer
back
LDS04/10

W 600
15 watt

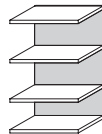

matt lacquer
back
LDS06/10

W 900
22,5 watt

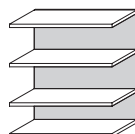

matt lacquer
back
LDS09/10

W 1200
30 watt

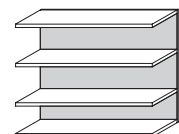

matt lacquer
back
LDS12/10

finishes:
ivory
dark brown
dove grey
black
natural
mud green

Bookcase accessories

partition
W 300 H 298 D 238



DVL03

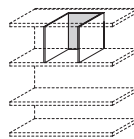

power supply
unit 100W

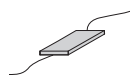

EAL1

radio control kit
with brightness setting
(1 per power supply unit)
optional



EKRR1

connector
for power supply
units



EC01

DATASHEET

REGISTERED
DESIGN

IX.2020

moltenigroup.com

Dimensions in millimeters and inches. The right to discontinue and make changes is reserved. This information is based on the latest product information available at the time of printing.

DIMENSIONS

Showcase
D 150

Reductions
No reductions possible

**Max capacity of the shelf 5 kg
evenly distributed**

H 580
W 580



EDS05/05

Molteni & C

18—
20

H 686
W 580

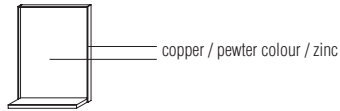

EDS05/06

Showcase
with mirror

H 1016
W 580

In the order, specify the finish
of the perimeter profile and
shelf (pewter colour /
copper / zinc lacquer)

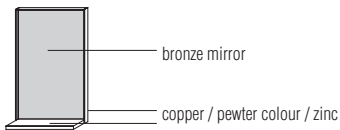

EDS05/10

DATASHEET

REGISTERED
DESIGN

IX.2020

DIMENSIONS

Glass cabinet D 300 Glass side

- Pewter colour / copper / zinc painted profile.
- Transparent stopsol glass.
- Optional interior lighting.
- To create glass cabinets with LED lighting consider: LED increase, power supply unit and, if there is no pre-fitted element for the switched socket, also the remote control kit.

- The glass cabinet lighting system is separate from the one for the panelling, but it can be integrated with the one for the bookcases if they do not exceed 100W.
- Provision is made to position the LED bar in the lid.
- 3000° K LED light.

Reductions

No reductions possible

Molteni & C

19—
20

H 1020
W 600
5 watt
opening only right

inside layout

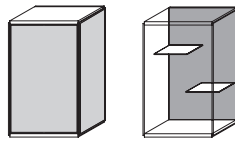

pewter colour/copper/zinc
lacquered back
VTSV06/10

W 900
7,5 watt

inside layout

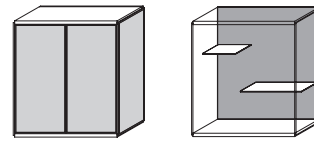

pewter colour/copper/zinc
lacquered back
VTSV09/10

**power supply
unit 100W**

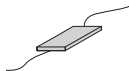

EAL1

**radio control kit
with brightness setting
(1 per power supply unit)
optional**



EKRR1

**connector
for power supply
units**

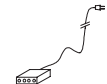

ECO1

DATASHEET

REGISTERED
DESIGN

IX.2020

DIMENSIONS

Glass cabinet D 300 Glass side

- Pewter colour / copper / zinc painted profile.
- Transparent stopsol glass.
- It is not possible to insert LED lighting.

Reductions

No reductions possible

with n° 2
internal shelves

H 1020
W 600

W 900

opening only right

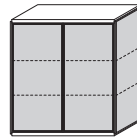
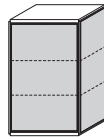

pewter colour/copper/zinc
lacquered back
VTSW06/10

pewter colour/copper/zinc
lacquered back
VTSW09/10

Glass cabinet D 300 Pewter colour / copper matt lacquered side

- Door pewter colour / copper / zinc painted profile.
- Transparent stopsol glass.
- It is not possible to insert LED lighting.

Reductions

No reductions possible

with n° 2
internal shelves

H 1020
W 600

W 900

opening only right

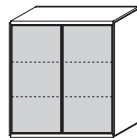
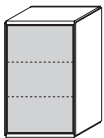

pewter colour/copper/zinc
lacquered back

pewter colour/copper/zinc
lacquered back