

Molteni & C

GRID — VINCENT VAN DUYSSEN 2018

1—
19



Grid is a modular wall system characterized by a panelling which can be equipped and which makes it possible to create solutions for living rooms, studies or bedrooms, making use of freely positionable elements. The added value of this modern boiserie is that it replaces the wall in the need to hook on containers, shelves, glass cabinets and other accessories, hiding all the wires for the various Hi-Fi and lighting systems.

DATASHEET

REGISTERED
DESIGN

IX.2018

FINISHES

finishes		matt lacquer colours	woods	glossy lacquer colours	transparent stopsol glass	pewter colour / copper	Eco Skin	bonded hide leather
components								
WALL PANELLING								
panel		■	■					
SUPPORT SHELF								
shelf		■	■					
TRAY								
shelf		■	■					
accessory bottom							■	
CONTAINER UNDER SUPPORT SHELF OR TRAY								
structure / internal partition		■	■					
flap door / drawer front		■	■	■				
BOOKCASE								
shelf		■	■					
back		■						
partitions								■
GLASS CABINETS								
wooden back / side							■	
glass side / hinged door	profile						■	
	glass				■			
shelves / base / lid		■	■					
SHOWCASE								
structure / support							■	
CHARGING ACCESSORY								
structure							■	

colours

Matt lacquer

- BC chalk white
- PE pearl
- DN dune
- PL platinum
- NE black
- AT anthracite
- SE mustard
- SI silica
- DO dolomite grey
- AL clay
- MK moka
- CM caramel
- CZ light blue grey
- SA sand
- RU ruby
- RE rust
- PX pewter colour
- RX copper
- TO dove grey

Glossy lacquer

- BC chalk white
- PE pearl
- DN dune
- PL platinum
- NE black
- AT anthracite
- SE mustard
- SI silica
- DO dolomite grey
- AL clay
- MK moka
- CM caramel
- CZ light blue grey
- SA sand
- RU ruby
- RE rust
- PX pewter colour
- RX copper
- TO dove grey

Woods

- EU eucalyptus
- NO walnut
- RF graphite oak

DATASHEET

REGISTERED
DESIGN

IX.2018

TECHNICAL INFORMATION

WALL PANELLING

Wood particle board panelling covered with sliced veneer in Oak (Quercus), Eucalyptus (Eucalyptus globulus), Walnut (Juglans Nigra) or melamine finish, painted in the colors from the “Molteni Range”.
Wall mounting profile in extruded anodized aluminum.

GUIDE FOR ANCHORING SHELVES AND CENTRAL PROFILE

Extruded anodized aluminum.

SUPPORT SHELF

Wood particle board panel covered with sliced veneer in Oak, Eucalyptus, Walnut or melamine finish, painted in the colors from the “Molteni Range”.
Fastening elements in laser-cut and painted sheet metal.
Undertop track (optional) in extruded anodized aluminum.

TRAY

Wood particle board panel covered with sliced veneer in Oak, Eucalyptus, Walnut or melamine finish, painted in the colors from the “Molteni Range”.

HANGING OR FREE STANDING CONTAINERS

Wood particle board panel covered with sliced veneer in Oak, Eucalyptus, Walnut or melamine finish, painted in the colors from the “Molteni Range”.
Fastening elements for suspended containers in laser cut and painted sheet metal.
The floor storage units are equipped with adjustable support feet.

SIDES AND DRAWER BOTTOMS

Wood particle board paneling covered with melamine finish.

BOOKCASE

Wood particle board panel covered with sliced veneer in Oak, Eucalyptus, Walnut or melamine finish, painted in the colors from the “Molteni Range”.
Fastening elements in painted metal.

BOOKSHELVES PARTITION

Bent sheet metal covered with bonded hide leather.

SHOWCASE

Wood particle board paneling covered with melamine finish, painted in the colors from the “Molteni Range” or with applied silver bronze glass, thickness 4 mm. Perimeter profile in painted aluminum.

GLASS CABINET - WOODEN PARTS

Wood particle board panel covered with sliced veneer in Oak, Eucalyptus, Walnut or melamine finish, painted in the colors from the “Molteni Range”.
Fastening elements in painted metal.

GLASS CABINET - PARTS IN GLASS AND SHELVES

Extruded or painted aluminum. Tempered crystal, thickness 4 mm.
Shelves in painted bent sheet metal.

LIGHTING AND ELECTRICAL COMPONENTS

All components are compliant with regulations and certified as shown on the individual parts.

TECHNICAL INFORMATION

Molteni & C

4—
19

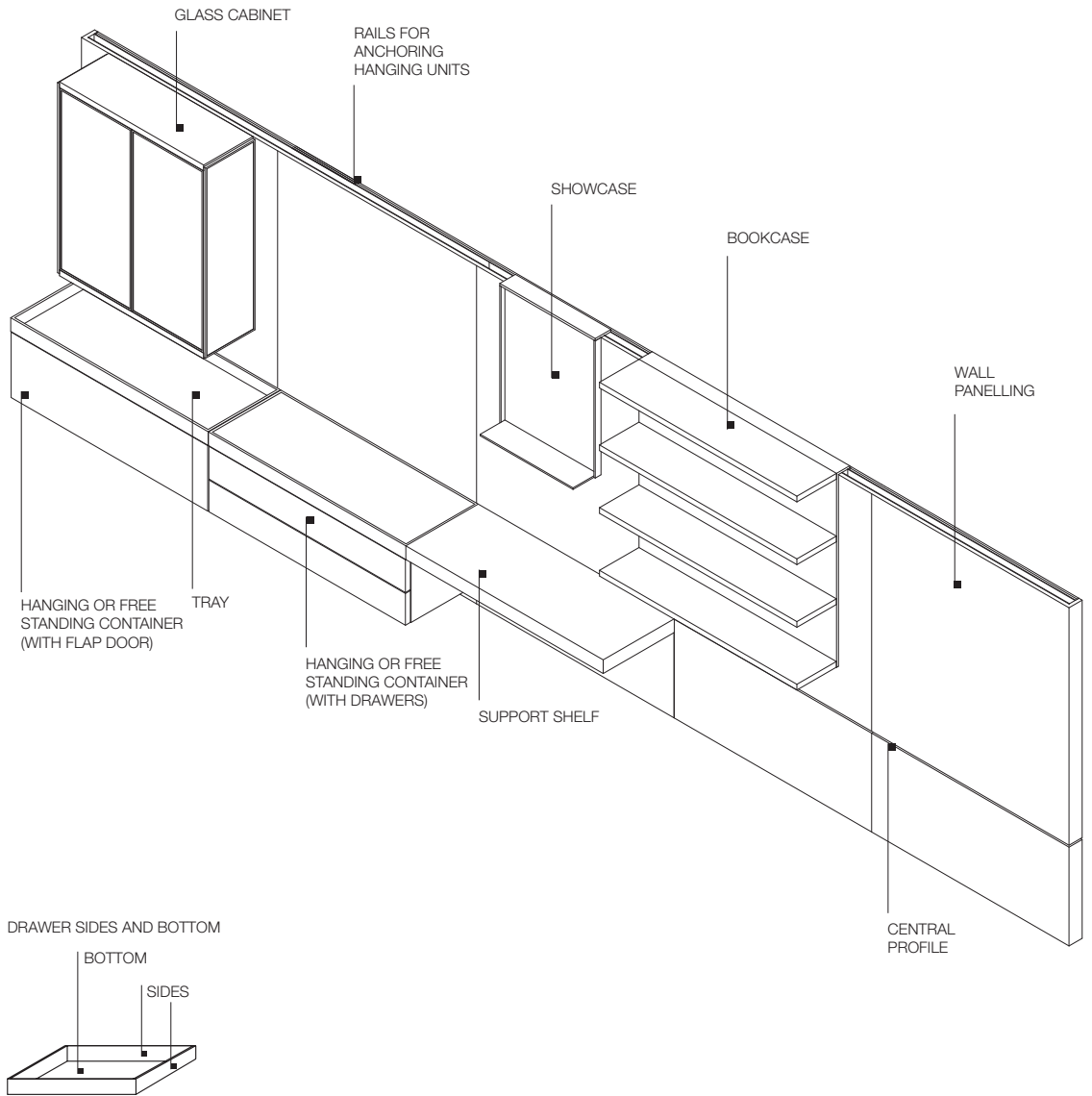

DATASHEET

REGISTERED
DESIGN

IX.2018

NOTES

- Corner compositions may be created by putting two straight compositions together.
- The support shelf may be made of a single piece up to 3000 mm.
- Hanging or standing containers must be positioned under the support shelf or must be equipped with a top tray.
- The composition may be lit in the central part, in the upper part, or both.
- The glass cabinet and the bookcase can be equipped with a lighting system that is independent from the one in the panelling.

Example of a composition

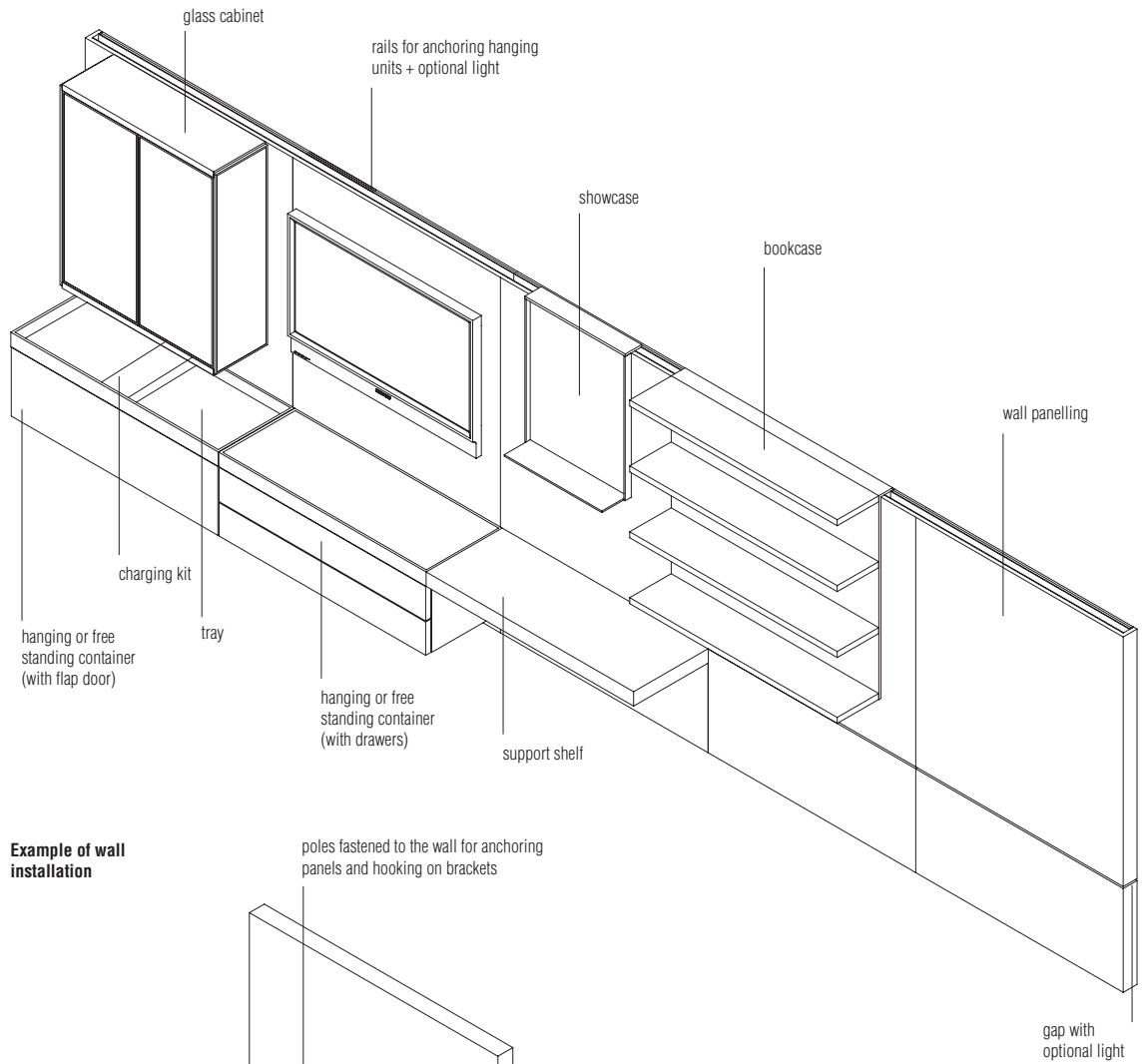

Example of wall installation

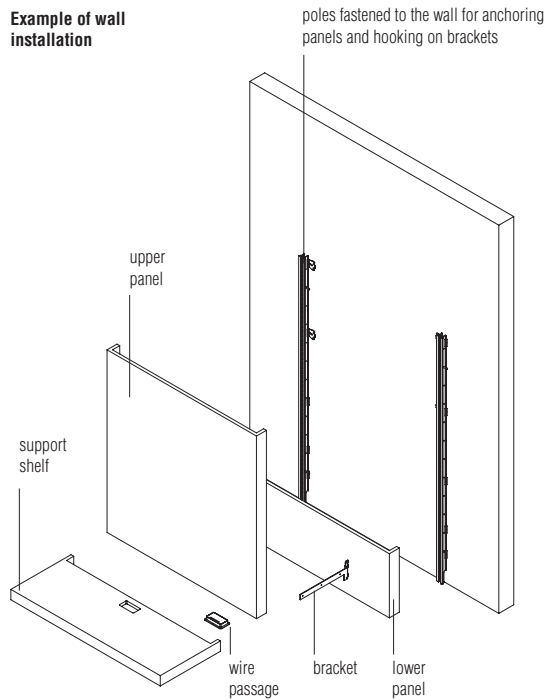

DATASHEET

REGISTERED
DESIGN

IX.2018

MODULARITY

**Modularity of individual
panelling**

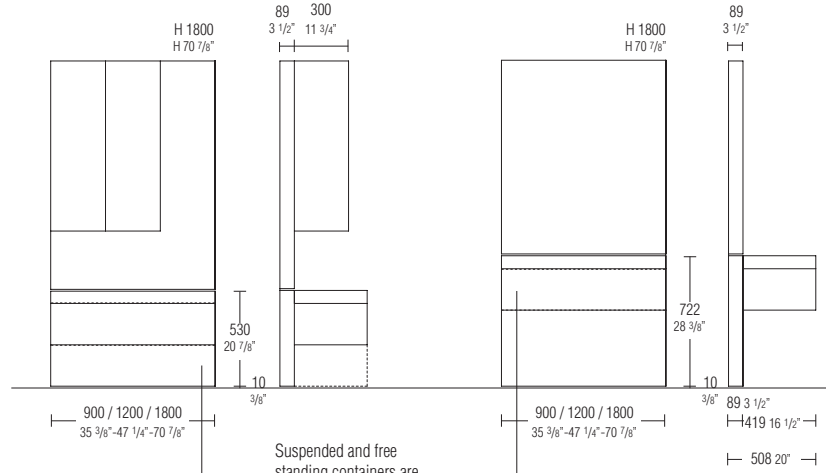

**Modularity of modular
panelling**

Suspended and free standing containers are always of the same width as the panelling since they hook onto the upright sections

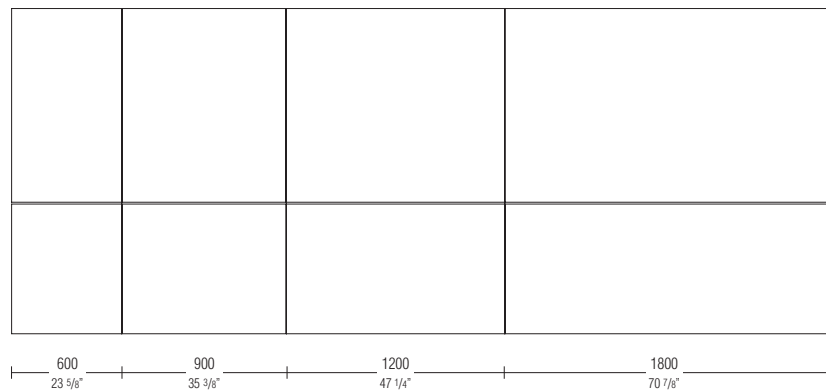
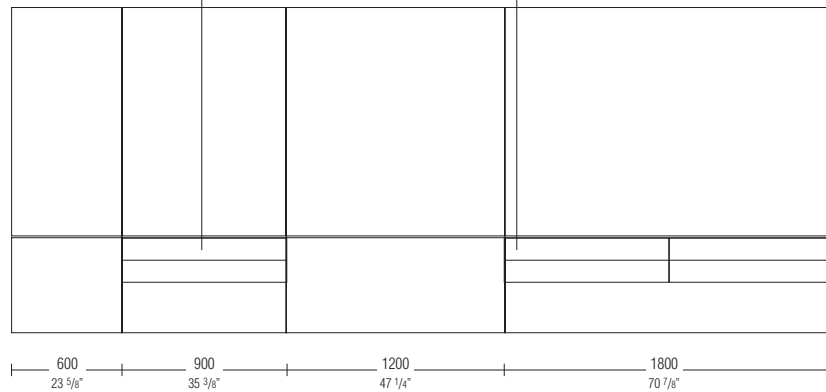

Molteni & C

6—
19

DATASHEET

REGISTERED
DESIGN

IX.2018

EXAMPLE OF WIRE PASSAGE

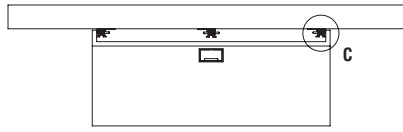

det. C

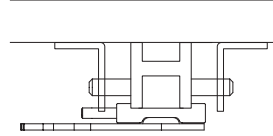

Molteni & C

7—
19

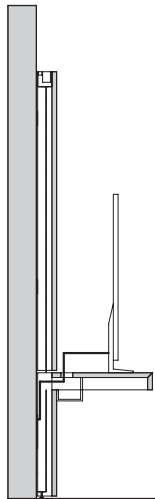
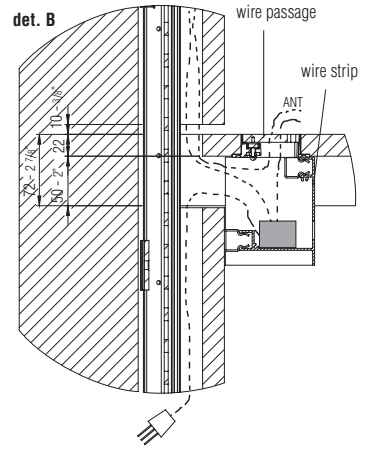
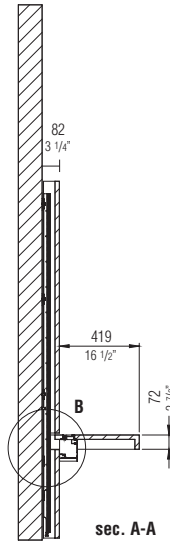
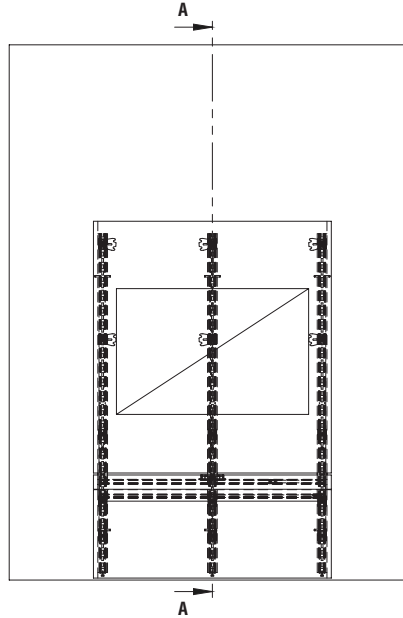

Solution 1
TV standing on support shelf

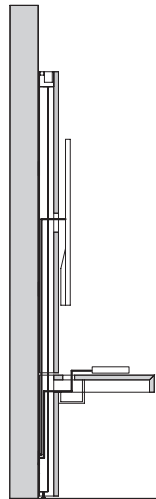

Solution 2
TV hanging from panelling
and decoder standing on
support shelf

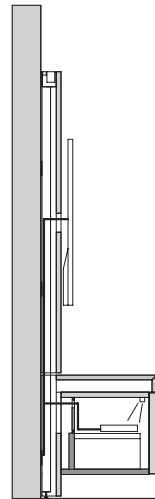

Solution 3
TV hanging from panelling
and decoder housed inside
the container with flap door -
signal transmitted by IR

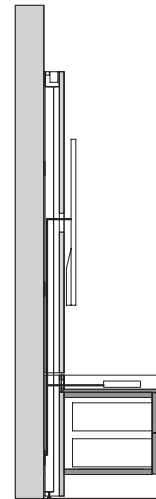

Solution 4
TV hanging from panelling,
decoder, console or PC
standing inside the tray

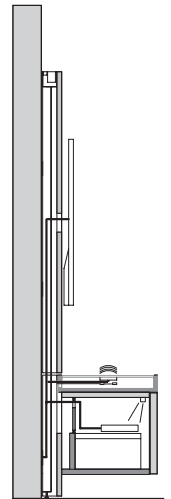

Solution 5
TV hanging from panelling
and decoder housed inside
the container with flap door -
signal transmitted by IR and
tray with induction and USB
charging box

DATASHEET

REGISTERED
DESIGN

IX.2018

DIMENSIONS

Individual panelling D 82 (89 from the wall)
H1 from the ground 540 / 732
Total H from the ground 1800

The panels can be reduced in width considering a surcharge (per module).

All panelling is equipped to receive hanging elements in the upper part

panelling

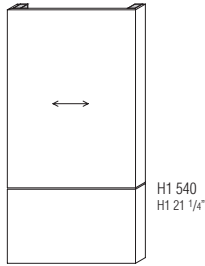

W 900 W 1200 W 1800
PIC09/18A PIC12/18A PIC18/18A

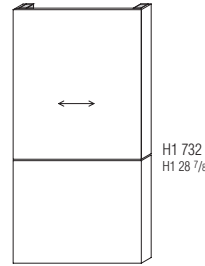

W 900 W 1200 W 1800
PIS09/18A PIS12/18A PIS18/18A

panelling for support shelf

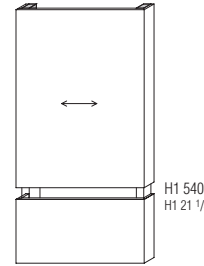

W 900 W 1200 W 1800
PIC09/18B PIC12/18B PIC18/18B

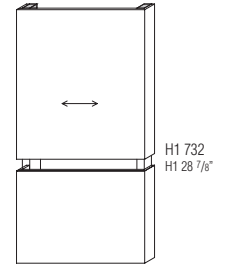

W 900 W 1200 W 1800
PIS09/18B PIS12/18B PIS18/18B

Molteni & C

8—
19

All panelling is equipped to receive hanging elements in the upper part

panelling for hanging container and free-standing container with tray or support shelf

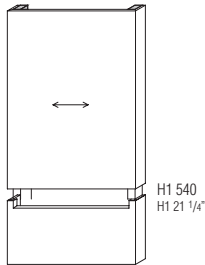

W 900 W 1200 W 1800
PIC09/18C PIC12/18C PIC18/18C

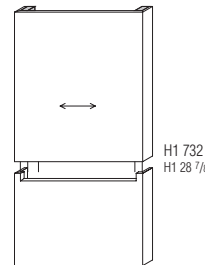

W 900 W 1200 W 1800
PIS09/18C PIS12/18C PIS18/18C

work for TV cable passage (to be requested on the order form)

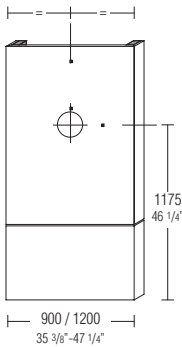

900 / 1200
 35 3/8" - 47 1/4"

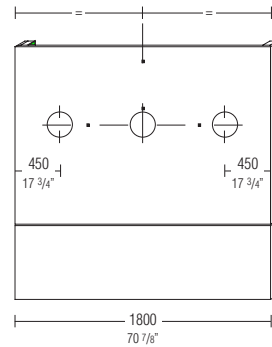

1800
 70 7/8"

DATASHEET

REGISTERED
DESIGN

IX.2018

DIMENSIONS

Modular panelling D 82 (89 from the wall)
H1 from the ground 540
Total H from the ground 1800

The panels can be reduced in width considering a surcharge (per module) .

All panelling is equipped to receive hanging elements in the upper part

left-sx panelling

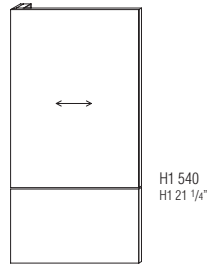

W 600 W 900 W 1200 W 1800
PSC06/18A PSC09/18A PSC12/18A PSC18/18A

left-sx panelling for support shelf

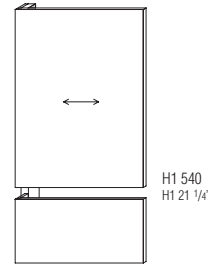

W 600 W 900 W 1200 W 1800
PSC06/18B PSC09/18B PSC12/18B PSC18/18B

left-sx panelling for hanging container and free-standing container with tray or support shelf

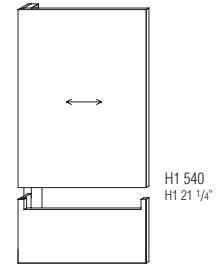

W 600 W 900 W 1200 W 1800
PSC06/18C PSC09/18C PSC12/18C PSC18/18C

All panelling is equipped to receive hanging elements in the upper part

central panelling

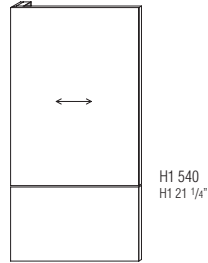

W 600 W 900 W 1200 W 1800
PCC06/18A PCC09/18A PCC12/18A PCC18/18A

central panelling for support shelf

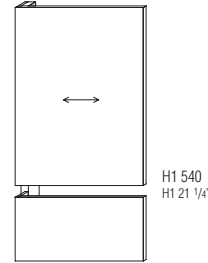

W 600 W 900 W 1200 W 1800
PCC06/18B PCC09/18B PCC12/18B PCC18/18B

central panelling for hanging container and free-standing container with tray or support shelf

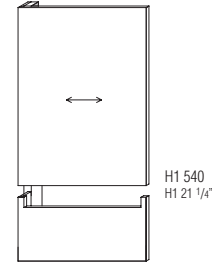

W 600 W 900 W 1200 W 1800
PCC06/18C PCC09/18C PCC12/18C PCC18/18C

All panelling is equipped to receive hanging elements in the upper part

right-dx end panelling

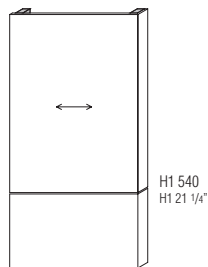

W 600 W 900 W 1200 W 1800
PDC06/18A PDC09/18A PDC12/18A PDC18/18A

right-dx end panelling for support shelf

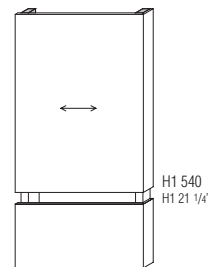

W 600 W 900 W 1200 W 1800
PDC06/18B PDC09/18B PDC12/18B PDC18/18B

right-dx end panelling for hanging container and free-standing container with tray or support shelf

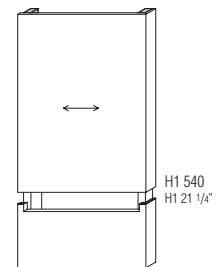

W 600 W 900 W 1200 W 1800
PDC06/18C PDC09/18C PDC12/18C PDC18/18C

Molteni & C

DIMENSIONS

Modular panelling D 82 (89 from the wall)
H1 from the ground 732
Total H from the ground 1800

The panels can be reduced in width considering a surcharge (per module).

All panelling is equipped to receive hanging elements in the upper part

left-sx panelling

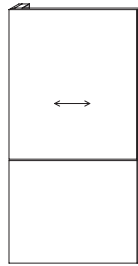

H1 732
H1 28 7/8"

W 600 W 900 W 1200 W 1800
PSS06/18A PSS09/18A PSS12/18A PSS18/18A

left-sx panelling for support shelf

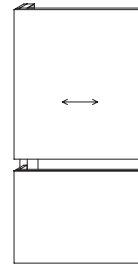

H1 732
H1 28 7/8"

W 600 W 900 W 1200 W 1800
PSS06/18B PSS09/18B PSS12/18B PSS18/18B

left-sx panelling for hanging container with tray or support shelf

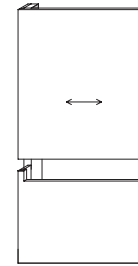

H1 732
H1 28 7/8"

W 600 W 900 W 1200 W 1800
PSS06/18C PSS09/18C PSS12/18C PSS18/18C

All panelling is equipped to receive hanging elements in the upper part

central panelling

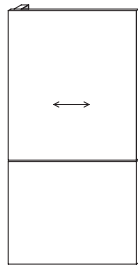

H1 732
H1 28 7/8"

W 600 W 900 W 1200 W 1800
PCS06/18A PCS09/18A PCS12/18A PCS18/18A

central panelling for support shelf

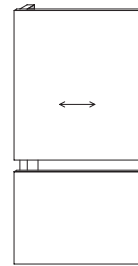

H1 732
H1 28 7/8"

W 600 W 900 W 1200 W 1800
PCS06/18B PCS09/18B PCS12/18B PCS18/18B

central panelling for hanging container with tray or support shelf

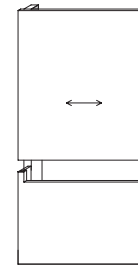

H1 732
H1 28 7/8"

W 600 W 900 W 1200 W 1800
PCS06/18C PCS09/18C PCS12/18C PCS18/18C

All panelling is equipped to receive hanging elements in the upper part

right-dx end panelling

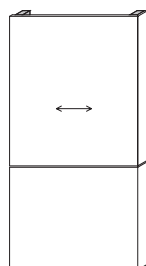

H1 732
H1 28 7/8"

W 600 W 900 W 1200 W 1800
PDS06/18A PDS09/18A PDS12/18A PDS18/18A

right-dx end panelling for support shelf

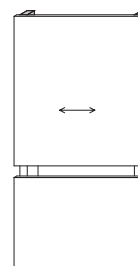

H1 732
H1 28 7/8"

W 600 W 900 W 1200 W 1800
PDS06/18B PDS09/18B PDS12/18B PDS18/18B

right-dx end panelling for hanging container with tray or support shelf

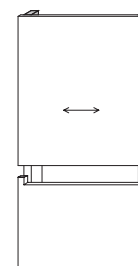

H1 732
H1 28 7/8"

W 600 W 900 W 1200 W 1800
PDS06/18C PDS09/18C PDS12/18C PDS18/18C

Molteni & C

10—
19

DATASHEET

REGISTERED
DESIGN

IX.2018

moltenigroup.com

Dimensions in millimeters and inches. The right to discontinue and make changes is reserved. This information is based on the latest product information available at the time of printing.

DIMENSIONS

Wall panelling lighting

It is possible to light the panelling by inserting LED bars, along the entire length of the composition, in the top part, in the central part, or both.
It is possible to connect the system to a socket with switch, or to use a radio control kit (optional).

**LED bars 12W per metre
max length 3000 mm**
for calculations, consider the sum
of all modules



per linear meter
EBIML

**power supply
unit 100W**

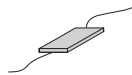

EAL1

**connector
for power supply
units**



ECO1

**radio control kit
with brightness
setting
(1 per power supply
unit)
optional**



EKRR1

**DALI kit
(for DOMOTICA)**
n. 1 for each
power supply unit
cannot be used with
radio remote control

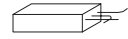

EKDA1

Example of lit wall

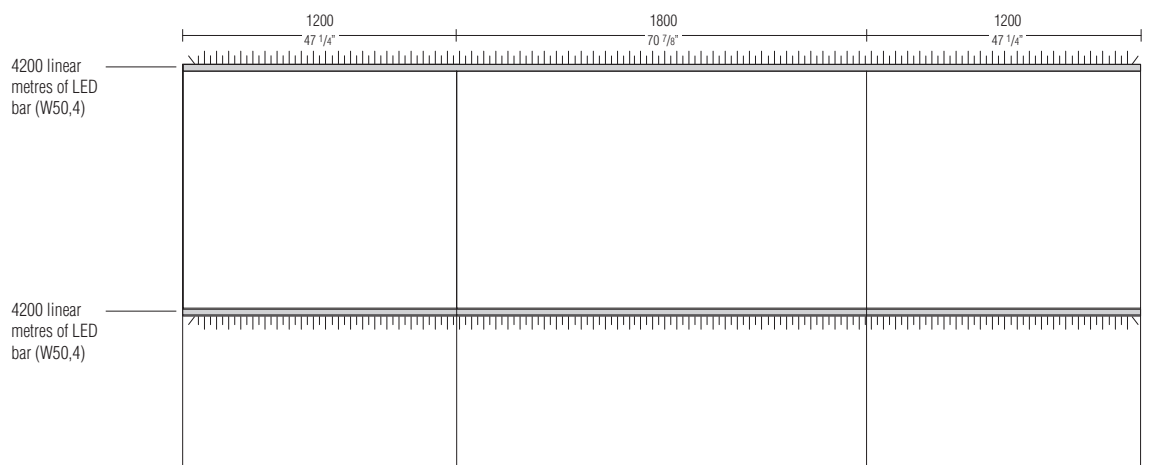

n° 2 power supply units **EAL1**
n° 1 connector **ECO1**
n° 2 radio control kit **EKRR1**

DATASHEET

REGISTERED
DESIGN

IX.2018

DIMENSIONS

Support shelf D 419 H 72

Supporting shelves can be reduced in width considering a surcharge.

The support shelf is always equipped with the side brackets, while the central brackets must be added according to the modularity of the composition.

Molteni & C

12—
19

support shelf

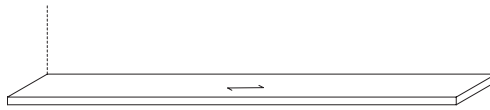

W 600 W 900 W 1200 W 1500 W 1800 W 2100 W 2400 W 2700 W 3000
MAP4/06 **MAP4/09** **MAP4/12** **MAP4/15** **MAP4/18** **MAP4/21** **MAP4/24** **MAP4/27** **MAP4/30**

detachable track underneath the support shelf

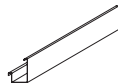

W 900 W 1200 W 1800
MCS09 **MCS12** **MCS18**

central bracket for support shelf



ST4

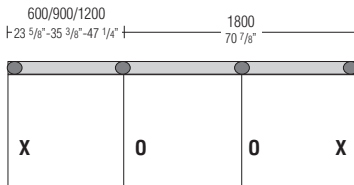

X = included in the price

O = to be added

wire passage for support shelf W 112 D 57



EPA3

Positioning wire passage on the support shelf

The cable gland on the supporting shelf can be positioned in relation to the modules as shown in the specified drawings

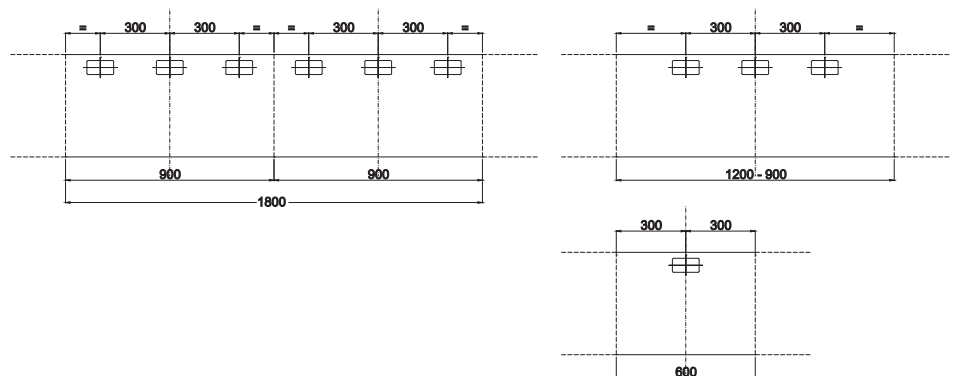

DATASHEET

REGISTERED
DESIGN

IX.2018

DIMENSIONS

Tray
D 419 H 72

Reductions
No reductions possible

Always to be used resting
on suspended or
free-standing containers

tray
W 600

W 900

W 1200

Molteni & C

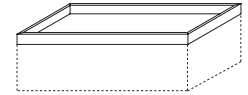
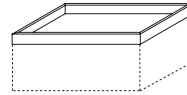
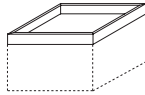

VA4/06

VA4/09

VA4/12

13—
19

finishes:
ivory
dark brown
grey
mink

bottoms in Eco Skin
for trays W 600

for trays W 900

for trays W 1200



VE4/06

VE4/09

VE4/12

Including the cost
of adding the wire passage
to the tray

charging module
W 150 D 407 H 56
a) Qi inside wireless recharge
b) 2 USB recharge plugs

wire passage
on the tray
W 112 D 57

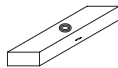

EMR1



EPA5

**tray wire passage position and
charge module position**

W 600

W 900

W 1200

central

central

central

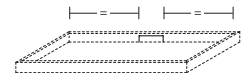
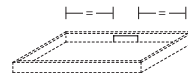
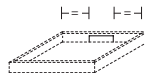

right/left

right/left

right/left

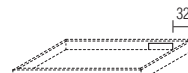
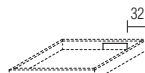

right version

right version

right version

DATASHEET

REGISTERED
DESIGN

IX.2018

DIMENSIONS

Hanging container D 419 H 347

Containers with flap door can be equipped with a wire passage, which must be indicated in the order phase.
The inside is clear of the "T" shelf (optional).

Reductions

No reductions possible

Molteni & C

Always to be used under the support shelf or with top tray

Including fastening brackets

W 600 with pressure-opening flap door

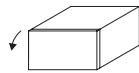

matt lacquer structure wood structure
CQSR06/34

W 900

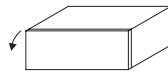

matt lacquer structure wood structure
CQSR09/34

W 1200



matt lacquer structure wood structure
CQSR12/34

W 1800 (W 900 + W 900)

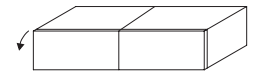

matt lacquer structure wood structure
CQSR18/34

Always to be used under the support shelf or with top tray

Including fastening brackets

W 600 with drawers

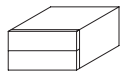

matt lacquer structure wood structure
CQSC06/34

W 900

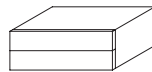

matt lacquer structure wood structure
CQSC09/34

W 1200

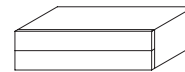

matt lacquer structure wood structure
CQSC12/34

W 1800 (W 900 + W 900)



matt lacquer structure wood structure
CQSC18/34

additional "T" shelf H 151 for flap door containers

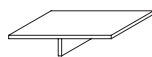

W 600 W 900 W 1200
RQT06 RQT09/15 RQT12/15

TV signal transmitting/receiving system with LED light for containers with flap door

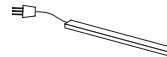

ETV1

DATASHEET

REGISTERED
DESIGN

IX.2018

DIMENSIONS

Free-standing container D 419 H 445

Always to be used under the support shelf or with top tray.
Containers with flap door can be equipped with a wire passage, which must be indicated in the order phase. The inside is clear of the "T" shelf (optional).

Reductions
No reductions possible

Molteni & C

Always to be used under the support shelf or with top tray

W 600 with pressure-opening flap door

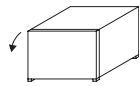

matt lacquer structure wood structure
CQTR06/44

W 900

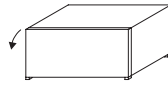

matt lacquer structure wood structure
CQTR09/44

W 1200

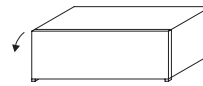

matt lacquer structure wood structure
CQTR12/44

W 1800 (W 900 + W 900)

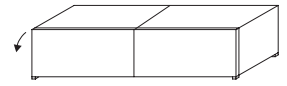

matt lacquer structure wood structure
CQTR18/44

15—
19

Always to be used under the support shelf or with top tray

W 600 with drawers

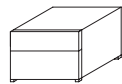

matt lacquer structure wood structure
CQTC06/44

W 900

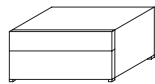

matt lacquer structure wood structure
CQTC09/44

W 1200



matt lacquer structure wood structure
CQTC12/44

W 1800 (W 900 + W 900)



matt lacquer structure wood structure
CQTC18/44

additional "T" shelf H 248 for flap door containers

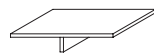

W 600 RQT06 W 900 RQT09/25 W 1200 RQT12/25

TV signal transmitting/receiving system with LED light for containers with flap door

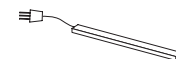

ETV1

DATASHEET

REGISTERED
DESIGN

IX.2018

DIMENSIONS

Bookcase D 252

- To create bookcases with LED lighting consider: LED increase, power supply unit and, if there is no pre-fitted element for the switched socket, also the remote control kit.

- The bookcase lighting system is separate from the one for the panelling, but it can be integrated with the one for the glass cabinets if they do not exceed 100W.
- The lighting system includes LEDs on all shelves in the bookcase, excepted the lower shelf.

Reductions

No reductions possible

Molteni & C

16—
19

H 690 3 shelves

W 450
10 watt



matt lacquer
back
LDS04/07

W 600
14 watt

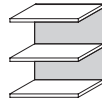

matt lacquer
back
LDS06/07

W 900
20 watt

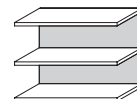

matt lacquer
back
LDS09/07

W 1200
28 watt

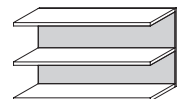

matt lacquer
back
LDS12/07

H 1020 4 shelves

W 450
15 watt

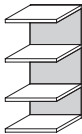

matt lacquer
back
LDS04/10

W 600
21 watt

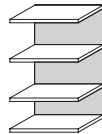

matt lacquer
back
LDS06/10

W 900
30 watt

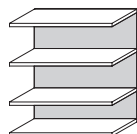

matt lacquer
back
LDS09/10

W 1200
42 watt

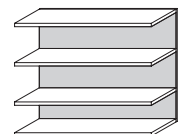

matt lacquer
back
LDS12/10

finishes:
ivory
dark brown
dove grey
black

Bookcase accessories

partition
W 300 H 298 D 238



DVL03

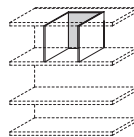

power supply
unit 100W

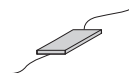

EAL1

radio control kit
with brightness setting
(1 per power supply unit)
optional



EKRR1

DATASHEET

REGISTERED
DESIGN

IX.2018

moltenigroup.com

Dimensions in millimeters and inches. The right to discontinue and make changes is reserved. This information is based on the latest product information available at the time of printing.

DIMENSIONS

Showcase
D 150

Reductions
No reductions possible

Max capacity of the shelf 5 kg
evenly distributed

H 580
W 580



EDS05/05

H 686
W 580

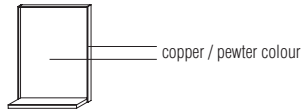

EDS05/06

Showcase
with mirror

H 1016
W 580

In the order, specify the finish
of the perimeter profile and
shelf (pewter colour / copper
lacquer)

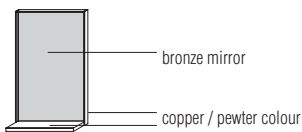

EDS05/10

Molteni & C

17—
19

DATASHEET

REGISTERED
DESIGN

IX.2018

moltenigroup.com

Dimensions in millimeters and inches. The right to discontinue and make changes is reserved. This information is based on the latest product information available at the time of printing.

DIMENSIONS

Glass cabinet D 300 Glass side

- Pewter colour / copper painted profile.
- Transparent stopsol glass.
- Optional interior lighting.
- To create glass cabinets with LED lighting consider: LED increase, power supply unit and, if there is no pre-fitted element for the switched socket, also the remote control kit.

- The glass cabinet lighting system is separate from the one for the panelling, but it can be integrated with the one for the bookcases if they do not exceed 100W.
- Provision is made to position the LED bar in the lid.

Reductions

No reductions possible

Molteni & C

18—
19

H 1020
W 600
7 watt
opening only right

inside layout

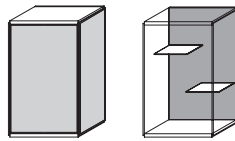

pewter colour / copper
lacquered back
VTSV06/10

W 900
10 watt

inside layout

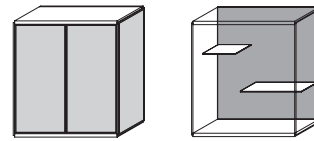

pewter colour / copper
lacquered back
VTSV09/10

**power supply
unit 100W**

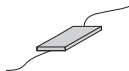

EAL1

**radio control kit
with brightness setting
(1 per power supply unit)
optional**



EKRR1

DATASHEET

REGISTERED
DESIGN

IX.2018

DIMENSIONS

Glass cabinet D 300 Pewter colour / copper matt lacquered side

- Door pewter colour / copper painted profile.
- Transparent stopsol glass.
- It is not possible to insert LED lighting.

Reductions

No reductions possible

with n° 2
internal shelves

H 1020
W 600
opening only right

W 900

Molteni & C

19—
19

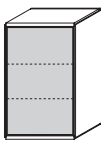

pewter colour / copper
lacquered back
VTSL06/10

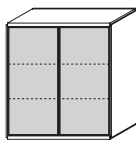

pewter colour / copper
lacquered back
VTSL09/10

DATASHEET

REGISTERED
DESIGN

IX.2018

Molteni & C

FINISHES MOLTENI&C RANGE

IX.2018

	MATT LACQUER	GLOSSY LACQUER	COLOURED GLASS	ETCHED COLOURED GLASS	CARTAPAGLIA LACQUERED only Gliss Master	STOPSOL GLASS TRANSPARENT STOPSOL GLASS
CHALK WHITE	•	•	•	•	•	
PEARL	•	•	•	•	•	
SILICA	•	•	•	•	•	
SAND	•	•	•	•	•	
DOVE GREY	•	•	•	•	•	
PLATINUM	•	•	•	•	•	
DUNE	•	•	•	•	•	
CLAY	•	•	•	•	•	
DOLOMITE GREY	•	•	•	•	•	
COPPER	•	•	•	•	•	
RUST	•	•	•	•	•	
RUBY	•	•	•	•	•	
CARAMEL	•	•	•	•	•	
MOKA	•	•	•	•	•	
MUSTARD	•	•	•	•	•	
LIGHT BLUE GREY	•	•	•	•	•	
PEWTER COLOUR	•	•	•	•	•	
ANTHRACITE	•	•	•	•	•	
BLACK	•	•	•	•	•	
STOPSOL						•
LESSLESS RED	•					
		only matt lacquer				

Molteni & C

FINISHES MOLTENI&C RANGE

IX.2018

WOODS

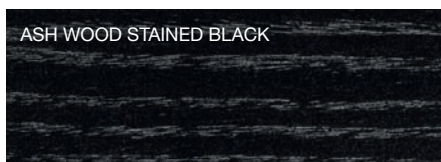
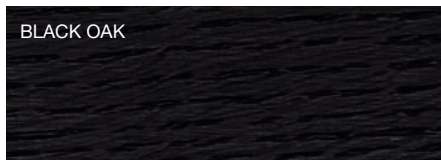
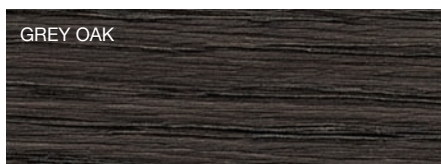
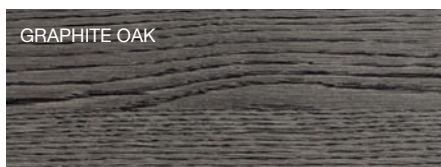
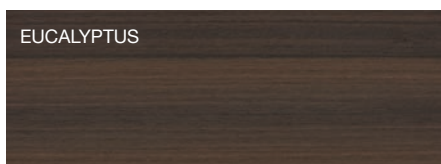

MARBLES

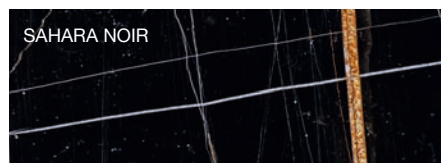
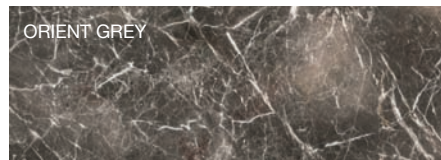
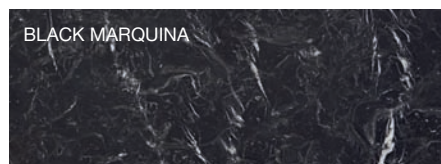
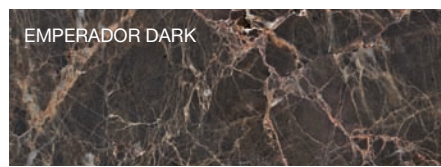
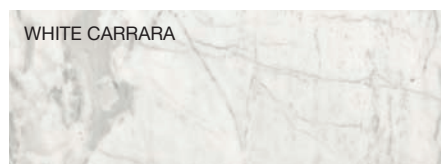

METAL PARTS

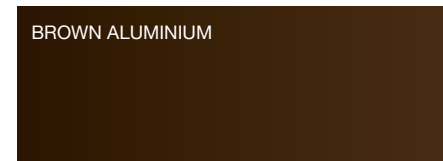
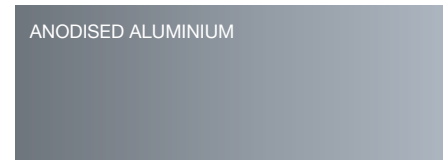
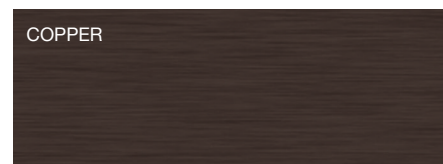
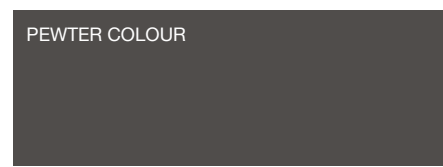
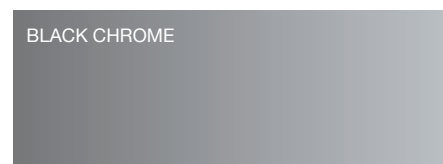

The finishes shown are indicative and refer to the entire production range. We recommend that you consult the "Colour Range" samples which shown the complete range of finishes, including those not shown here. Molteni&C reserves the right to modify the range without warning.

Molteni & C

FINISHES MOLTENI&C RANGE

IX.2018

MELAMINE FRONT
GLISS MASTER

CARTAPAGLIA WHITE



CARTAPAGLIA ANTHRACITE



CARTAPAGLIA SILICA



GRAFFIATO SILICA



GRAFFIATO BRONZE



SILK DOVE GREY



SILK SILICA



SILK CHALK WHITE



MELAMINE STRUCTURE
GLISS MASTER

WHITE SHANTUNG

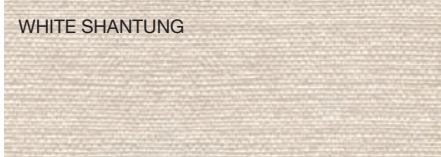

GREY SHANTUNG



MELAMINE STRUCTURE
GLISS MASTER, MASTER DRESSING,
GLISS WALK-IN

SILVER CEMBRAN



LARIX DARK

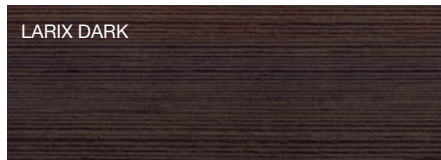

MELAMINE STRUCTURE
GLISS MASTER, MASTER DRESSING

WHITE



ECO SKIN

IVORY



HEMP



MINK



DARK BROWN

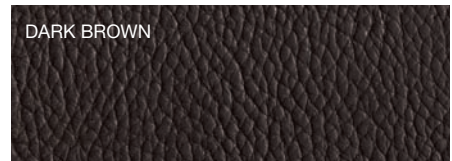

GREY



FINE GRAIN

FINE GRAIN

